

Additional Information

Specifications

Power Requirements	Refer to the main label on the unit.
Power Consumption	Refer to the main label on the unit.
Dimensions (W x H x D)	Approx. 300 mm x 163 mm x 241 mm
Bus Power Supply (USB)	5 V  500 mA
Amplifier (Total RMS output power)	300 W RMS

Design and specifications are subject to change without notice.

Replacement of battery

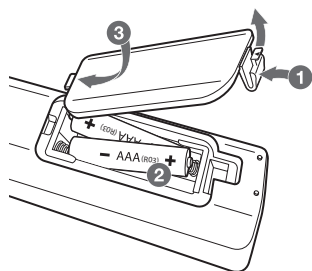

POWER: This unit operates on a mains supply of 110 - 240 V ~ 50 / 60 Hz.

Wiring: This unit is supplied with a BS 1363 approved main plug. When replacing the fuse, always use a fuse of the same rating and approved to BS 1362. Never use this plug with the fuse cover omitted. To obtain a replacement fuse cover contact your dealer. If the type of plug supplied is not suitable for the mains sockets in your home, then the plug should be removed and a suitable type fitted. Please refer to the wiring instructions below:

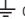
Warning: A mains plug removed from the mains lead of this unit must be destroyed. A mains plug with bared wires is hazardous if inserted in a mains socket. Do not connect either wire to the earth pin, marked with the letter E or with the earth symbol  or coloured green or green and yellow. If any other plug is fitted, use same rating of fuse in the plug.

Important: The wires in this mains lead are coloured in accordance with the following codes:

- **BLUE: NEUTRAL, BROWN: LIVE** - As the colours of the wires in the mains lead of this unit may not correspond with the coloured marking identifying the terminals in your plug, proceed as follows: The wire which is coloured blue must be connected to the terminal which is marked with the letter N or coloured black. The wire which is coloured brown must be connected to the terminal which is marked with the letter L or coloured red.



SIMPLE MANUAL

Mini Hi-Fi System

Please read this manual carefully before operating your set and retain it for future reference. To view the instructions of advanced features, visit <http://www.lg.com> and then download Owner's Manual. Some of the content in this manual may differ from your unit.

MODEL
CK43N



MFL72041311
2307_Rev01

www.lg.com
Copyright © 2024 LG Electronics Inc. All Rights Reserved.

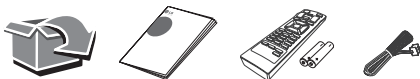

Front Panel

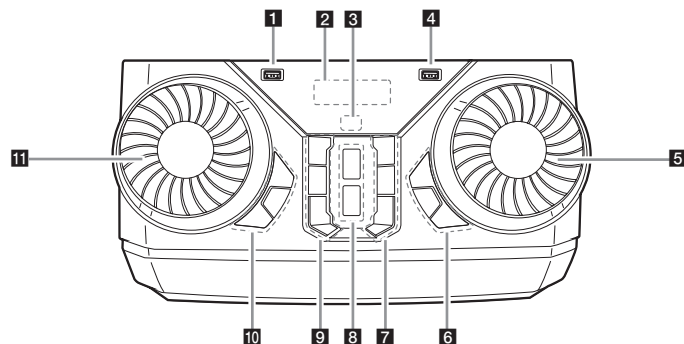

1 USB 1 Port
You can play sound files by connecting the USB device.

2 Display window

3 (Remote sensor)

4 USB 2 Port
You can play sound files by connecting the USB device.

5 **MASTER VOL.** (Volume)
Adjust speaker volume.

6 **BASS BLAST** (or **BASS BLAST+**)
Press to select BASS (or BASS+) effect directly.

USB REC / DEMO

- Records to USB.
- To stop Recording, press and hold for 3 seconds.
- In power off status, if you press **USB REC / DEMO**, show DEMO mode.

WIRELESS LINK

- Selects MAIN or OTHER on WIRELESS PARTY LINK mode.
- Enable or disable WIRELESS PARTY LINK mode.

7 (Function)
Selects the function and input source.

- ⏮** (Skip/Search)
 - Skips forward.
 - Searches for a section within a file.
 - Selects the radio stations.

(Information)

- Sees information about your music. An MP3 file often come with ID3 tag. The tag gives the Title, Artist, Album or Time information.
- Sees **Bluetooth** device name of the unit in BT READY.
- Sees the name of connected all **Bluetooth** device in **Bluetooth** mode.
- When these units are successfully connected each other in WIRELESS PARTY LINK mode, each of connected device names appears in the each unit.

8 **AUTO DJ**
Selects the AUTO DJ mode.

- ⏮** (Play/Pause)
 - Starts or pauses playback.
 - Selects stereo/mono.

9 (Standby)
Turns the power on or off.

- ⏮** (Skip/Search)
 - Skips backward.
 - Searches for a section within a file.
 - Selects the radio stations.

⏹ (Stop)
Stops playback or cancels DELETE function.

10 **SPECIAL EQ**
Chooses special equalizer.

SEARCH

Moves to folder or file in selection mode.

OK

Selects a folder when searching a file.

11 **EQUALIZER / SEARCH**
- Chooses sound impressions.
- Searches a folder or a file.

Rear Panel

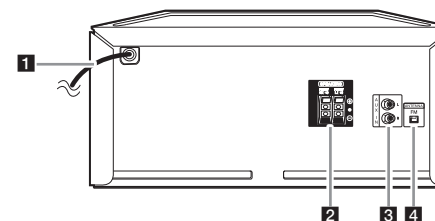

- 1** Power cord
- 2** **SPEAKERS** terminals
- 3** **AUX IN** (L/R)
Connect an auxiliary device.
- 4** **ANTENNA** (FM)

Speaker Connection

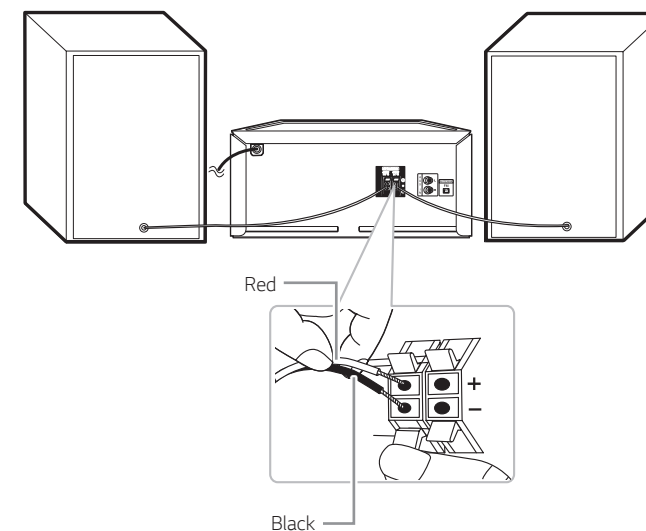

Controller App



Download the **LG XBOOM** App to your device.
(Android only)

LG Sound Sync (Wireless)



For more information, download the online owner's manual. <http://www.lg.com>