



INSTALLATION MANUAL

AIR CONDITIONER

Please read this installation manual completely before installing the product.

Installation work must be performed in accordance with the national wiring standards by authorized personnel only. Please retain this installation manual for future reference after reading it thoroughly.

Remote Temperature Sensor Original instructions

LG Electronics Inc.
EU Representative : LG Electronics European Shared Service Center B.V.
Krijgsman 1, 1186 DM Amstelveen, The Netherlands
Manufacturer: LG Electronics Inc. Changwon 2nd factory, 84, Wanam-ro,
Seongsan-gu, Changwon-si, Gyeongsangnam-do, KOREA



MFL67602810
Rev.00_021219

www.lg.com
Copyright © 2019 LG Electronics Inc. All Rights Reserved.

English	ITALIANO	ESPAÑOL	FRANÇAIS	DEUTSCH	ΕΛΛΗΝΙΚΑ	ČEŠTINA	NETERLANDS	POLSKI	LIMBA ROMÂNĂ
PORTUGUÊS	MAGYAR	БЪЛГАРСКИ	SRPSKI	HRVATSKI	GAELIGE	NORSK	SUOMI	DANSK	EESTI KEEL
MALTI	SLOVENČINA	SLOVENŠČINA	ЛАТВIEŠU VALODA	LETUVŲ KALBA	MAKEDONSKI	SHQIP	ISLENSKA	BOSANSKI	

IMPORTANT SAFETY INSTRUCTIONS

READ ALL INSTRUCTIONS BEFORE USING THE APPLIANCE.

Always comply with the following precautions to avoid dangerous situations and ensure peak performance of your product.

- The installation requires expert skills, and it should be installed by the service center or other shops specialized in the installation and recognized by our company.
- For all the problems arising after installation by someone who has no relevant qualifications, our company will not provide free service.
- The following safety cautions are provided to prevent unexpected dangers or losses.

WARNING

If the user does not follow the mandatory items, it may result in serious injury or death.

CAUTION

If the user does not follow the mandatory items, it may cause personal injury or property damage.

- ! Warning and Caution are to call the user's attention to the possible danger. Read the follow them carefully in order to prevent a safety accident.
- ⊘ Warning and Caution are indicated in this guide and the product itself to help protect the users from danger.

WARNING

Installation

- Be sure to request to the service center or installation specialty store when installing products.
 - It will cause fire or electric shock or explosion or injury.
- Request to the service center or installation specialty store when reinstalling the installed product. It will cause fire or electric shock or explosion or injury.
- Do not disassemble, fix, and modify products randomly. It will cause fire or electric shock.
- The appliance must only be supplied at safety extra low voltage corresponding to the marking on the appliance.

In-use

- Do not place flammable stuffs close to the product. It will cause fire.
- Do not allow water to run into the product. It will cause electric shock or breakdown.
- Do not give the shock to the product. It will cause breakdown when giving the shock to the product.
- Request to the service center or installation specialty store when the product becomes wet. It will cause fire or electric shock.

- Do not give the shock using sharp and pointed objects. It will cause breakdown by damaging parts.

CAUTION

In-use

- Do not clean using the powerful detergent like solvent but use soft cloths. It will cause fire or product deformation.
- Do not press the screen using powerful pressure or select two buttons. It will cause product breakdown or malfunction.
- Do not touch or pull the lead wire with wet hands. It will cause product breakdown or electric shock.
- Children should be supervised to ensure that they do not play with the appliance.
- This appliance is not intended for use by persons (including children) with reduced physical, sensory or mental capabilities, or lack of experience and knowledge, unless they have been given supervision or instruction concerning use of the appliance by a person responsible for their safety. Children should be supervised to ensure that they do not play with the appliance.

PART DESCRIPTION

Remote temperature sensor can be installed any place a user wants to detect the temperature.

NOTE

Remote temperature sensor only applied to Cassette and Duct Products.

Remote Sensor

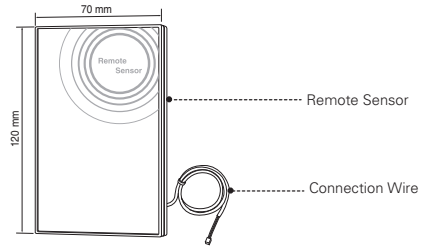

Parts

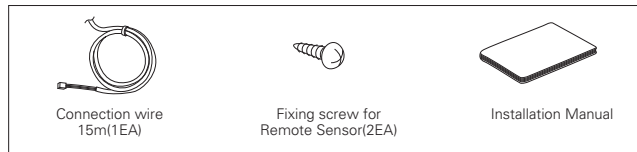

INSTALLATION METHOD

How to use

- After deciding where the remote temperature sensor is installed, decide the location and height of the fixing screws. (Interval between the screws : 60 mm)

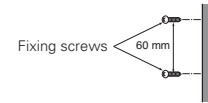

- After removing the panel of the indoor unit, remove the room temperature sensor in CN-ROOM of its main PCB.

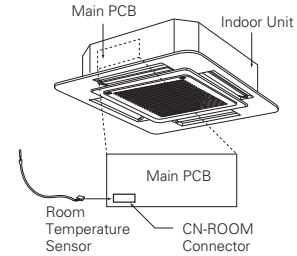

- Insert the connector of the connection wire into the space for the connector in place of the room temperature sensor.

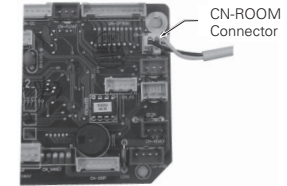

- In case that a wire remote control is installed, select the slide switch of the temperature detection on the back of the wire remote control to the Indoor Unit.

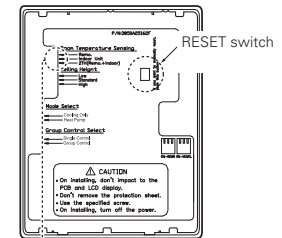

How to connect the remote temperature sensor and the connection wire

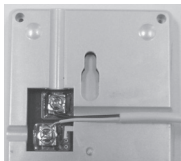

The Connection wire does not matter if you change the color of the wire because of non-polar.

How to install the remote temperature sensor on the wall

Integrate the remote temperature sensor with the screws as the order of arrows.

Fixing the Remote Sensor

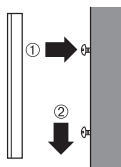

NOTE

1. Choose the place where the average temperature can be measured for the place the indoor unit operates.
2. Avoid direct sunlight
3. Choose the place where the cooling/heating devices do not affect the remote sensor.
4. Choose the place where the outlet of the cooling fan do not affect the remote sensor.
5. Choose the place where the remote sensor isn't affected when door is open.