

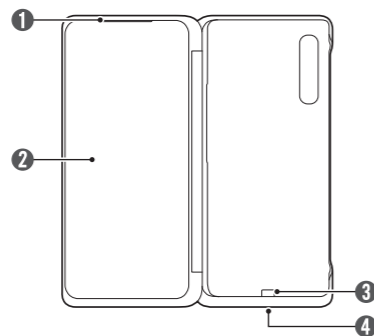

ENGLISH

Overview



- ❶ Hole for earpiece
- ❷ Product screen
- ❸ Communication/Power terminal
- ❹ Pogo Pin Port

• This manual is designed for users who connect a phone(LG VELVET) to this LG Dual Screen. For more information, please visit www.lg.com to view the user guide.

Plugging the phone into the Dual Screen

- Slide the bottom of your phone into the bottom of the Dual Screen as shown in the figure. At this time, make sure that the ❶ part of the phone fits the ❷ part of the Dual Screen correctly.

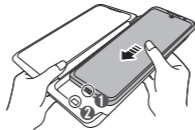

- Press the ❶ part of the phone with your finger to engage the edge of the phone with that of the Dual Screen.

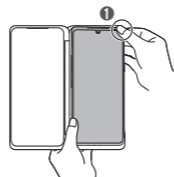

- Press the ❷ part of the phone to fully engage the Dual Screen with the phone.

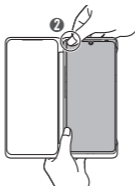

Removing the phone from the Dual Screen

- Press the ❶ part of the Dual Screen with your finger while simultaneously pushing the back of the phone with your other fingers to pull the edge of the phone out of the Dual Screen.

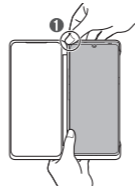

- Pull the ❷ part of the phone out of the Dual Screen following the same directions from the previous step.

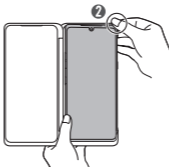

- Hold the Dual Screen with both hands and slide the phone in the direction of the arrow to remove it. Be careful not to twist the phone left or right or push it up at an excessive angle.

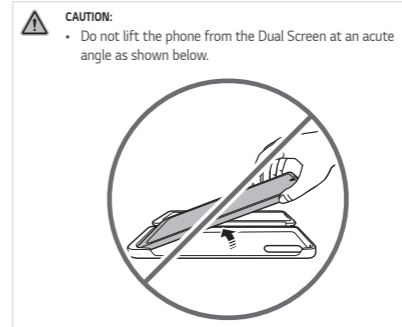
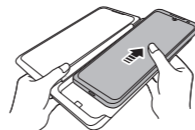

- If you pull the phone from the Dual Screen at an excessive angle or with excessive force when removing the phone, you may damage the Communication/Power terminal on the bottom of the Dual Screen or the USB data communication and charger port on the phone. Be sure to push up the phone in the direction of the arrow as shown in the figure when removing it.
- Be careful not to drop the Dual Screen or the phone while inserting or removing the phone.
- Make sure that your phone is fully inserted into the Dual Screen before use.

Using the Charging Adapter

You can use the charging adapter to charge your phone or move data while your phone is inserted into the Dual Screen.

- With the phone mounted on the Dual Screen, connect the charging adapter to the charging port at the bottom of the Dual Screen as shown in the figure below.

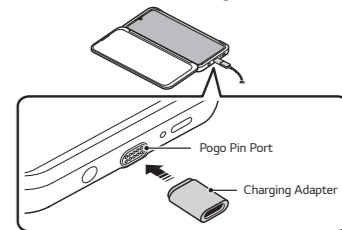

- Connect a USB Type-C cable.



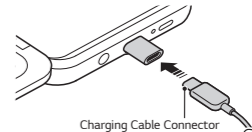

- You can charge the phone or move data.



- When the charging adapter is not in use, disconnect power of the charger and keep it separately from the charger cable connector. If the magnet part of the charging adapter gets in contact with nearby metals or conductive substances, it may be broken, burned, or damaged from electric shock.
- Make sure that you always use the charging adapter provided with the Dual Screen. If you lose the charging adapter or want to purchase a new one, call the LG Electronics Customer Service Centre for details.
- The charging adapter and the charging port at the bottom of the Dual Screen are connected magnetically. Do not shake or pull out the charging adapter while using it.



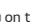

Turning on the Dual Screen

- 1 When the phone is plugged into the Dual Screen while the phone is on, the  appears on the phone screen.
- 2 Tap  >  on the phone screen to turn on the Dual Screen.
 - or -Pull down your phone's status bar and tap  to turn on the Dual Screen.

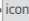
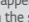

- If the Dual Screen Tool  icon does not appear on the phone screen or  does not appear in the status bar, remove the phone from the Dual Screen and insert it again.

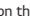
Turning off the Dual Screen

- Tap  >  on the Dual Screen.
 - or -Pull down your phone's status bar and tap .

Adjusting the Screen Colour

When using the Dual Screen and the phone screen at the same time, colour difference may occur between the two screens.

- Tap **Settings > Display > Screen colour**.
- Colours may look different depending on the viewing angle, so adjust the colours in a fully unfolded state.

Using the Dual Screen

- You can use the Dual Screen by connecting it to the phone. The Dual Screen does not work independently. This Dual Screen is only compatible with the phone.
- In the following cases, the Dual Screen may not fold completely or the Dual Screen may malfunction due to poor contact of the communication and power port.
 - When a protective film or glass is attached to the screen of the product or phone.
 - When a protective film or thick sticker is attached to the engagement surface of the Dual Screen or the back of the phone.
 - When a card or paper is inserted between the Dual Screen and the phone.
- Do not use the Dual Screen or charge the phone with moisture or foreign substance present in the communication and power port of the Dual Screen.
- The wireless charging function or NFC function may not work properly when the phone is inserted in the Dual Screen.
- Do not drop the Dual Screen or apply excessive force, for example, by pressing or bending the Dual Screen. Doing so may damage the Dual Screen.
- This Dual Screen contains magnetic components. Do not place it near a magnetic card or magnet.
- If the Dual Screen is mounted with a phone, it uses the phone's battery.

Guidelines for safe and efficient use

Please read these simple guidelines. Not following these guidelines may be dangerous or illegal.

Important information about the device

- The device apps, services, illustrations and content may differ depending on the area, service provider, software version and device, and are subject to change without notice.

Product care and maintenance

- Use only in-box accessories which are authorised by LG. LG does not guarantee any damage or failure which is caused by third party accessories.
- Do not disassemble this unit. Take it to a qualified service technician when repair work is required.
- Repairs under warranty, at LG's discretion, may include replacement parts or boards that are either new or reconditioned, provided that they have functionality equal to that of the parts being replaced.
- Keep away from electrical appliances such as TVs, radios and personal computers.
- The unit should be kept away from heat sources such as radiators or cookers.
- Do not drop the device or cause impacts to the device.
- Do not subject this unit to mechanical vibration or shock.
- Switch off the device in any area where you are required to by special regulations. For example, do not use your device in hospitals as it may affect sensitive medical equipment.
- Do not handle the device with wet hands while it is being charged. It may cause an electric shock and can seriously damage your device.
- Use a dry cloth to clean the exterior of the unit (do not use solvents such as benzene, thinner or alcohol).
- Do not subject this unit to excessive smoke or dust.
- Do not keep the device next to credit cards or transport tickets. It can affect the information on the magnetic strips.
- Do not tap the screen with a sharp object as it may damage the device.
- Do not expose the device to liquid or moisture.
- Do not use, touch or attempt to remove or fix broken, chipped or cracked glass. Damage to the glass display due to abuse or misuse is not covered under the warranty.
- Your device is an electronic device that generates heat during normal operation. Extremely prolonged, direct skin contact in the absence of adequate ventilation may result in discomfort or minor burns. Therefore, use care when handling your device during or immediately after operation.
- If your device gets wet, immediately unplug it to dry off completely. Do not attempt to accelerate the drying process with an external heating source, such as an oven, microwave or hair dryer.
- A product requires proper air circulation in order to dissipate heat. Direct skin contact and inadequate circulation of air flow to the device may cause the device to overheat. The device must be at least 1.0 cm from between the user's body.
- Please ensure that the product does not get in contact with liquid. Do not use or recharge the product if it is wet. Once the product becomes wet, the liquid damage indicator changes color. Please note that this will limit you from receiving any free-of-charge repair services provided under warranty.

Efficient device operation

- Do not use your device near medical equipment without requesting permission. Please consult your doctor to determine if operation of your device may interfere with the operation of your medical device.
- Pacemaker manufacturers recommend that you leave at least 15 cm of space between other devices and a pacemaker to avoid potential interference with the pacemaker.
- This device may produce a bright or flashing light.
- Some hearing aids might be disturbed by devices.
- Use your device in temperatures between 0 °C and 35 °C, if possible. Exposing your device to extremely low or high temperatures may result in damage, malfunction, or even explosion.

Road safety

Check the laws and regulations on the use of devices in the area when you drive.

- Do not use a hand-held device while driving.
- Give full attention to driving.
- Pull off the road and park before using it.
- RF energy may affect some electronic systems in your vehicle such as car stereos and safety equipment.
- When your vehicle is equipped with an air bag, do not obstruct with installed or portable wireless equipment. It can cause the air bag to fail or cause serious injury due to improper performance.
- If you are listening to music whilst out and about, please ensure that the volume is at a reasonable level so that you are aware of your surroundings. This is of particular importance when near roads.

Glass Parts

Some parts of your device are made of glass. This glass could break if your device is dropped on a hard surface or receives a substantial impact. If the glass breaks, do not touch or attempt to remove it. Stop using your device until the glass is replaced by an authorised service provider.

Blasting area

Do not use the device where blasting is in progress. Observe restrictions and follow any regulations or rules.

Potentially explosive atmospheres

- Do not use your device at a refueling point.
- Do not use near fuel or chemicals.
- Do not transport or store flammable gas, liquid or explosives in the same compartment of your vehicle as your device or accessories.

Children

Keep the device in a safe place out of the reach of small children. It includes small parts which may cause a choking hazard if detached.

Trademarks

- Copyright ©2020 LG Electronics Inc. All rights reserved. LG and the LG logo are registered trademarks of LG Group and its related entities.
- Google is a trademark of Google LLC.

DECLARATION OF CONFORMITY

Hereby, **LG Electronics** declares that this **LM-G905N** product is in compliance with the essential requirements and other relevant provisions of Directive **2014/35/EU** and **2014/30/EU**.

A copy of the Declaration of Conformity can be found at <http://www.lg.com/global/declaration>



Disposal of your old appliance (as per e-waste Rules)

- 1 When this crossed out wheeled bin symbol is depicted on the product and its operator's manual, it means the product is covered by the e-waste Management and Handling Rules, 2011 and are meant to be recycled, dismantled, refurbished or disposed off.

2 Dos

- a. The product is required to be handed over only to the authorised recycler for disposal.
 - b. Keep the product in isolated area, after it becomes nonfunctional/unrepairable so as to prevent its accidental breakage.
 - c. The product is not meant for mixing into household waste stream.
 - d. Do not keep any replaced spare part(s) from the product in exposed area.
- Don't
- a. The product should not be opened by the user himself/herself, but only by authorised service personnel.
 - b. The product is not meant for re-sale to any unauthorised agencies/scrap dealer/kabarivalah.
 - c. The product is not meant for mixing into household waste stream.
 - d. Do not keep any replaced spare part(s) from the product in exposed area.

- 3 Any disposal through unauthorised agencies/person will attract action under Environment (Protection) Act 1986.



- 4 This product is complied with the requirement of Hazardous Substances as specified under Rule 13 (1) & (2) of the E-Waste (Management & Handling) Rules, 2011.

- 5 To locate a nearest collection centre or call for pick-up (limited area only) for disposal of this appliance, please contact Toll Free No. 1800-315-9999 / 1800-180-9999 for details. All collection centre and pick up facilities are done by third parties with LG Electronics India Pvt. Ltd. Merely as a facilitator. For more detailed information, please visit: <http://www.lge.com/in>.

Customer Care

For any query related to after sales service, you may please contact us on the numbers listed below.

24 x 7 CUSTOMER CARE

	1800-315-9999 1800-180-9999 (Toll Free)		5757554 (Send SMS)
 www.lg.com/in/support			

 www.facebook.com/lginindiapage
 www.twitter.com/LGIndiaTweets

 LG WhatsApp No.
9711709999

 LG Service India Mobile App
Available at  Google Play

LG Electronics India Pvt. Ltd.

Regd. Office : A-24/6, Mohan Cooperative Industrial Estate,
Mathura Road, New Delhi-110044

Limited Warranty

SUBJECT TO THE CONDITIONS OF THIS LIMITED WARRANTY, LG ELECTRONICS WARRANTS THIS PRODUCT TO BE FREE FROM DEFECTS IN DESIGN, MATERIAL AND WORKMANSHIP AT THE TIME OF ITS ORIGINAL PURCHASE BY A CONSUMER, AND FOR A SUBSEQUENT PERIOD OF SIX (6) MONTHS. SHOULD YOUR PRODUCT NEED WARRANTY SERVICE, PLEASE RETURN IT TO THE DEALER FROM WHOM IT WAS PURCHASED OR CONTACT YOUR LOCAL LG ELECTRONICS CONTACT CENTRE TO GET FURTHER INFORMATION.

