

LG xboom Buds Plus

LG Wireless Bluetooth® Earbuds

Owner's Manual

For user safety and convenience,
please read the user manual before
using the product.

BUDSPLUS

Contents

Exploring the Product

- 3 Charging Case
- 7 Earbuds

Connecting with Bluetooth

- 8 Connecting the Earbuds to a Smartphone via Bluetooth
- 9 Multiple Connections
- 9 Automatic Reconnection

Listening to Sound with Earbuds

- 10 Wearing Earbuds
- 11 Replacing the Ear hooks
- 13 Listening to Music
- 14 Receiving Phone Call
- 15 Listening to Ambient Sound/Active Noise Cancellation (ANC)

Connecting to an External Device for Use (Plug and Wireless Mode)

- 17 Using the Plug & Wireless mode
- 18 Turning Plug and Wireless mode on/off (when connecting with an analog device)
- 20 Turning Plug and Wireless mode on/off (when connecting with a USB Audio Device)

Charging

- 22 Charging by cable
- 23 Charging Wirelessly
- 24 Description on UVnano
- 25 Checking Battery Status

Connecting to the Bluetooth App

- 27 Connecting the LG xboom Buds App
- 28 Listening to an Auracast™ broadcast
- 29 Connecting LG Gram and Earbuds

Cleaning Guide

- 30 How to clean your ear gel

Safety Precautions

- 31 Safety Notices and Warnings
- 32 Precautions when Using the Product
- 33 Prevention of product misuse

Things to Check before Reporting Malfunction

- 34 Troubleshooting

Appendix

- 35 Product Specifications

Safety Information

- 36 Prevention of Hearing Loss
- 36 Additional Information
- 36 Radio frequency exposure
- 37 Bluetooth connection precautions
- 37 Battery Information
- 38 Open Source Software Notice Information

Exploring the Product

| Charging Case

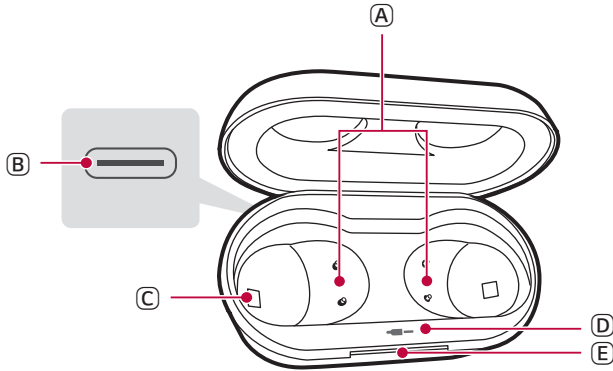



-
- (A) Earbuds charging terminals: You can charge the earbuds by inserting them into the charging case.
 - (B) Case charging port: You can charge a device or use Plug and Wireless mode.
 - (C) UVnano LED: If you charge the device with the earbuds attached and the cover closed, the UVnano LED operates for 10 minutes.
 - (D) Plug and Wireless mode Touch button: You can connect analog and USB audio devices and the charging case to listen to the sound through the earbuds.
 - You can turn the mode on or off by touching and holding the button for 3 - 5 seconds.
 - (E) Status indicator: You can check the battery status of the earbuds or charging case. You can also check the charging status, Bluetooth connection, UVnano, and Plug and Wireless mode operation status.

Status Indicators



Battery level state (charger not connected)

When you open the charging case, the battery status of the earbuds is displayed.

Status Indicators	Status of Status Indicator / Battery Status
	Turns on in red. / The battery level is below 20 %.
	Turns on in yellow. / The battery level is between 20~80 %.
	Turns on in green. / The battery level is above 80 %.

Charging status (charger connected)

When you charge the charging case either wired or wirelessly, the charging status of the earbuds is displayed.

Status Indicators	Status of Status Indicator / Battery Status
	Turns on in red. / Charging.
	Turns on in green. / Charging is complete.

When connecting with Bluetooth

To connect your smartphone and earbuds via Bluetooth, open the cover with the earbuds in the charging case.

The blue status indicator light on the front of the charging case will blink. When the Bluetooth connection is complete, the status indicator will turn off.

Status Indicators	Status of Status Indicator / Operation status
	It blinks blue. / The earbuds will attempt to connect to your smartphone via Bluetooth.

When UVnano LED is in operation

If you charge the device with the earbuds attached and the cover closed, the status indicator will show the charging status of the charging case.

After that, the status indicator will turn blue and the UVnano LED will work for 10 minutes.

Status Indicators	Status of Status Indicator / Operation status
	Turns on in blue. / UVnano LED will work for 10 minutes.



When turning on Plug and Wireless mode

To use it by connecting it to an analog device, connect the USB-C™ port of the analog device connection cable (USB-C™ to AUX) to the charging case, and then connect the AUX terminal to the desired device.

To use it by connecting it to a USB audio device, connect the USB-C terminal of the USB Type-C™ Charging and Data cable to the charging case, and then connect the USB-C terminal to the desired device. Then, touch and hold the Plug and Wireless mode touch button for 3 - 5 seconds to turn on the mode.

Check Plug and Wireless mode mode status

When Plug & Wireless mode is on, when you open or close the charging case cover, the battery status or charging status of the earbuds will be displayed. After that, the status indicator light will turn purple.

Status Indicators	Status of Status Indicator / Operation status
	It blinks purple slowly. / The charging case and earbuds are trying to connect.
	It turns on and off for 5 seconds. / The charging case and earbuds are connected.

When turning off Plug and Wireless mode

To turn off Plug and Wireless mode, touch and hold the Plug and Wireless mode touch button for 3 - 5 seconds.

Status Indicators	Status of Status Indicator / Operation status
	It will blink purple three times and turn off. / Plug and Wireless mode will be turned off.

When doing a factory reset

With the earbuds in the charging case, touch and hold the left or right touchpad of the earbuds for more than 10 seconds to perform a factory reset.

Status Indicators	Status of Status Indicator / Operation status
-------------------	---



It blinks red. / The factory reset will be performed.

| Earbuds

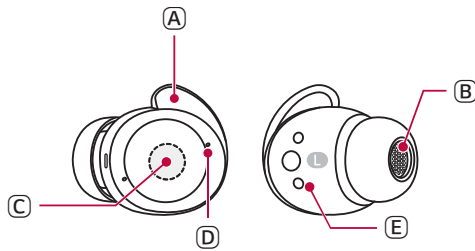

-
- (A) Ear hooks
 - (B) Speaker mesh (microphone)
 - (C) Touch pad
 - (D) Microphone
 - (E) Earbuds charging terminals

✔ **Note**

Be careful that foreign substances are not over the Earbuds charging terminals.

Connecting with Bluetooth

Connecting the Earbuds to a Smartphone via Bluetooth

- 1 Turn on the Bluetooth® function of your smartphone or a device you want to connect.
- 2 Open the cover with earbuds attached to the charging case. The blue status indicator on the front blinks. If the blue status indicator does not blink, or if you want to connect a device other than the one already connected, touch and hold the touch pad of the left or right earbud for 3 - 5 seconds.

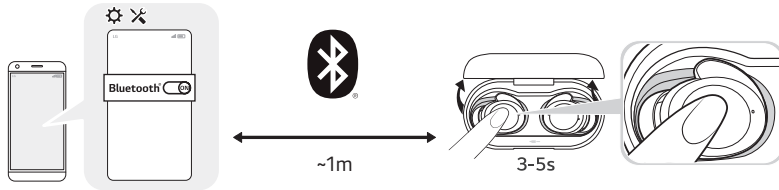

- 3 When the Fast Pair connection pop-up appears at the bottom of the smartphone screen, touch the pop-up to connect.
 - Only Android™ 6.0 or higher is supported, and Bluetooth® and location information settings of the mobile device are required.
- 4 If the connection pop-up does not show up, select and connect [xboom Buds Plus] in the Bluetooth® menu of the smartphone. (For users of iOS or Android 5.0 or lower)
 - If the earbuds model name is displayed abnormally on the Android device, please change the model name in the Bluetooth® menu of the settings of the connected device.
 - The model name is BUDSPLUS, but when connected via Bluetooth, it is displayed as the representative model name xboom Buds Plus on smartphones and apps.

✓ Note

- To connect with another device, perform the above procedures again.
- When you open the cover of the charging case, the earbuds and smartphone will connect via Bluetooth, and when you close it, the connection will be disconnected.
- For a description of the status indicator, see "Status Indicators" on page 4.

Multiple Connections

If you use the LG xboom Buds app, you can connect and use two devices, such as a smartphone and a PC at the same time.

- 1 Please activate Multi-Point & Multi-Pairing on the LG xboom Buds app.
- 2 Put the earbuds in the charging case and perform the connecting procedures in the same way.
- 3 You can use the multi-connection function more conveniently in the detailed Multi-Point & Multi-Pairing settings.

✔ Note

- In some media players, the sound may not switch automatically when content is played.
 - If you want to connect a new device while two devices are connected, you can do so by disconnecting one device and then connecting it.
-

Automatic Reconnection

If you open the charging case of the earbuds, they are automatically connected to the last connected and used device. (If the device cannot be found, it changes to the Bluetooth Search mode.)

If automatic reconnection is not done, search for earbuds on the device to be connected and connect them manually.

Listening to Sound with Earbuds

| Wearing Earbuds

- 1 Remove the earbuds from the charging case by pushing the inside of the earbuds outward, and then insert them in your ears for a firm fit.

✔ **Note**

If you use an ear gel sized to fit your ears, you can improve performance of active noise cancellation (ANC). You can then listen to music with rich sound quality.

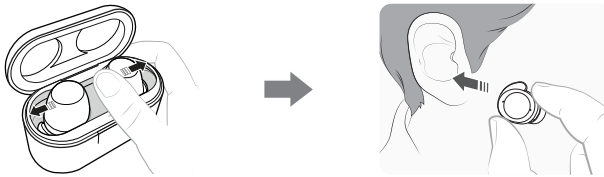

- 2 If you wear earbuds properly, you can hear a notification detection sound.



* To replace the ear gel, align the hole shape of the ear gel with the protrusion of the earbuds and fasten it.

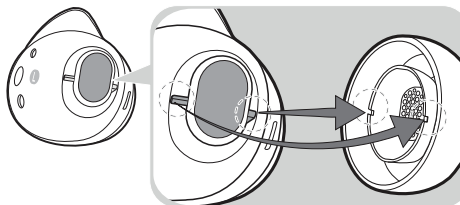

Replacing the Ear hooks

Replacing the Large Size Ear Hooks

- 1** Grasp the end of the wing of the ear hooks from the earbuds and separate it.



- 2** Insert the earbuds with the wide part of the ear hooks facing forward. Hold the wing of the ear hooks and turn it little by little to align the hole of the ear hooks with the protrusion of the earbuds.

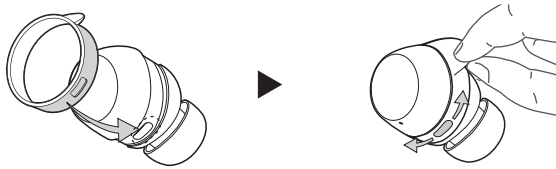

Replacing the Small Size Ear Hook

- 1** Use your fingernail to gently apply pressure to separate the ear hooks from the earbuds.



- 2** Insert the earbuds with the wide part of the ear hooks facing forward. Turn the ear hooks slightly with your finger to align the hole in the ear hooks with the protrusion on the earbuds.



* Check the L (left) or R (right) marks on the Ear hooks and Earbuds, then replace the Ear hooks with the Ear hooks in the same direction as the Earbuds.

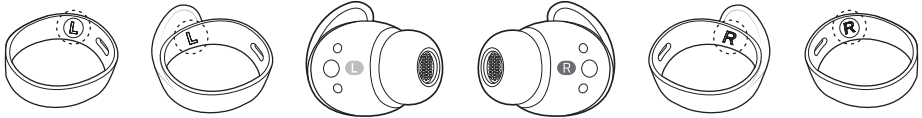

* Be careful as it may be damaged if you pull on the ear hooks with too much force.

Listening to Music

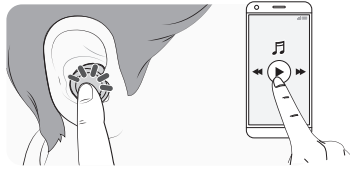



How to Use	Function
● : Touch once	Play/Stop
●● : Touch twice	Volume Down (Touch the left) Volume Up (Touch the right)
●●● : Touch three times	Play the previous song (Touch the left) Play the next song (Touch the right)

✔ Note

You can change how to use the listen to music in the Touch function settings of the LG xboom Buds app.

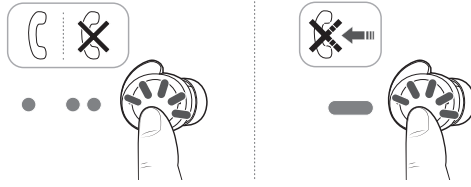
Receiving Phone Call

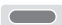

How to Use	Function
 : Touch once	Answer Call
 : Touch twice	End Call
 : Touch and hold	Reject call

✔ Note

If you want to make a new call while on a call, touch the left or right earbud. The current call will be put on hold and you can answer the other call that came in during the call. The existing call on hold can be ended on your smartphone. (This operates differently depending on the smartphone settings.)

Listening to Ambient Sound/Active Noise Cancellation (ANC)

Listening to ambient sound

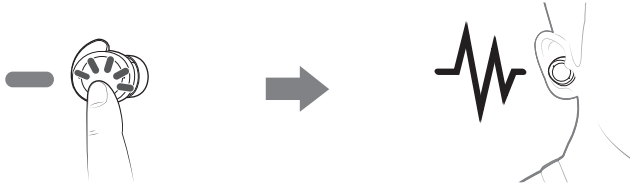

When the listening to ambient sound function turned on allows you to control the amount of sound you can hear around you.

Active noise cancellation (ANC)

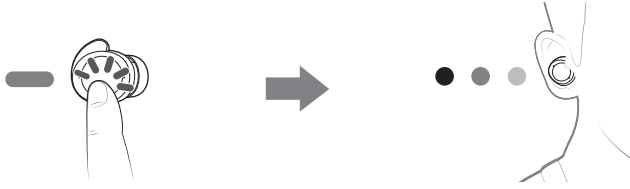

The active noise cancellation (ANC) function blocks external sounds during use. Therefore, use it when you do not want to be disturbed while listening to music or watching a video.

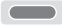
How to Use	Function
 : Touch and hold	Change the functions between active noise cancellation (ANC) and listening to ambient sound.

- You can set listening to ambient sound or active noise cancellation (ANC) functions in the LG xboom Buds app.
- You can set listening mode and conversation mode in the LG xboom Buds app.
- When using listening to ambient sound function or active noise cancellation (ANC) function, the battery life will be shorter than when these functions are not active.
- The listening to ambient sound or active noise cancellation (ANC) function operates when you are in standby/listening to music/during a call.
- The listening to ambient sound or active noise cancellation (ANC) function require both earbuds to be worn to work.
 - ANC stands for active noise cancellation.

Caution



When the ambient sound mode is executed, you may hear a loud ambient sound suddenly. Pay attention to safety when using active noise cancellation (ANC) outdoors.

Connecting to an External Device for Use (Plug and Wireless Mode)



Using the Plug & Wireless mode

You can connect the charging case to an analog device such as audio in airplane seat, treadmill, TV or a USB audio device such as PC to listen to the sound with an earbuds.

Connecting with an analog device for use

How to Use	Function
 : Touch once	Mute or unmute
 : Touch twice	Volume Down (Touch the left) Volume Up (Touch the right)

Connecting with a USB audio device for use

How to Use	Function
 : Touch once	Play/Stop
 : Touch twice	Volume Down (Touch the left) Volume Up (Touch the right)
 : Touch three times	Play the previous song (Touch the left) Play the next song (Touch the right)

Turning Plug and Wireless mode on/off (when connecting with an analog device)

Turning Plug and Wireless mode on

- 1 Connect the USB-C™ port of the USB-C™ to AUX cable to the charging case.
- 2 Connect the AUX terminal to a desired device.

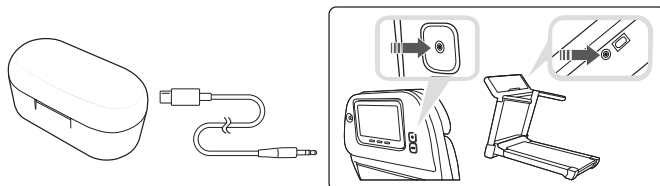

- 3 Wear earbuds on your ears.
- 4 Touch and hold the Plug and Wireless mode Touch button for 3 - 5 seconds to turn on the mode.
- 5 The charging case and earbuds will attempt to connect, and the purple status indicator will slowly blink purple.
- 6 When the charging case and earbuds are connected, the purple status indicator will turn on for 5 seconds and then turn off.
 - When Plug & Wireless mode is on, when you open or close the charging case cover, the battery status or charging status of the earbuds will be displayed. After that, the status indicator light will turn purple.

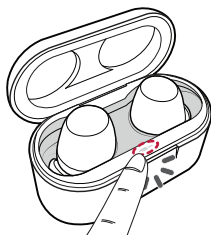

Turning Plug and Wireless mode off

- 1 Touch and hold the Plug and Wireless mode Touch button for 3 - 5 seconds to turn off the mode.
- 2 The purple status indicator light on the charging case blinks three times and then turns off.

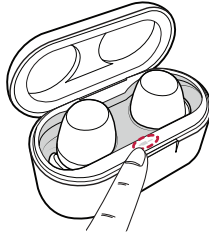

✔ Note

- It does not support the call function.
 - The USB-C™ to AUX cable does not support the charging function.
 - The product may not be compatible with some devices, and certain airplane seats may require a conversion adapter (sold separately).
 - If you use the product for a long time, the use time (including the charging case) may be shorter than when connecting and using a smartphone.
 - For a description of the status indicator, see "Status Indicators" on page 4.
-

Turning Plug and Wireless mode on/off (when connecting with a USB Audio Device)

Turning Plug and Wireless mode on

- 1 Connect the USB-C terminal of the included USB Type-C™ Charging and Data cable to the charging case.
- 2 Connect the USB-C terminal to a desired device.

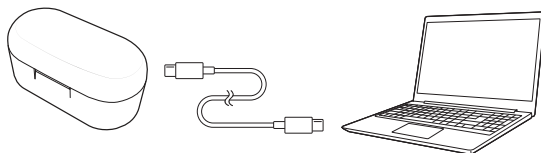

- 3 Wear earbuds on your ears.
- 4 Touch and hold the Plug and Wireless mode Touch button for 3 - 5 seconds to turn on the mode.
- 5 The charging case and earbuds will attempt to connect, and the purple status indicator will slowly blink purple.
- 6 When the charging case and earbuds are connected, the purple status indicator will turn on for 5 seconds and then turn off.
 - When Plug & Wireless mode is on, when you open or close the charging case cover, the battery status or charging status of the earbuds will be displayed. After that, the status indicator light will turn purple.

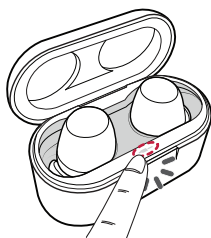

Turning Plug and Wireless mode off

- 1 Touch and hold the Plug and Wireless mode Touch button for 3 - 5 seconds to turn off the mode.
- 2 The purple status indicator light on the charging case blinks three times and then turns off.

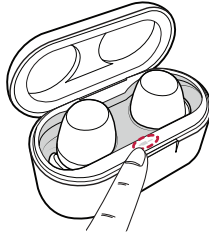

✔ Note

- When connected with a USB audio, it supports the call function and is displayed as xboom Buds Plus Plug&Wireless on the USB audio device.
 - If you use the product for a long time, the use time (including the charging case) may be shorter than when connecting and using a smartphone.
 - For a description of the status indicator, see "Status Indicators" on page 4.
-

Charging

| Charging by cable

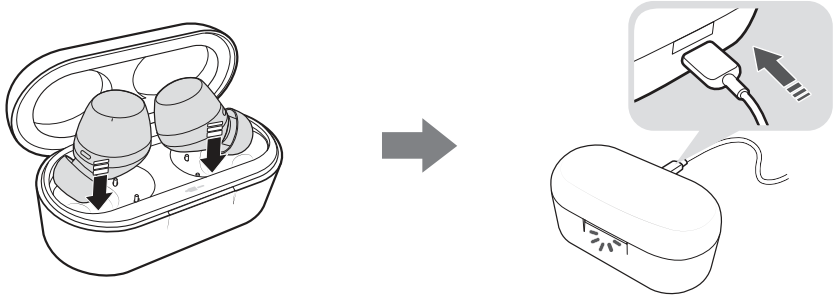

If you connect the USB Type-C™ Charging and Data cable the charging status shows up on the charging case.

✔ Note

- The earbuds and charging case are charged at the same time.
 - The Case charging port of the charging case does not support the power supply function to other devices such as smartphone.
 - Use the USB Type-C™ Charging cable provided with the product.
-

Charging Wirelessly

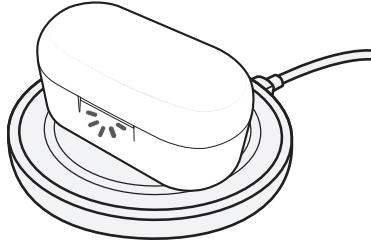

Place the charging case on the center of the wireless charger.

✔ Note

- A wireless charger is not provided.
 - For some wireless chargers, the wireless charging function may not operate.
 - For wireless charging, it takes a long to charge.
-

Description on UVnano

The charging case has a built-in UVnano LED to keep the earbuds clean.

If you charge the device with the earbuds attached and the cover closed, the status indicator will show the charging status of the charging case. After that, the status indicator will turn blue and the UVnano LED will work for 10 minutes.

* UVnano is a compound word of UV and nanometer, the unit of UV.

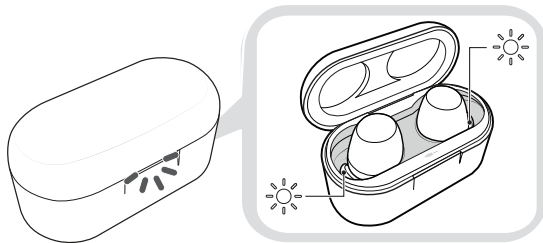

✔ Note

- The UVnano charging case removes up to 99.9% of harmful germs from ear gel.
- The white product may have a different colour on the UVnano LED contact part, but there is no problem with performance.
- For a description of the status indicator, see “Status Indicators” on page 4.

⚠ Caution

Please note that the temperature of the earbuds may become higher while the UVnano LED is operating.

Checking Battery Status

If you open the charging case, the battery status of the earbuds is displayed.

When the earbuds are not attached, the battery status of the charging case is displayed.

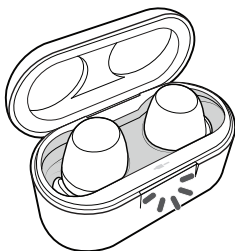

Status indicator	Battery level state (charger not connected)
Red	Less than 20 %
Yellow	20 % ~ 80 %
Green	Over 80 %

Status indicator	Charging status (charger connected)
Red	Charging
Green	Fully charged

✔ Note

- If you close the charging case, the battery status of the charging case is displayed.
 - When the battery in the charging case is completely consumed, the earbuds cannot be turned on or off. Please charge the charging case.
-

Status indicator

Status	Operation
Bluetooth® search mode	The blue status indicator blinks.
Battery 20% or less	The red status indicator turns on and off.
Battery 20% ~ 80%	The yellow status indicator turns on and off.
Battery 80% or higher	The green status indicator turns on and off.
When a charging error occurs	The red status indicator blinks.
While battery is charged (charger connected)	The red status indicator turns on.
Battery charging completed (charger connected)	The green status indicator turns on.

Connecting to the Bluetooth App

Connecting the LG xboom Buds App

- 1 Search for "LG xboom Buds" on Google Play Store or App Store on your smartphone or scan the QR code below to install the LG xboom Buds app.
- 2 Run the app to use various functions [Battery Status, Voice Alert Settings (Android only), Sound Effect, and Find my earbuds function, etc.] Only Android 7.0 or iOS 13 or higher is supported.



<Android>



<iOS>

Listening to an Auracast™ broadcast

You can listen to broadcasts that are in progress around you in the Auracast™ broadcast feature in the LG xboom Buds app.

- 1 Run the LG xboom Buds app and select listen to Auracast™ broadcast.
- 2 Select the Auracast™ broadcast you want to listen to from the searched list.
- 3 Once the Auracast™ broadcast is connected, you can listen to the broadcast through the earbuds.

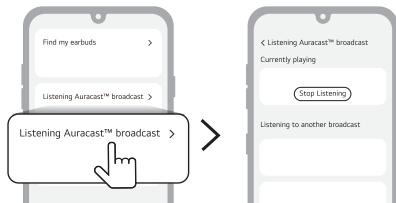

Function	Description
Currently playing	This is the broadcast you are currently listening to. <ul style="list-style-type: none">• Stop Listening: Select to stop listening to the broadcast.• Listen again: Select to listen to the broadcast again.
Listening to another broadcast	In addition to the broadcast you are currently listening to, broadcasts that can be heard around you will appear in the list. <ul style="list-style-type: none">• Search: Press the button to search for broadcasts that can be heard around you.• Lock symbol: Appears when a password is required.

✔ Note

- If a password is required, the Input password window will appear.
- If you play music or perform additional operations on a connected device while listening to Auracast™ broadcast, the Auracast™ connection may be disconnected.
- Depending on the device (smartphone, TV, etc.) that supports Auracast™ broadcasting, the sound may be out of sync.
- The degree of out of sync may vary depending on the device that supports Auracast™ broadcasting.
- For detailed instructions, please refer to the user manual of the device (smartphone, TV, etc.) that supports Auracast™ broadcasting.

Connecting LG Gram and Earbuds

- ❶ Open the cover with earbuds attached to the charging case.
- ❷ The blue status indicator on the front blinks.
 - If the blue status indicator does not blink touch and hold the touch pad of the left or right earbud for 3 - 5 seconds.
- ❸ When the connection pop-up appears on the PC screen, click the pop-up to connect.
- ❹ Once the connection is complete, you can execute LG xboom Buds App by clicking icon on Windows Tray.
- ❺ Use various functions such as checking the Battery Status, Control ambient sound and ANC, and Sound Effects through the LG xboom Buds app.

✔ Note

- The LG xboom Buds app is available for LG Gram Pro, LG Gram Pro 360, and LG Gram released after 2025.
 - For some models released in 2025, it will be provided sequentially through future updates.
-

Cleaning Guide

| How to clean your ear gel

Make sure to clean the ear gel periodically to keep it clean!

If the ear gel is clogged, the sound may be reduced or the ANC performance may be reduced!

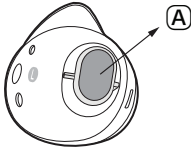

Earbuds

A Speaker mesh



Ear gel

- 1** Separate the ear gel from the earbuds.
- 2** Remove contaminants (earwax, sebum, etc.) from the ear gel.

* Foreign substances can be easily removed by washing in lukewarm water, and reuse after removing the water.

- 3** Reassemble the ear gel with the earbuds.

Safety Precautions

| Safety Notices and Warnings

The following “Safety Precautions” are to prevent unexpected dangers or damages, so be sure to read them thoroughly.

‘Safety Precautions’ are divided into ‘Warning’ and ‘Caution’.

⚠ WARNING: Failure to follow the instructions may result in serious injury or death.

⚠ Caution: Failure to follow the instructions may result in minor injury or product damage.

- ⚠ Warning**
- Do not drop the product from a high place.
 - Make sure there is no alcohol, or benzene in contact with the product.
 - Do not store the product in a wet or dusty place.
 - Do not place heavy objects on the product.
 - Earbuds tested under controlled laboratory conditions with an IPX4 rating. Resistant to splashed water. Dry before using. Do not charge while wet. Case has not been tested for IPX4.
-

⚠ Caution

- Do not disassemble, adjust, or repair the product.
 - Do not place the product near excessive heat or flammable material.
 - The product may be damaged if an incompatible charger is used.
 - Keep small components of the product away from infants or children.
 - Make sure that foreign objects do not enter the charger's connectors (Case charging port and power plug). Foreign objects in the charger's connectors may result in fire or electric shock.
 - If you have a medical device implanted, contact your doctor before using this device.
 - For your safety, do not remove the battery incorporated in the product.
 - This product has a built-in battery, and the battery cannot be removed or replaced.
 - If you arbitrarily replace the battery or don't replace it correctly, it may explode.
 - The lithium-ion battery is a hazardous component that can cause injury.
 - Battery replacement by an unqualified professional can cause damage to your device.
 - Do not discard the battery arbitrarily. Follow the local procedure for discarding batteries.
 - In order to prevent unnecessary energy consumption, disconnect the device when fully charged. Always use an easily accessible power outlet for charging your device.
 - Risk of fire or explosion if the battery is replaced by an incorrect type.
 - Do not store or transport at pressures lower than 11.6 kPa and at above 15,000 m altitude.
 - Replacement of a battery with an incorrect type that can defeat a safeguard (for example, in the case of some lithium battery types).
 - Disposal of a battery into fire or a hot oven, or mechanically crushing or cutting of a battery, may result in an explosion.
 - Leaving a battery in an extremely high temperature surrounding environment that can result in an explosion or the leakage of flammable liquid or gas.
 - A battery subjected to extremely low air pressure may result in an explosion or the leakage of flammable liquid or gas.
 - Do not carelessly throw away old batteries. It can cause an explosion or fire. The disposal method may vary by country and region. Dispose of it in an appropriate manner.
-

| Precautions when Using the Product

Wipe the product clean if it has been exposed to a lot of sweat.

Keep the area around the earphones clean.

If you wear earphones for a long time, it may cause pain, and if the moisture in the ears remains long, it may cause skin trouble.

Prevention of product misuse

To prevent misuse of the product, please be sure to check the contents below.

Precautions for using the product

- You cannot charge external devices with the USB port.
- When moving the product, pull out the power cord and all cables connected to the product.
 - Otherwise, it may cause a fire or electric shock.
- Do not open or close the cover of the charging case with excessive force.
- Do not mount the earbuds on the charging case with the left and right sides reversed.
 - If you mount the earbuds reversed and close the cover of the charging case forcefully, it may result in a product breakdown.
- Make sure that water or any other liquid does not get into the charging case.
 - If liquid gets into the charging case, it may cause a breakdown.
- Be careful not to insert or touch foreign substances into the charging port.

Things to Check before Reporting Malfunction



Troubleshooting

If you experience the following symptoms while using the product, please check them again. They may not be malfunctions.

Symptom	Cause and Solution
If the power does not turn on	<ul style="list-style-type: none">• Check the battery level and charge it.
If a call cannot be made with the earbuds	<ul style="list-style-type: none">• If your smartphone does not support the hands-free function, you cannot use the call function.• Check the battery level and charge it.
If you cannot register the earbuds into the smartphone	<ul style="list-style-type: none">• Check whether power is turned on by opening the cover of the charging case.• Check that the earbuds are switched to search mode.<ul style="list-style-type: none">- If you touch and hold the touchpad on the left or right side of the earbuds for 3 to 5 seconds with the earbuds in the charging case, it is switched to search mode.
If you have replaced the earbuds or have problems with operation (factory reset).	<ul style="list-style-type: none">• Touch and hold the left or right touchpad of the earbuds for more than 10 seconds with the earbuds in the charging case.<ul style="list-style-type: none">- The status indicator on the charging case will blink red, indicating that the factory reset is in progress. Please reconnect the earbuds after factory reset.

Appendix

Product Specifications

General	Description
Power consumption	Off: 0.3 W
Bluetooth Specifications	V 5.4 (HFP/A2DP/AVRCP)
Battery	Earbud: 3.85 V / 70 mAh, Lithium-ion Charging case: 3.85 V / 475 mAh, Lithium-ion
Music Play Time Earbuds & With Charging case	ANC Off: Up to 10 (up to 8 hours with Adaptive EQ On) & Up to 30 hours* (up to 25 hours with Adaptive EQ On)* ANC On: Up to 7.5 (up to 7 hours with Adaptive EQ On) & Up to 24 hours* (up to 22 hours with Adaptive EQ On)*
Charging time	Earbud: within an hour Charging case: within 2 hours 30 minutes* Fast Charging: 5 min charge for up to 60 min playtime* <ul style="list-style-type: none">• When charging wired at room temperature
Rated Input Voltage	Earbud: 5 V  , 140 mA Charging case: 5 V  , 650 mA

*The use time may vary depending on the connected smartphone or use functions, settings, signal strength, operation temperature, using frequency band, and other use methods.

*Adaptive EQ detects the wearing status and automatically minimizes changes in sound. It only works when using the Noise Cancelling (NC On) and Normal (NC off, called Not Used) modes, and both earbuds must be worn for the effect to take effect. You can turn it off and on in the mobile app (Android/iOS).

Operating Temperature	0 °C ~ +40 °C
Operating Humidity	5 % ~ 60 %
Dimensions (mm)	<ul style="list-style-type: none">• Earbud: 25.3 mm (W) X 20.8 mm (L) X 23.9 mm (H)• Charging case: 63.0 mm (W) X 32.8 mm (L) X 31.2 mm (H)
Frequency range	2402 MHz to 2480 MHz

*Duration of use and charging time may vary depending on the connected mobile device or charging adapter, features being used, settings, signal strength, operating temperature, frequency band, and other methods of use.

Safety Information

| Prevention of Hearing Loss



If the volume of the headset is too high, you can experience permanent hearing loss. Set the volume to a safe level. It may sound normal, but if you often listen to high-pitch sounds that can damage your hearing, your ears get used to it over time.

If you feel ringing in your ears or hear faint voice, stop listening and get a hearing test. The louder the volume, the faster your hearing can be damaged.

Experts suggest you to do the followings to protect your hearing.

- Limit the time for using the headset with the high volume.
- Avoid the habit to turn up the volume not to hear loud noises around you.
- If you cannot hear people nearby, turn the volume down.

For how to set the maximum volume limit of the connection device, refer to the user manual provided with the connection device.

| Additional Information

The **Bluetooth**® word mark and logos are registered trademarks owned by the **Bluetooth** SIG, Inc. The Auracast™ word mark and logos are trademarks owned by the **Bluetooth** SIG. Any use of such marks by LG Electronics is under license.

Other trademarks and trade names are those of their respective owners.

Android, Google Play, the Google Play logo, and other related marks and logos are trademarks of Google LLC.



| Radio frequency exposure

This Bluetooth LG Stereo Headset is a radio transmitter and receiver. When in operation, it communicates with a Bluetooth-equipped mobile device by receiving and transmitting radio frequency (RF) electromagnetic fields (microwaves) in the frequency range 2402 to 2480 MHz.

Bluetooth connection precautions

The following environments affect the range and reception of Bluetooth signals:

- When walls, metal, human bodies, or other obstacles exist between the Bluetooth device and the connected device.
- When equipment that uses 2.4 GHz frequency signals (wireless LANs, wireless phones, microwave ovens, etc.) is placed near the devices being used.
- When using a Bluetooth device (TV, laptop, etc.) other than the mobile phone, the sound quality may be affected by the specifications and performance of the device.

Battery Information

A rechargeable battery has a long service life if treated properly. A new battery or one that has not been used for a long period of time could have reduced capacity the first few times it is used. Do not expose the battery to extreme temperatures, never above +50 °C or below -10 °C. For maximum battery capacity, use the battery at room temperature. If the battery is used in low temperatures, the battery capacity will be reduced. The battery can only be charged in temperatures between 0 °C and +45 °C.

[For coin battery application]

WARNING

- **INGESTION HAZARD:** This product contains a button cell or coin battery.
- **DEATH** or serious injury can occur if ingested.
- A swallowed button cell or coin battery can cause **Internal Chemical Burns** in as little as **2 hours**.
- **KEEP** new and used batteries **OUT OF REACH of CHILDREN**
- **Seek immediate medical attention** if a battery is suspected to be swallowed or inserted inside any part of the body.



- Remove and immediately recycle or dispose of used batteries according to local regulations and keep away from children. Do NOT dispose of batteries in household trash or incinerate.
- Even used batteries may cause severe injury or death.
- Call a local poison control center for treatment information.
- The compatible battery type is only SP1254
- The nominal battery voltage is 3.85 V
- Non-rechargeable batteries are not to be recharged.
- Do not force discharge, recharge, disassemble, heat above (manufacturer's specified temperature rating) or incinerate. Doing so may result in injury due to venting, leakage or explosion resulting in chemical burns.
- The product contains non-replaceable batteries.

Open Source Software Notice Information

To obtain the source code that is contained in this product, under GPL, LGPL, MPL, and other open source licenses that have the obligation to disclose source code, and to access all referred license terms, copyright notices and other relevant documents, please visit <https://opensource.lge.com>.

LG Electronics will also provide open source code to you on CD-ROM for a charge covering the cost of performing such distribution (such as the cost of media, shipping, and handling) upon email request to opensource@lge.com.

This offer is valid to anyone in receipt of this information for a period of three years after our last shipment of this product.







RISK GROUP 3

WARNING: UV-C rays are emitted from the product. AVOID EYE AND SKIN EXPOSURE TO UNSHIELDED PRODUCT.

WARNING: IF YOU DON'T DO CHARGING OR IF YOU OPEN THE CHARGING CASE, THE UVNANO FUNCTION IS NOT ACTIVATED.

Symbols

-  Direct current (DC)
-  CAUTION
-  Instructions
-  Coin / button cell battery

The spelling errors or inaccurate contents in this user manual are subject to change without prior notice by LG Electronics.

The output level shall automatically return to an output level not exceeding RS1 when the power is switched off.

