

SIMPLE MANUAL

# Mini Hi-Fi System

Please read this manual carefully before operating your set and retain it for future reference.  
To view the instructions of advanced features, visit <http://www.lg.com> and then download  
Owner's Manual. Some of the content in this manual may differ from your unit.

MODEL  
CK56



ENGLISH	ČESKY	SLOVENČINA
DEUTSCH	SLOVENČINA	SHQIP
FRANÇAIS	POLSKI	BOSANSKI
NEDERLANDS	ROMÂNĂ	SVENSKA
ITALIANO	LATVIEŠU	DANSK
ESPAÑOL	HRVATSKI	NORSK
ΕΛΛΗΝΙΚΑ	SRPSKI	SUOMI
PORTUGUÊS	Български	
MAĞYAR	МАКЕДОНСКИ	

[www.lg.com](http://www.lg.com)

Copyright © 2018 LG Electronics Inc. All Rights Reserved.  
1909\_Rev03



## Front Panel

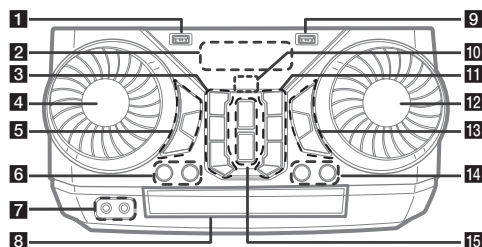

### 1 USB 1 Port

You can play sound files by connecting the USB device.

### 2 Display window

### 3 (Standby)

Turns the power on or off.

#### USB REC / DEMO

- Records to USB.
- To stop Recording, press and hold for 3 seconds.
- In power off status, if you press **USB REC / DEMO**, show DEMO mode.

#### (Skip/Search)

- Skips backward.
- Searches for a section within a track/file.
- Selects the radio stations.

#### (Stop) / RDS

- Stops playback or cancels DELETE function.
- Radio Data System

### 4 EQUALIZER / SEARCH

- Chooses sound impressions.
- Searches a folder or a file.
- Selects the lighting effects.

### 5 SPECIAL EQ / BASS BLAST (or BASS BLAST+)

- Chooses special equalizer.
- Press and hold to select BASS (or BASS+) effect directly.

#### SEARCH

Moves to folder or file in selection mode.

#### OK

Selects a folder when searching a file.

### 6 LIGHTING

Selects lighting mode.

#### VOICE CANCELLER

You can reduce the vocal tones during music playback from various input sources.

### 7 PORTABLE IN jack

MIC (Microphone) jack

### 8 Disc tray

### 9 USB 2 Port

You can play sound files by connecting the USB device.

### 10 (Remote sensor)

### 11 F (Function)

Selects the function and input source.

#### WIRELESS LINK

- Selects MAIN or OTHER on WIRELESS PARTY LINK mode.
- Enable or disable WIRELESS PARTY LINK mode.

#### (Skip/Search)

- Skips forward.
- Searches for a section within a track/file.
- Selects the radio stations.

#### (Open/Close)

Opens and closes the disc tray.

### 12 MASTER VOL. (Volume) / MULTI

- Adjust speaker volume.
- Adjust microphone volume.
- Selects vocal effects.

### 13 VOCAL EFFECTS

Selects VOCAL EFFECTS mode.

#### MIC VOL (Microphone volume)

Selects microphone volume mode.

#### MIC ECHO

Selects ECHO mode.

### 14 KEY CHANGER ( / )

Changes the key to suit your vocal range.

### 15 AUTO DJ

Selects the AUTO DJ mode.

#### (Play/Pause)

- Starts or pauses playback.
- Selects stereo/mono.

## Rear Panel

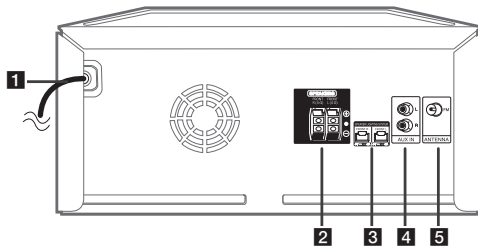

- 1** Power cord
- 2** **SPEAKERS** connector
- 3** **SPEAKER LIGHTING SYSTEM**  
Connect the speaker lighting cables.
- 4** **AUX IN (L/R)**  
Connect an auxiliary device.
- 5** **ANTENNA (FM)**

## Speaker Connection

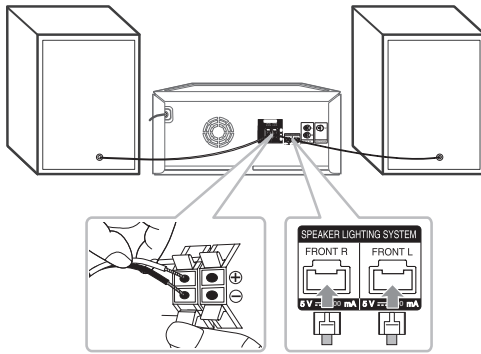

## Additional Information

### Specifications

Power Requirements	Refer to the main label on the unit.
Power Consumption	Refer to the main label on the unit. Networked standby : 0.5 W (If all network ports are activated.)
Dimensions (W x H x D)	Approx. 350 mm x 166 mm x 276 mm
Bus Power Supply (USB)	5 V $\pm$ 500 mA
Amplifier (Total RMS output power)	700 W RMS

Design and specifications are subject to change without notice.

### Controller App



Download the **Music Flow Bluetooth** App to your device. (Android only)

### LG Sound Sync (Wireless)



For more information, download the online owner's manual. <http://www.lg.com>

## Additional Information

### Replacement of battery

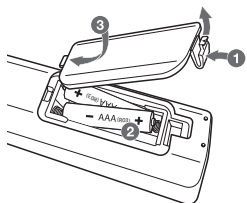

### How to disconnect the wireless network connection or the wireless device

Turn off the unit by pressing the power button for more than 5 seconds.

### Declaration of Conformity



Hereby, LG Electronics declares that the radio equipment type Mini Hi-Fi System is in compliance with Directive 2014/53/EU. The full text of the EU declaration of conformity is available at the following internet address:

<http://www.lg.com/global/support/cedoc/cedoc#>

For consideration of the user, this device should be installed and operated with a minimum distance of 20 cm between the device and the body.

Frequency range	Output power (Max.)
2402 to 2480 MHz	10 dBm