

# LG SIGNATURE

## OLED TV Usage and Management

Model : OLED97M5\*

ENGLISH

Please read this manual carefully before operating your set and retain it for future reference.

[www.lg.com](http://www.lg.com)

Copyright © 2025 LG Electronics Inc.  
All Rights Reserved.



# Before reading this manual

- Read this manual thoroughly before operating your TV, and keep it for future reference.
- On the website you can download the manual including installation, using, troubleshooting, specifications, license etc and view its contents on your PC or mobile device.
- **User Guide** : For more information about this TV, read the USER GUIDE embedded in the product. (Depending on model)
  - To open the USER GUIDE (⊗) → ([⊗]) → [Support] → [User Guide]

## Separate Purchase

- Separate purchase items can be changed or modified for quality improvement without any notification. Contact your dealer to buy these items. These devices only work with certain models.
  - The model name or design may be changed depending on the upgrade of product functions, manufacturer's circumstances or policies.
  - A cable to connect antennas and external devices must be purchased separately.
- ✓ **Note**
- Product specifications or contents of this manual may be changed without prior notice due to upgrade of product functions.
  - The items supplied with your product may vary depending on the model.
  - Image shown may differ from your TV.

## Warning! Safety instructions



CAUTION : TO REDUCE THE RISK OF ELECTRIC SHOCK, DO NOT REMOVE COVER (OR BACK). NO USER-SERVICEABLE PARTS INSIDE. REFER TO QUALIFIED SERVICE PERSONNEL.



This symbol is intended to alert the user to the presence of uninsulated "dangerous voltage" within the product's enclosure that may be of sufficient magnitude to constitute a risk of electric shock to persons.



This symbol is intended to alert the user to the presence of important operating and maintenance (servicing) instructions in the literature accompanying this apparatus.

WARNING : TO REDUCE THE RISK OF FIRE AND ELECTRIC SHOCK, DO NOT EXPOSE THIS PRODUCT TO RAIN OR MOISTURE.

- TO PREVENT THE SPREAD OF FIRE, KEEP CANDLES OR OTHER ITEMS WITH OPEN FLAMES AWAY FROM THIS PRODUCT AT ALL TIMES.

### Installation

- Do not place the device and/or remote control in the following environments:
  - \* An area exposed to direct sunlight.



- \* An area with high humidity such as a bathroom.



- \* Near any heat source such as stoves and other devices that produce heat.



- \* Near kitchen counters or humidifiers where they can easily be exposed to steam or oil.



\* Near flammable objects such as gasoline or candles.



\* An area exposed to rain or wind.



\* An area that may be exposed to water droplets or splashes.



\* Do not place items containing liquid—such as vases, cups, etc.—on top of the device or its main unit (e.g., the shelves above the unit).



\* An area that may be directly exposed to air conditioner airflow.

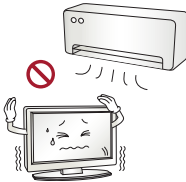

\* An area with excessive dust.



Otherwise, this may result in fire, electric shock, combustion/explosion, malfunction or product deformation.

## • Ventilation

- Install the device where there is proper ventilation.
- Do not install in a confined space such as a bookcase.



- Do not install the device on a carpet or cushion.



- Do not block or cover the device with cloth or other materials while unit is plugged in.



- Take care not to touch the ventilation openings. When watching the TV for a long period, the ventilation openings may become hot.
- Protect the power cord from physical or mechanical abuse, such as being twisted, kinked, pinched, closed in a door, or walked upon. Pay particular attention to plugs, wall outlets, and the point where the cord exits the device.
- Do not move the TV whilst the Power cord is plugged in.
- Do not use a damaged or loosely fitting power cord.
- Be sure to grasp the plug when unplugging the power cord. Do not pull on the power cord to unplug the TV.
- Do not connect too many devices to the same AC power outlet as this could result in fire or electric shock.
- **Disconnecting the Device from the Main Power**
  - The power plug is the disconnecting device. In case of an emergency, the power plug must remain readily accessible.
- Do not let your children climb or cling onto the TV. Otherwise, the TV may fall over, which may cause serious injury.
- **Outdoor Antenna Grounding** (Can differ by country):
  - If an outdoor antenna is installed, follow the precautions below.  
An outdoor antenna system should not be located in the vicinity of overhead power lines or other electric light or power circuits, or where it can come in contact with such power lines or circuits as death or serious injury can occur.
- Never touch this apparatus or antenna during a lightning storm. You may be electrocuted.

- Make sure the power cord is connected securely to the TV and wall socket if not secured damage to the Plug and socket may occur and in extreme cases a fire may break out.
- Do not insert metallic or inflammable objects into the product. If a foreign object is dropped into the product, unplug the power cord and contact the customer service.
- Do not touch the end of the power cord while it is plugged in. You may be electrocuted.
- **If any of the following occur, unplug the product immediately and contact your local customer service.**
  - The product has been damaged.
  - If water or another substance enters the product (like an AC adapter, power cord, or TV).
  - If you smell smoke or other odors coming from the TV.
  - When lightning storms or when unused for long periods of time.

Even the TV is turned off by remote control or button, AC power source is connected to the unit if not unplugged in.

• **Power Saving**

- Turn off the device after use, and unplug the power cord if it will not be used for a longer period of time (for Non-OLED devices only).



- In case of OLED devices, leave them in standby mode for the automatic pixel refresh to maintain optimal display performance.
- Do not use high voltage electrical equipment near the TV (e.g., a bug zapper). This may result in product malfunction.
- Do not attempt to modify this product in any way without written authorization from LG Electronics. Accidental fire or electric shock can occur. Contact your local customer service for service or repair. Unauthorized modification could void the user's authority to operate this product.
- Use only an authorized attachments / accessories approved by LG Electronics. Otherwise, this may result in fire, electric shock, malfunction, or product damage.
- Never disassemble the AC adapter or power cord. This may result in fire or electric shock.
- Handle the adapter carefully to avoid dropping or striking it. An impact could damage the adapter.
- To reduce the risk of fire or electrical shock, do not touch the TV with wet hands. If the power cord prongs are wet or covered with dust, dry the power plug completely or wipe dust off.

• **Batteries**

- Store the accessories (battery, etc.) in a safe location out of the reach of children.
- Do not short circuit, disassemble, or allow the batteries to overheat. Do not dispose of batteries in a fire. Batteries should not be exposed to excessive heat.
- Caution: Risk of fire or explosion if the battery is replaced by an incorrect type.

• **Remote Control**

- Check the condition of the remote control batteries regularly to prevent corrosion of the contacts.

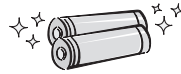

• **Moving**

- When moving, make sure the product is turned off, unplugged, and all cables have been removed. It may take 2 or more people to carry larger TVs. Do not press or put stress on the front panel of the TV. Otherwise, this may result in product damage, fire hazard or injury.
- Keep the packing anti-moisture material or vinyl packing out of the reach of children.
- Do not allow an impact shock, any objects to fall into the product, and do not drop anything onto the screen.
- Do not press strongly upon the panel with a hand or a sharp object such as a nail, pencil, or pen, or make a scratch on it. It may cause damage to screen.

• **Cleaning**

- When you clean the device, unplug the power cord and wipe gently with a soft/dry cloth.

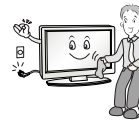

- Do not spray water or other liquids directly on the device.
- Do not clean the device with chemicals such as glass cleaner, air freshener, insecticide, lubricants, wax (car, industrial), abrasive, thinner, benzene, alcohol, etc., which can damage the device and/or its panel. Otherwise, this may result in electric shock or device damage.



# Installing and Using

## Examining the Appearance and Component Names of the Wireless TV (TV Screen + Zero Connect Box)

### TV Screen

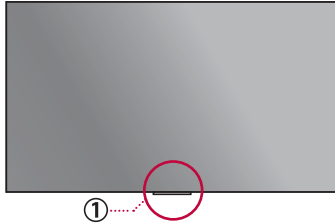

### ③ Dial

The wireless signal transmitter of the Zero Connect Box can be adjusted within a 90° range left or right.

### ④ Top LED

- Indicates the strength and status of the wireless signal.
- Blue (good), Green (normal), Red blinking (disconnected)
- If the wireless signal is weak, a notification message appears on the screen and the yellow LED lights up.

### ⑤ Wireless signal transmitter

The part with the antenna that transmits video and audio to the TV screen. The antenna's transmission direction can be adjusted up, down, left, or right using the sliding button and the dial.

### ⑥ Front LED

Indicates the power or operation status of the Zero Connect Box.

### ⑦ Voice recognition unit

The part that recognises the user's voice. It may not function properly if this part is blocked or if commands are given from the side or back of the Zero Connect Box.

### ⑧ External connection terminal

You can connect the Zero Connect Box's power cord and external video/audio devices such as external antennas and set-top boxes.

### ⑨ Pairing button

The product comes pre-paired, but if the normal screen does not appear, you need to pair it again.

- To re-pair, press the pairing button on the back of the Zero Connect Box for 5 seconds. The top LED flashes white.
- If you press and hold the power button on the TV Screen for 5 seconds, the standby indicator of the screen's power unit flashes white. Once pairing is complete, the top LED on the Zero Connect Box changes to a colour indicating signal strength.
- If pairing is not resumed within one minute, it will be cancelled and must be initiated again.

### ⑩ Microphone Button

The internal microphone can be turned on or off using the microphone switch.

### Zero Connect Box (WM25GA)

It is a device that wirelessly transmits video and audio signals to the TV screen by connecting an external antenna or set-top box.

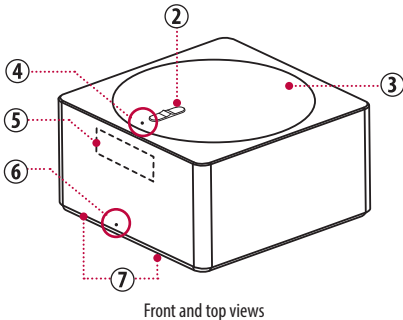

Front and top views

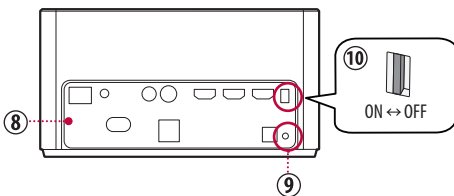

Rear view

### ① Wireless signal receiver & Power button

This part receives the video and audio signals sent by the Zero Connect Box. The power button is used to turn the TV screen on, switch to Always Ready mode, and pair with the Zero Connect Box.

### ② Sliding button

The transmission direction of the Zero Connect Box antenna can be adjusted within a range of 0 to 50° up or down.

# Installing the TV Screen

## Installing as a stand

This method involves setting up the TV screen upright on the floor using a stand.

- Ensure a minimum distance of 30 cm between the TV screen and the ceiling, side walls, and the stand and the rear wall when installing.

---

### Note

- If you pull the TV screen forward, it may fall and lead to damage or injury; therefore, ensure that it is secured to the wall.
- Install the screws on the back of the TV screen and the fixing hooks on the wall at the same level to prevent tilting. Then, use a sturdy strap to tie and secure the screws and fixing hook together. (Fixing hooks, screws, and straps are sold separately.)

---

### ⚠ Warning

- Do not apply foreign substances (oils, lubricants, etc.) to the screw parts when assembling the product. Doing so may cause damage to the product.
- Ensure that all screws provided are used when assembling the stand, and check that they are tightened fully. Incorrect assembly may cause the TV to tilt or fall, resulting in damage.
- Tightening the screws with excessive force may cause them to come off due to abrasion of the screw joint.

### ⚠ Caution

- Since the TV screen is heavy, at least two people should lift it vertically when unpacking or moving it.
- Do not move while holding the cable holder or cable organisation band. Doing so may damage parts or the TV screen, or may cause injury. (Depending on model)
- Do not forcibly tilt the TV screen. Doing so may cause it to fall and result in damage or injury.
- Take care to avoid getting your hands or fingers caught in the stand and injuring yourself.

## Installing as a wall mount

This method involves installing the TV screen horizontally on the wall using a wall mount. Refer to the wall-mounting bracket guide provided separately for detailed information.

- To install the support, ensure that the wall is made of a material that can endure the weight of the TV Screen, such as concrete, natural stone, or masonry brick.
- Leave sufficient space around the product so that the ventilation vents of the TV screen are not blocked.

---

### Note

- In the case of adhesive wall mounts, the TV screen may not adhere to the wall, depending on the condition of the wall.
- LG wall mount products are recommended. If you use a wall mount not provided by LG, ensure that it provides sufficient distance from the wall.
- When using a fixed wall mount, connect the cables before installing the TV screen.
- You can organise the TV screen power cord using the dedicated cable management.

---

### ⚠ Caution

- When installing the TV screen, ensure that you wear work gloves. Installing with unprotected hands may result in injury.
- If you installed your TV screen with an adhesive wall mount, ensure that it is used only when adhered to the wall. The TV screen may wobble or tilt, causing damage.
- Do not install the wall mount in a place where it may come into contact with oil or oil vapour. Doing so may damage the TV screen.

# Installing Zero Connect Box

## 1. Choosing the Installation Location

The Zero Connect Box can be installed in front, beside, below, or behind the TV screen. Follow the user guide for proper installation.

- Do not place obstacles between the TV Screen and Zero Connect Box. Doing so may interfere with wireless signal transmission and voice recognition functions.
- Install the Zero Connect Box lower than the wireless signal receiver of the TV screen.
- The transmission range of the Zero Connect Box varies depending on the direction in which it faces the TV screen. Refer to the figure below and install it within the appropriate distance.

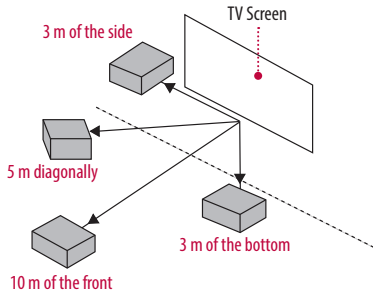

### Note

- Do not install two wireless TVs or Zero Connect Boxes in the same room. They may interfere with one another.
- Do not place electronic devices or objects on top of the Zero Connect Box. Doing so may cause interference in transmission, resulting in screen display failure.
- When using a sound bar, ensure that it does not obstruct the wireless signal receiver of the TV screen.

## 2. Adjusting the Reception Direction (Left/Right & Up/Down)

### Dial

If the front LED of the Zero Connect Box is not facing the TV screen wireless signal receiver, you can adjust the wireless signal transmission direction of the Zero Connect Box from 0° to 90° left and right by turning the dial.

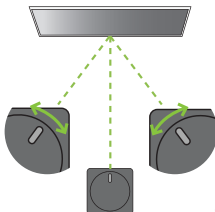

### Sliding button

If the wireless signal transmission direction of the Zero Connect Box is not toward the wireless signal receiver of the TV screen, you can adjust the wireless signal transmission direction from 0° to 50° up and down by adjusting the sliding button.

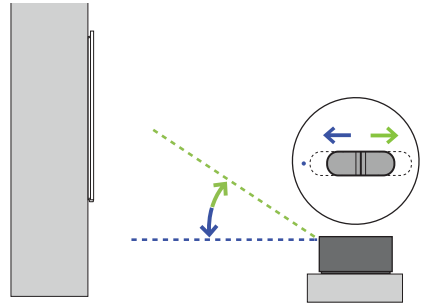

## 3. Checking Wireless Signal Strength

After completing the basic placement and settings, turn on the TV and check the signal strength through the colour of the top LED of the Zero Connect Box. The colours are blue (good), green (moderate) and red (disconnected).

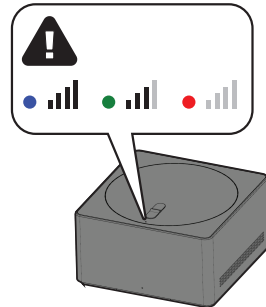

### Note

- If the top LED turns red, check for obstacles in the transmission path and ensure that the product is installed properly in the correct location.
- If the top LED is green, use the dial and sliding button to verify that the reception direction of the Zero Connect Box is correctly set.
- The screen may not display after cleaning or moving the product as the installation environment may have changed. Check the colour of the top LED of the Zero Connect Box and adjust accordingly.

## Recommended installation methods

### When Installing in a Straight Line in Front of the TV Screen

1. Before turning on the TV, ensure that the front LED of the Zero Connect Box is facing the **wireless signal receiver of the TV screen**.
2. If the front LED is not facing the wireless signal receiver of the TV screen, turn the dial on the top of the Zero Connect Box left or right to adjust the direction of the sliding button to face the wireless signal receiver.
3. Adjust the sliding button on the Zero Connect Box **towards the top LED**.
  - Once the dial and sliding button adjustments are completed, the signal transmission and reception path should be in the green direction shown in the figure.
4. After turning on the TV, check if the top LED colour of the Zero Connect Box is blue.
  - If the LED is not blue, adjust the dial and sliding button further to optimise the signal condition.
  - Ensure that there are no obstacles in the antenna transmission path.
  - Install the Zero Connect Box within 10 m of the TV screen. (provided that there are no obstacles in the way.)
  - The signal transmission angle of the Zero Connect Box is 45° left and right. If your TV screen is outside 45°, please refer to the diagonal or side mounting method.

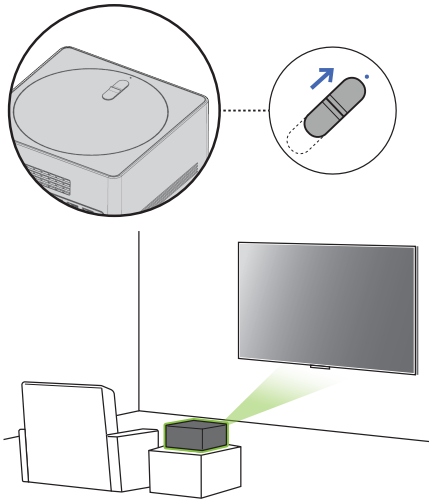

### When Installing Diagonally in Front of the TV Screen

1. Before turning on the TV, ensure that the front LED of the Zero Connect Box is facing the **wireless signal receiver of the TV screen**.
2. If the front LED is not facing the wireless signal receiver of the TV screen, turn the dial on the top of the Zero Connect Box left or right to adjust the direction of the sliding button to face the wireless signal receiver.
3. Adjust the sliding button on the Zero Connect Box **towards the top LED**.
  - Once the dial and sliding button adjustments are completed, the signal transmission and reception path should be in the green direction shown in the figure.
4. After turning on the TV, check if the top LED colour of the Zero Connect Box is blue.
  - If the LED is not blue, adjust the dial and sliding button further to optimise the signal condition.
  - Ensure that there are no obstacles in the antenna transmission path.
  - Install the Zero Connect Box within 5 m of the TV screen. (provided that there are no obstacles in the way.)

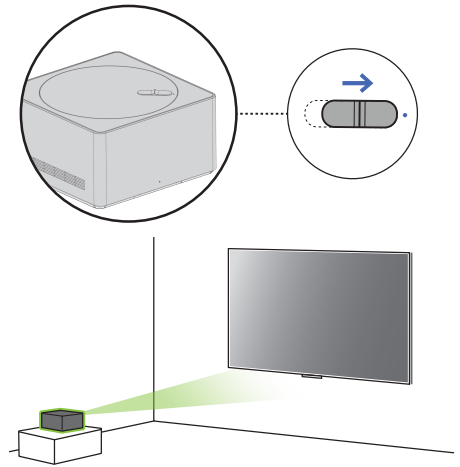

## When Installing Beside the TV Screen

1. Before turning on the TV, ensure that the front LED of the Zero Connect Box is facing the **wireless signal receiver of the TV screen**.
2. If the front LED is not facing the wireless signal receiver of the TV screen, turn the dial on the top of the Zero Connect Box left or right to adjust the direction of the sliding button to face the wireless signal receiver.
  - If the front LED of the Zero Connect Box faces the viewing direction, turn the dial left or right until it is at a 90° angle.
3. Adjust the sliding button on the Zero Connect Box to the **centre**.
  - Once the dial and sliding button adjustments are completed, the signal transmission and reception path should be in the green direction shown in the figure.
4. After turning on the TV, check if the top LED colour of the Zero Connect Box is blue.
  - If the LED is not blue, adjust the dial and sliding button further to optimise the signal condition.
  - Ensure that there are no obstacles in the antenna transmission path.
  - Install the Zero Connect Box within 3 m of the TV screen. (provided that there are no obstacles in the way.)
  - When using a floor stand, adjust the position so that the stand does not cover the wireless transmitter of the Zero Connect Box.

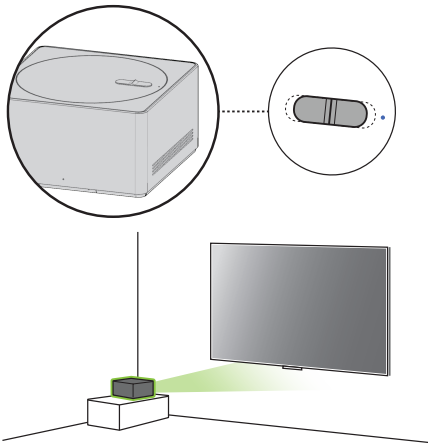

## When Installing Below the TV Screen

1. Before turning on the TV, ensure that the front LED of the Zero Connect Box is aimed at **the viewer facing the TV screen**.
2. Turn the dial on the top of the Zero Connect Box left or right to adjust the direction of the sliding button towards the viewer.
3. Adjust the sliding button on the Zero Connect Box in the **opposite direction of the top LED**.
  - Once the dial and sliding button adjustments are completed, the signal transmission and reception path should be in the green direction shown in the figure.
4. After turning on the TV, check if the top LED colour of the Zero Connect Box is blue.
  - If the LED is not blue, adjust the dial and sliding button further to optimise the signal condition.
  - Ensure that there are no obstacles in the antenna transmission path.
  - Install the Zero Connect Box within 3 m of the TV screen. (provided that there are no obstacles in the way.)
  - When installing the Zero Connect Box at the bottom of the TV screen, please do so within the area indicated in the figure.

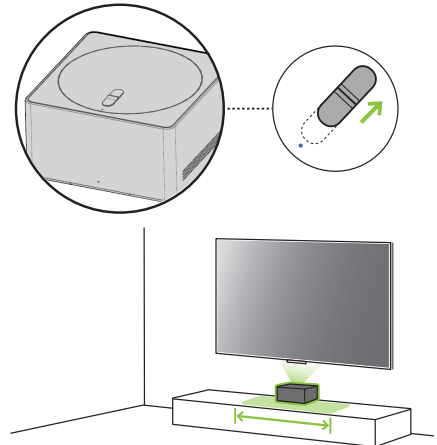

## When Installing Behind the TV Screen

1. Place the Zero Connect Box lower than **the wireless receiver of the TV screen**.
2. Before turning on the TV, ensure that the front LED of the Zero Connect Box is facing the wireless signal receiver of the TV screen.
3. If the front LED is not facing the wireless signal receiver of the TV screen, turn the dial on the top of the Zero Connect Box left or right to adjust the direction of the sliding button to face the wireless signal receiver.
4. Adjust the sliding button on the Zero Connect Box in the **opposite direction of the top LED**.
  - Once the dial and sliding button adjustments are completed, the signal transmission and reception path should be in the green direction shown in the figure.
5. After turning on the TV, check if the top LED colour of the Zero Connect Box is blue.
  - If the LED is not blue, adjust the dial and sliding button further to optimise the signal condition.
  - Ensure that there are no obstacles in the antenna transmission path.
  - Install the Zero Connect Box within 1 m of the TV screen. (provided that there are no obstacles in the way.)
  - Position the Zero Connect Box between the legs of the floor stand so it is not obstructed.

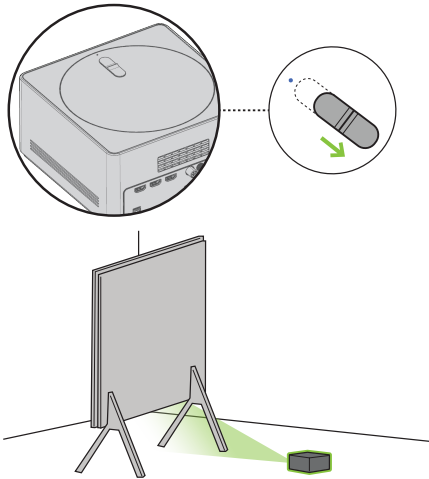

## Connecting External Terminals

You can connect external devices such as cables, HDMI, and set-top boxes to the TV. For more information of external device's connection, refer to the manual provided with each device.

- When used with an external device using a 60 GHz frequency, the screen may fail to display due to mutual interference.
- Set the appropriate resolution and frequency for the connected device. Failure to do so may cause straining of the eyes.
- The detailed installation method may vary depending on the TV model.

## Installing Antenna/Cable

- Insert the coaxial cable that transmits audio/video signals into the antenna/cable input terminal or antenna input terminal on the back of the Zero Connect Box.
- Be careful not to bend the copper wire when connecting the coaxial cable.
- Use a signal amplifier if the signal is weak.
- When using one antenna for two or more TVs, use a signal splitter.

---

### Note

- Do not apply oil or lubricant to the screws used during installation. Doing so may cause the TV to malfunction.
- 

## Satellite dish

Connect the TV to a satellite dish to a satellite socket with a satellite RF cable (75 Ω). (Depending on model)

## HDMI

- Use an HDMI certified cable (less than 3 m) with the HDMI logo (Ultra High Speed HDMI<sup>®</sup>/™ cable).
- Turn off the power of the TV and all connected devices, and unplug them from the socket before connecting the HDMI cable.
- Connecting a device that supports the HDMI Ultra HD Deep Colour feature to the TV will provide a clearer image. If you connect a device that does not support this feature and enable the feature, it may not work properly. If problems arise, change the settings.

---

### Note

- HDMI audio support formats may vary depending on the TV model.
  - HDMI devices should have bezels less than 10 mm thick and 18 mm width.
-

## USB / USB Hub

If the USB hub connected to the TV does not recognise USB devices, connect the USB directly to the TV terminal.

---

### Note

- If the shapes of the TV terminal and the USB device do not match, use an extension cable that supports USB 2.0.
  - USB devices should have bezels less than 10 mm thick and 18 mm width.
- 

## IR Blaster

This is an infrared transmitter that allows smoother control of devices such as set-top boxes, Blu-ray players, DVD players, sound bars, and gaming consoles.

- If the Zero Connect Box is installed in a location other than the bottom of the TV, external devices may not be controlled smoothly with the TV remote control; therefore, connecting an IR blaster is recommended.
- Controlling the IR blaster requires an integrated remote control setting.
- Secure both ends of the IR blaster to the front (receiver) of the external device remote control using the tape provided.

## Wired LAN

- When connecting to a wired LAN, use a CAT 7 cable with high-speed Internet transmission. (Only when LAN port is provided.)
- TV audio can be transmitted to the sound bar (external audio device). When transmitting via wired methods (optical digital, HDMI ARC), connect to the rear external terminal of the Zero Connect Box, and when transmitting wirelessly (LG soundbar supporting the WOWCAST feature), use the WOWCAST feature. (Depending on country)

## Using the TV

### Using the power button

Press the **power button** (⏻) located on the bottom of the TV briefly to turn the screen on and hold it to turn off all functions and the screen.

- Only use the power button when the TV screen and the Zero Connect Box are connected.
- The shape and location of the power button may vary depending on the TV model.
- When you turn on the power for the first time after purchasing the product, it may take about 1 minute for the screen to turn on due to initialisation.
- For models with motion sensors, if you set screen on with the motion sensor, the TV will turn on by recognising the motion. (Depending on model)

### Using hands-free voice control

- To use hands-free voice control, ensure that the front LED of the Zero Connect Box is facing the user, and turn the dial left or right so that the sliding button points towards the wireless receiver of the TV screen.
- Press the remote control **Q.Settings button** (⚙️) to turn on hands-free voice control. The feature settings path may vary depending on the TV model.

⚙️ → [⊞] → [General] → [AI Service] → [Voice Recognition Settings] → [Use Hands-free Voice Control]

---

# Managing

---







## Protecting the OLED TV Screen

- Unlike general LED/LCD TVs, OLED TVs can display perfect black and produce clear images without light blurring.
- Due to the characteristics of OLED materials that provide high-resolution display, image retention may occur or persist, leaving an afterimage on the screen.
- Image retention is a common phenomenon in all OLED panels. Using the recommended viewing mode can minimise image retention.
- Avoid displaying images that are likely to cause image retention, and follow the recommendations.

## Images that are likely to cause image retention

- Screen with black areas on one or more sides on the top, bottom, left or right
- Images whose aspect ratio is 4:3 or 21:9.
- Screens with images fixed for a long time, such as channel numbers, broadcast station logos, game console icons, or set-top box menus
- Other static screens or screens that repeat the same scene

## Recommendations for Minimising Image Retention

- When watching TV for extended periods, press the remote control **Q.Settings button**  and configure the screen as follows.
  1.  → [⊙] → [Picture] → [Select Mode] → [Auto Power Save]
  2.  → [⊙] → [Picture] → [Advanced Settings] → [Brightness] → [OLED Pixel Brightness] → Adjusting to Low
  3.  → [⊙] → [General] → [OLED Care] → [OLED Panel Care] → [Adjust Logo Brightness] → [High]
- If there are black areas on one or more of the top, bottom, left, or right sides of the screen, press the remote control **Q.Settings button**  to remove the black areas before watching.
-  → [⊙] → [Picture] → [Aspect Ratio] → [User Selection] → [Vertical Zoom] or [4-Way Zoom]
- Turn off the menu for setting up external devices such as set-top boxes so that it is not displayed on the screen for a prolonged period.



---

### Note

- OLED TVs automatically lower screen brightness when a fixed image is received for an extended period and restore brightness once the fixed image is gone.
  - This is one of the features of the TV for minimising image retention and is not a malfunction.
- 

## Running Pixel Cleaning

OLED TVs are equipped with a pixel cleaning feature that detects screen conditions on its own to prevent retention.

- Pixel cleaning automatically calculates the optimal execution time based on cumulative viewing time and runs automatically when you turn off the TV.
- Horizontal lines may appear at the top and bottom of the screen during pixel cleaning.
- The pixel cleaning feature works when the TV is connected to the power cord and main power.
- Pixel cleaning can also be run manually by pressing the remote control **Q.Settings button** .
-  → [⊙] → [General] → [OLED Care] → [OLED Panel Care] → [Pixel Cleaning]

# Troubleshooting

- If you notice any of the problems below while using the product, please check again. It may not be a fault.
- Before contacting the LG Electronics Service Centre, press the  button on the remote control three times in TV/HDMI input mode to check the product model name and serial number. You will be able to receive faster assistance.

## Power and Screen

<p><b>The product does not turn on.</b></p>	<p>» <b>Is the power cord plugged in properly?</b> Check if the power cord is plugged properly into the product and socket.</p> <p>» <b>Is there a problem with the socket?</b> Plug the power plug of another device into the socket where the product was plugged in to check if the socket is functioning properly.</p>
<p><b>The product turns off suddenly.</b></p>	<p>» <b>Is the sleep timer set?</b>  → [⊕] → [General] → [System] → [Time &amp; Timer] → [Timers] → Set [Sleep Timer] / [Power Off Timer] to [Off] / [Off].</p> <p>» <b>Check if the external devices are working together.</b> Stop using the external devices you are using together and check if the TV is working normally.</p> <p>» <b>Did the auto-off feature work?</b> This product is equipped with an auto-off function that automatically turns off the power if the remote control is not used for 15 minutes without an input signal.</p>
<p><b>Dots on the screen.</b></p>	<p>» <b>Do you see white dots, bright dots, dark dots, or flickering dots on the screen?</b> This product is an advanced product containing millions of pixels. You may see flickering dots of about 1/1,000,000 (1 PPM). These are not considered product defects or malfunctions.</p> <ul style="list-style-type: none"> <li>• White Dots: dots that appear bright</li> <li>• Bright Dots: dots that appear brighter than normal image</li> <li>• Dark Dots: dots which part of a letter or an object is invisible or blurry</li> <li>• Flickering Dots: Dots that flicker</li> </ul>

## Zero Connect Box Connection

<p><b>A power connection image appears on the screen.</b></p>	<p>» <b>Is the Zero Connect Box connected properly?</b> Ensure that the Zero Connect Box power cord is plugged firmly into the socket.</p>
<p><b>A Zero Connect Box connection image appears on the screen.</b></p>	<p>» <b>Are there any objects interfering with the wireless signal transmission?</b> Clear any objects between the TV screen and the Zero Connect Box.</p> <p>» <b>Is the wireless signal from the Zero Connect Box properly oriented?</b> Adjust the dial and sliding box on top of the Zero Connect Box according to the recommended installation method for each location of the Zero Connect Box.</p>

---

## Hands-free Voice Control

---

Voice recognition is not working well.

» **Is the Hands-free Voice Control feature turned on?**

 →  → [General] → [AI Service] → [Voice Recognition Settings] → Set [Use Hands-free Voice Control] to On. (Depending on model)

» **Is the front of the Zero Connect Box facing the user?**

Install the Zero Connect Box with its front facing the user, and rotate the dial left and right to adjust the direction of the sliding button towards the wireless signal receiver of the TV screen.

---

## Motion Detection

---

In Always Ready mode, the motion sensor activates unnecessarily or fails to activate.

(Depending on model)

» **Is the motion sensor clean?**

The motion sensor is located at the bottom centre of the TV screen and may not function properly if covered with foreign substances. Wipe it clean with a soft cloth.

» **Is the surrounding area too bright or too dark?**

Maintain a suitable brightness level in the area where the product is installed.

» **Is there an object interfering with the motion sensor detection?**

Clear any objects in front of the TV screen.

» **Is the motion sensor too sensitive or insensitive?**

The motion sensor can activate when detecting changes in lighting, movements of pets, robot vacuum cleaners, and other objects as they are recognised as motions.

---

## Noise

---

There is noise coming from the product.

» **Do you hear a "ticking" sound?**

This is the sound of the plastic deforming due to temperature and humidity. It is a common phenomenon in plastic products like furniture and cars; therefore, it is not a cause for concern.

» **Is the noise related to electricity?**

The sound is caused by the high-speed switching circuit that supplies current to the product, and it does not affect the functionality of the product.

» **Do you hear the fan noise from the Zero Connect Box?**

This is a normal sound created to dissipate heat generated inside the product.



\* LG Electronics manages product production with strict standards, and noise below a certain level is not considered a product defect or malfunction.

---

## Magic Remote Control

### The remote control is not working.

#### » Is there a connection problem with the product?

Press and hold the  button and  button in the middle of the Magic remote control simultaneously for more than 5 seconds to re-register.

#### » Are there any objects interfering with the wireless signal transmission?

Clear any objects between the TV screen and the remote control.

#### » Are the batteries inserted correctly?

Ensure that the  side and  side of the battery are in the correct position. Replace both batteries with new ones when they run out.

## Other

If any of the following issues occur, turn off the product, unplug the power plug from the socket and contact the LG Electronics Service Centre for inspection. Do not repair the product yourself.

- If the product fails to display images or produce sound, even when the power is turned on
- If the product continues to display images or produce sound, even when the power is turned off
- If there is smoke or a burning smell coming from the product
- If water or a foreign substance gets into the product
- If the screen image appears to be cut off
- If the product makes repetitive sounds, such as a "buzzing" or "cracking" noise
- If there is any other problem or malfunction with the product

## Product information

<b>Broadcasting Specifications</b> (Depending on country)	Television system	Terrestrial / Cable / Satellites Digital TV
	External antenna impedance	75 Ω
<b>Environment Condition</b>	Operating Temperature	0 °C to 40 °C
	Operating Humidity	Less than 80 %
	Storage Temperature	-20 °C to 60 °C
	Storage Humidity	Less than 85 %
<b>Conditions for Wall Mount Installation</b>	Tilt Angle	0° - 15° (This specification applies only to products with an adjustable wall mount angle.)
<b>Wireless Reception Conditions</b>	Distance	3 - 10 m (Only under conditions with no obstacles)
<b>Power requirement</b>		AC 200-240 V ~ 50/60 Hz

- For information of the power supply and power consumption, refer to the label attached to the product.
  - The typical power consumption is measured in accordance with IEC 62087 or each country's energy regulations.
  - See the label on the bottom of the product for power source, power ratings and product information.
    - \* On some models, the label is inside the external device connection terminal cover.
    - \* Depending on the model or country, the typical power consumption may not be on label.

## Open Source Software Notice Information

To obtain the source code that is contained in this product, under GPL, LGPL, MPL, and other open source licenses that have the obligation to disclose source code, and to access all referred license terms, copyright notices and other relevant documents please visit <https://opensource.lge.com>.

LG Electronics will also provide open source code to you on CD-ROM for a charge covering the cost of performing such distribution (such as the cost of media, shipping, and handling) upon email request to [opensource@lge.com](mailto:opensource@lge.com). This offer is valid to anyone in receipt of this information for a period of three years after our last shipment of this product.















## Licenses

**HDMI™**  
HIGH-DEFINITION MULTIMEDIA INTERFACE









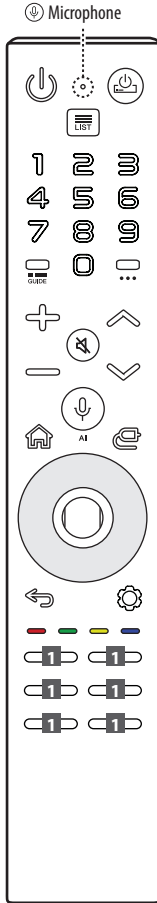





**QUICKSET®**  
(Magic Remote supported models only)

**HEVC Advance™**  
Covered by patents at [patentlist.accessadvance.com](http://patentlist.accessadvance.com)

# Using Magic Remote Control

-  **Power** Turns the TV on or off.
-  Accesses the saved programmes list.
- Number buttons** Enters numbers.
-  Accesses the [Quick Help].
-  Accesses the [Edit Quick Access].
  - [Edit Quick Access] is a feature that allows you to enter a specified app or Live TV directly by pressing and holding the number buttons.
-  Accesses the [Guide].
-  Accesses the saved programmes list.
-  **Volume buttons** Adjusts the volume level.
-  **Mute** Mutes all sounds.
-  **Mute** Accesses the [Accessibility Shortcuts] app.
-  **AI** Network connection is required to use the voice recognition function.
  - Check for recommended content. (Some recommended services may not be available in some countries.)
-  **AI** Speak while pressing and holding the button to use the voice recognition feature.
-  **Home** Accesses the Home menu.
-  **Home** The screen zoom function is activated.
-  **Back** Returns to the previous level.
-  **Back** The screen displayed on the TV is closed and the home menu appears.



-  **STB Power** You can turn your set-top box on or off by adding the set-top box to the universal remote control for your TV.
-  **More Actions** Displays more remote control functions.
-  **More Actions** Audio descriptions function will be enabled.
-  **Programme buttons** Scrolls through the saved programmes.
-  **Input** Changes the input source.
-  **Input** Accesses the [Home Hub].
-  **up/down/left/right** Press the up, down, left or right button to scroll the menu. If you press  button while the pointer is in use, the pointer will disappear from the screen and Magic Remote will operate like a general remote control. To display the pointer on the screen again, shake Magic Remote to the left and right.
-  **Wheel (OK)** Press the centre of  button to select a menu. You can change programmes by using  button.
-  **Q. Settings** Accesses the Quick Settings.
-  **Q. Settings** Displays the All Settings menu.
  - These access special functions in some menus.
-  **Red button** Runs the record function.
-  **Various services button** Connects to various services such as streaming and voice search.



The descriptions in this manual are based on the buttons on the remote control. Please read this manual carefully and use the TV correctly. (Some buttons and services may not be provided depending on models or regions.)

## How to register the Magic Remote Control

To use the Magic Remote, first pair it with your TV.

1. Put batteries into the Magic Remote and turn the TV on.
  2. Point the Magic Remote at your TV and press the  **Wheel (OK)** on the remote control.
- \* If the TV fails to register the Magic Remote, try again after turning the TV off and back on.

## How to deregister the Magic Remote Control

Press the  (**Back**) and  (**Home**) buttons at the same time, for five seconds, to unpair the Magic Remote with your TV.

- \* Press and hold the  (**Home**) and  (**Q. Settings**) buttons for more than 5 seconds to disconnect and re-register the Magic Remote at the same time.









- It is recommended that an Access Point (AP) be located more than 0.2 m away from the TV. If the AP is installed closer than 0.2 m, the Magic remote control may not perform as expected due to frequency interference.

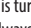

## Using Always Ready

(Depending on model)

You can operate the TV and connect to Bluetooth with direct voice recognition while the power is off.

- \*  →  → [General] → [Always Ready], setting [Enable the function] to on.
- \* Pressing the  button while watching TV switches the screen to [Always Ready] that is turned on, and pressing the  button once more turns the screen to [Always Ready] that is turned off.
- \* Press the  (**Home**) button or the  (**Back**) button to watch TV when the screen is in [Always Ready] that is turned on.
- \* Press the  **Wheel (OK)** button to display the wallpaper when the screen is in [Always Ready] that is turned off, and press the  button to watch TV.

### ✔ Note

- Using Always Ready may increase energy consumption.
- For more information about the feature, refer to the  →  → [Support] → [User Guide] → [Troubleshooting] → [Learn More About Always Ready].

## Connecting Smart Devices using NFC Tagging

NFC is technology that uses Near Field Communication (13.56 MHz), allowing you to conveniently send and receive information without separate settings. By bringing a smart device near the NFC-enabled remote control, you can install the LG ThinQ app and connect the device to the TV.

1. Turn on NFC in the smart device's settings. To use NFC with Android devices, set the NFC option to enable 'read/write tags' in the smart device's settings. The NFC settings may vary depending on the device.
2. Bring the smart device near the  (NFC) on the remote control. The required distance for NFC tagging is about 1 cm.
3. Follow the instructions to install the LG ThinQ app on your smart device.
4. Retagging the smart device to the remote control allows you to conveniently access various features on the connected TV through the LG ThinQ app.

### ✔ Note

- This feature is available for NFC-enabled smart devices only.
- This feature is only available if the remote control has an NFC logo.

# LG SIGNATURE

The model and serial number of the product are located on the back and on one side of the product. Record them below in case you ever need service.

Model \_\_\_\_\_

Serial No. \_\_\_\_\_