



Scan the QR code to see the manual.



OWNER'S MANUAL

AIR PURIFIER



Before beginning installation, read these instructions carefully. This will simplify installation and ensure that the product is installed correctly and safely. Leave these instructions near the product after installation for future reference.

ENGLISH

AS35GGW10, AS35GGW20

TABLE OF CONTENTS

This manual may contain images or content that may be different from the model you purchased.

This manual is subject to revision by the manufacturer.

SAFETY INSTRUCTIONS

READ AND SAVE THESE INSTRUCTIONS	3
WARNING INSTRUCTIONS	3
CAUTION INSTRUCTIONS	7

OPERATION

Product Overviews	9
Preparation before Operation.....	11
Examining Features	14
Operating the Air Purifier	16
Using the Extra Functions	17
Overall Air Quality	19

SMART FUNCTIONS

LG ThinQ Application	20
Smart Diagnosis	21

MAINTENANCE

Maintaining the Product	22
-------------------------------	----

TROUBLESHOOTING

Before Calling for Service.....	27
---------------------------------	----

APPENDIX

Information.....	30
------------------	----

SAFETY INSTRUCTIONS

READ AND SAVE THESE INSTRUCTIONS

The following safety guidelines are intended to prevent unforeseen risks or damage from unsafe or incorrect operation of the appliance. The guidelines are separated into 'WARNING' and 'CAUTION' as described below.

Safety Messages



This symbol is displayed to indicate matters and operations that can cause risk.

Read the part with this symbol carefully and follow the instructions in order to avoid risk.



WARNING

This indicates that failure to follow the instructions can cause serious injury or death.



CAUTION

This indicates that failure to follow the instructions can cause minor injury or damage to the product.

WARNING INSTRUCTIONS



WARNING

- To reduce the risk of explosion, fire, death, electric shock, injury or scalding to persons when using this product, follow basic precautions, including the following:

Technical Safety

- This appliance is not intended for use by persons (including children) with reduced physical, sensory or mental capabilities or lack of experience and knowledge, unless they have been given supervision or instruction concerning use of the appliance by a person

responsible for their safety. Children should be supervised to ensure that they do not play with the appliance.

- The fan is not a toy. It should not be played with or placed where young children can reach it.
- If the supply cord is damaged, it must be replaced by the manufacturer, its service agent or similarly qualified person in order to avoid a hazard.
- Only an authorized repair person should disassemble, repair, or modify the appliance.
- Do not touch the power plug with wet hands.
- Do not place the power cord under rugs, carpeting or mats.
- Do not install and use broken parts.
- Do not continue to use the product if it is visibly damaged.
- The appliance is only to be used with the power supply unit provided with the appliance.
 - Failure to use the supplied power supply may result in reduced performance or failure of the product, and may result in safety hazards.
- The appliance must only be supplied at safety extra low voltage corresponding to the marking on the appliance.
- Be careful not to subject the power plug and adapter to shock.

Installation

- Do not install the appliance on an uneven or inclined surface.
- Do not install the appliance in an area exposed to direct sunlight or near heat-generating equipment.
- Do not install the product in a place where combustible gas may leak or industrial oil or metallic particulates are present.
- Do not allow the appliance to push against the power cord or plug.
- Do not bend the power cable excessively or place a heavy object on top of it.
- Do not extend the length of the power cable or alter it.

- Do not use several devices on a multi-socket extension outlet.
- Make the connection securely so that screw in terminals may not be loosened when the cable is pulled.
- Make sure that the power cable cannot be pulled out or damaged during operation.
- When unplugging the power cord, always pull it by the plug.
- Unplug the appliance during thunder or lightning storms or when not in use for a long time.

Operation

- If the appliance is immersed in water, stop using it and contact an LG Electronics Customer Information Center.
- If there is a gas leakage (isobutane, propane, LNG, etc.), do not touch the appliance or power plug and ventilate the area immediately.
- If you detect any abnormal noise, odor or smoke, unplug the appliance immediately and contact an LG Electronics Customer Information Center.
- Do not clean the appliance with brushes, cloths or sponges which are abrasive or made of metal.
- Do not use or store fire, combustibles (ether, benzene, alcohol, drugs, propane, butane, combustible spray, insecticide, air freshener, cosmetics, etc.) or flammable materials (candles, lamps, etc.) near the product.
- Do not allow animals or pets to chew on the power cord.
- Do not move the appliance when it is in operation.
- Do not hit the appliance.
- Do not insert hands or metal objects into the air inlet or outlet.
- Do not put flammables into the appliance.
- Do not move or operate the appliance while its cover is open.
- Do not allow children to climb on or play with the appliance.
- Do not place anything on top of the appliance.

Maintenance

- Dispose of the packing materials (vinyl, styrofoam, etc.) to keep them out of reach of children.
- Take care not to injure or pinch yourself when you detach and reattach parts of the appliance.
- Turn off and unplug the appliance before cleaning it or replacing the filter.

CAUTION INSTRUCTIONS

CAUTION

- To reduce the risk of minor injury to persons, malfunction, or damage to the product or property when using this product, follow basic precautions, including the following:

Installation

- Do not tilt the appliance to pull or push it when transporting.
- Do not install the appliance in a vehicle, RV, or marine vessel.
- Do not place the appliance near a TV or stereo equipment.
- Do not place the appliance under bright light.
- The appliance must be installed in accordance with national wiring regulations.
- When moving or storing the appliance, wrap the power cord around the base of the appliance to prevent personal injury, damage to the cord or damage to floors.
- Do not place the appliance near curtains.
- Insert the adapter all the way into the adapter connection terminal, and avoid moving it while connected.

Operation

- Do not use the product for removal of toxic gas such as carbon monoxide.
- Do not use the product for ventilation purposes.
- Do not use the appliance for a long time in a region with unstable voltage.
- Do not place obstacles around the air inlet or outlet.
- For safe use of the appliance, children or others with reduced mental capabilities need to be closely monitored by a person who is responsible for their safety.
- Do not use the product for special purposes such as preserving plants, precision instruments, artworks, etc.

- Do not operate the appliance with wet hands.
- Do not let the moisture from a humidifier directly touch the appliance.
- Do not use the appliance while it is not in an upright position.
- Do not use the appliance near objects vulnerable to heat.
- Do not use detergents, cosmetics, chemicals, air fresheners, or disinfectants in the appliance.
- Do not touch any internal parts while the unit is operating or immediately after operation.
- Use the filter only for its intended purpose.
- The Deodorization filter and Safe Plus filter are assembled together. Do not try to detach them from each other.
- Do not insert any objects in the air outlet.

Maintenance

- Do not use strong detergents or solvents to clean the appliance. Use a soft cloth to clean.
- Do not clean the appliance with an alkaline detergent.
- Do not wipe the appliance surface using sulfuric acid, hydrochloric acid or organic solvents (thinner, kerosene etc.) or attach a sticker on the appliance.
- Do not allow water inside the appliance.
- Do not wash the filter with water.
- Be careful not to damage the pre-filter when cleaning it with a vacuum cleaner.

OPERATION

- The exterior or components of the product may vary depending on the model.

Product Overviews

Air Purifier

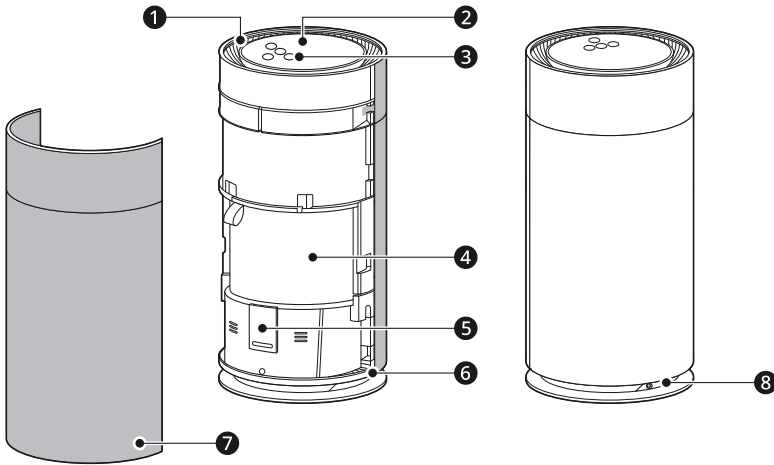

1 Air Outlet

- Purified air from the filter is emitted.

2 Status Panel

- Use it to check the settings of the appliance and the air quality.

3 Control Panel

- Use it to set the appliance functions.

4 Filter

- It eliminates fine particles, smog causing materials, sickening house syndrome materials, and domestic odor.

5 PM1.0 Sensor

- It detects the level of the concentration of particulate matter (PM).

6 Handle

- Use it to carry and move the product.

7 Air Inlet (Cover)

- Air is sucked into the air purifier through the air inlet.
- Allows you to disassemble the front and the rear covers separately.

8 Adapter Connection Terminal

- The adapter can be separated.

Filter

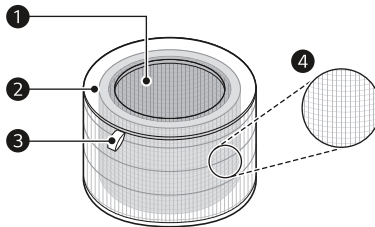

1 Deodorization Filter

- Minimizes smog causing materials (SO₂, NO₂), sickening house syndrome materials (toluene, formaldehyde), domestic odor, and sulphur compounds.

2 Safe Plus Filter

- Minimizes PM1.0, allergen materials, bacterial and viral from the air.

3 Filter Handle

- Allows you to separate the filter from the product.

4 Pre-Filter

- Minimizes large particles floating in the air.

CAUTION

- Do not forcefully separate the filters, as the filters are attached.
 - Do not throw the filters or use them for other purposes.
-

Components



1

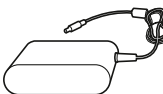

2

1 Quick Guide

2 Adapter

Preparation before Operation

Removing the Protective Vinyl from the Filter

Unpack the appliance and remove all packing tape and filter vinyl before using the appliance.

- 1 Take the product out of the box, and remove the vinyl or the fixing tape attached to the product.
- 2 Hold the top end of the front cover of the product with the **LG logo** and pull it slightly to achieve separation.

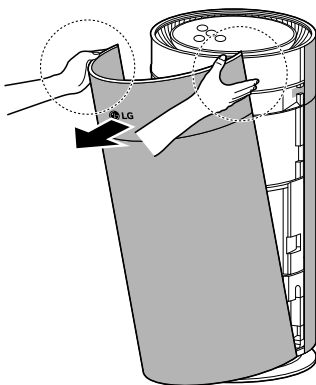

- 3 Remove the filter and detach the vinyl.

- When removing the packaged filter, separate it from the protective vinyl.

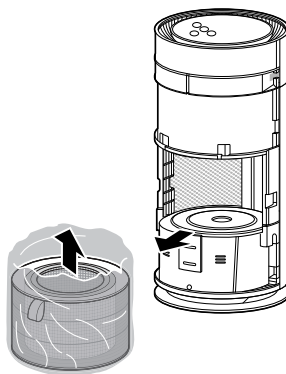

- 4 Install the filter into the product.

- Make sure that the side with the filter handle (1) is facing upward.

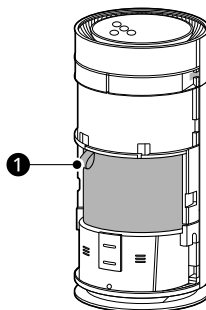

12 OPERATION

- 5** To install the cover again, insert the fixing part at the bottom of the cover into the fixed groove at the bottom of the product and then close it.

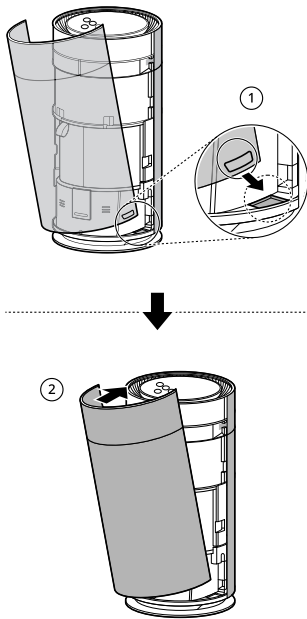

⚠ CAUTION

- Be sure to remove the protective vinyl from the filter before using the product.
- Pay attention to filter direction when installing it. Failure to do so may cause product malfunction and failure.

Installation Location Requirements

Install the product at least 1 m from walls.

- If there is not enough room for air suction, the air purification performance may degrade.

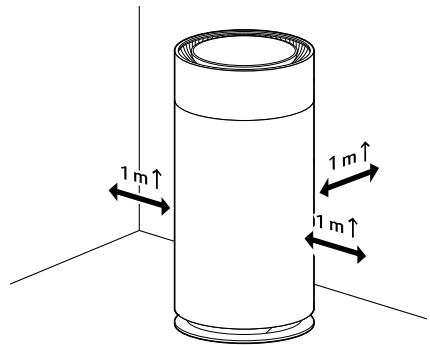

- The performance of the appliance may vary depending on the service environment (temperature, humidity, etc.).
 - The appliance can provide the guaranteed performance in an environment with humidity ranging between 40 % and 70 %.
- Do not install the product in a place exposed to direct sunlight or near lighting fixtures with strong light.
 - This may cause product discoloration.

Transportation Requirements

- When moving or storing the product, separate the plug from the outlet and then separate the adapter so that it will not drag across the floor.
 - Failure to do so may damage the adapter or scratch the floor.

- Transport the product safely by holding the handle(❶) at the bottom of the product with both hands.

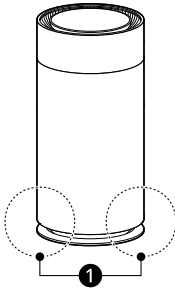

- 2 Plug the power plug of the adapter into the outlet.

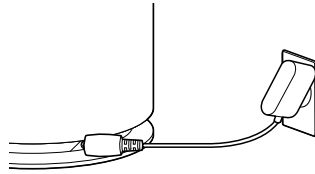

NOTE

- Hold the product and connect or disconnect the adapter horizontally.
- Connect the adapter to the end, and do not move it after it is connected. (Doing so may result in damage.)
- Be careful not to apply impact to the adapter. Failure to do so may result in damage.

⚠ CAUTION

- Do not carry the product by holding the external cover.
- Doing so may allow the cover to open and the product to drop. Dropping the appliance may cause personal injury or product malfunction.

Connecting the Power

- 1 Connect the adapter to the adapter connection terminal on the back of the product.

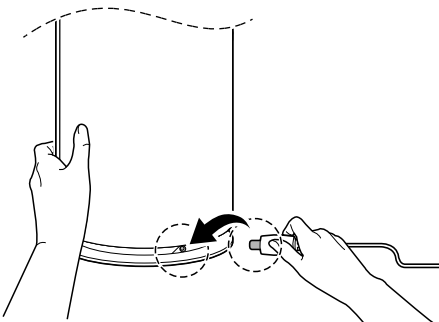

Examining Features

Controlling the Air Purifier

- **Pet** mode is only available on models that have this feature.

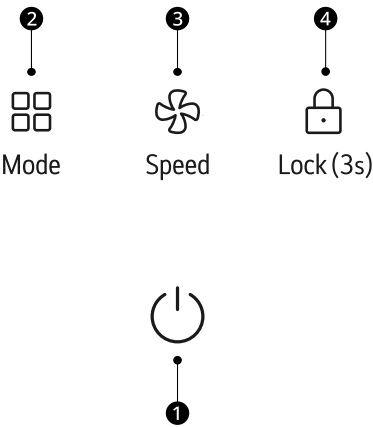

Control Panel



- 1 Start/Stop Button**
Turns the product on and off.
 - To prepare the product to connect to Wi-Fi through the **LG ThinQ** application, press and hold the button for 3 seconds or more.
- 2 Mode Button**
Use it to set the mode.
- 3 Speed Button**
Use it to adjust the fan speed of the air purifier.
- 4 Lock Button**
You can lock or unlock the control panel by pressing and holding the button for 3 seconds.

NOTE

- You can use additional functions by pressing the buttons on the control panel for 3 seconds.

Long press (more than 3 seconds)	Extra Functions
 + 	Filter Status Notification Reset

Status Panel

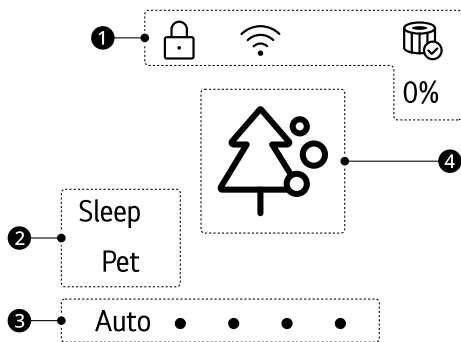

1 Add-on Display

Icon	Description
	Lights up when the lock function is set.
	Lights up when the Wi-Fi function is activated.
	The color indicates the life of the filter. For detailed information, refer to Replacing the Filters .

2 Display operating mode

It indicates the mode that is operating currently.

3 Display speed

Displays the air purifier's fan speed.

Speed	Display	Description
Auto	Auto ● ● ● ●	LED changes according to the overall air quality.
Low	●	1 LED ON
Middle	● ●	2 LED ON
High	● ● ●	3 LED ON
Turbo	● ● ● ●	4 LED ON

4 Overall Air Quality (Color)

The overall air quality is indicated by color. → See **Overall Air Quality** for detailed color information.

Operating the Air Purifier

Start/Stop

Press the **Start/Stop** button to turn on or off the air purifier.

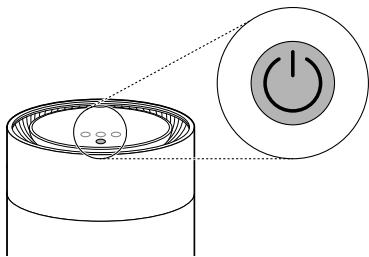

NOTE

- When the operation is started for the first time, the appliance operates in **Purify** mode.
- The most recently used mode is memorized if the power supply is cut off as a result of a power failure.
- When the operation begins, the Overall Air Quality will take around 30 seconds to display on Status Panel.

Operation Mode

Each time you press the **Mode** button, the mode changes in the following order

: **Purify** → **Sleep** → **Pet**.

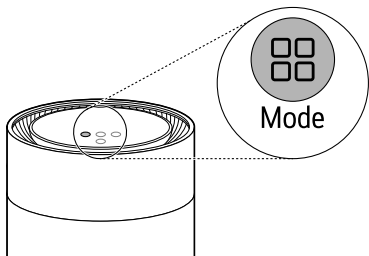

Using Purify Mode

The air purifier purifies indoor air.
Press the **Mode** button to choose the **Purify** mode.

- Each time you press the button, the operating mode changes in the following order: **Purify** → **Sleep** → **Pet**.

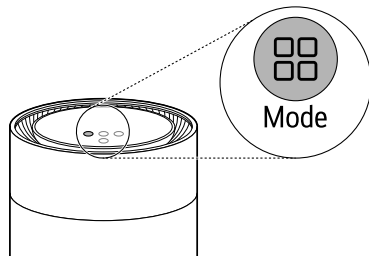

NOTE

- **Purify** mode is not displayed on the status panel.

Using Sleep Mode

You can use the air purifier in a quiet environment when you go to sleep.

Press the **Mode** button to choose **Sleep** mode.

- Each time you press the button, the operating mode changes in the following order: **Purify** → **Sleep** → **Pet**.

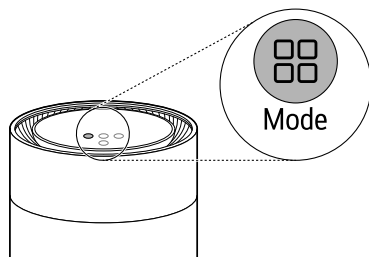

NOTE

- The whole display is turned off except for the display of **Sleep** mode.

- You cannot set the operation time in **Sleep** mode separately. To cancel the **Sleep** mode, press the **Mode** button in the same way as in setting it.

Using Pet Mode

(Only for models with **Pet** mode)

This is a dedicated mode for pet owners. This mode effectively inhales pet hair/dust by automatically adjusting speed and air flow according to overall air quality.

Press the **Mode** button to choose **Pet** mode.

- Each time you press the button, the operating mode changes in the following order: **Purify** → **Sleep** → **Pet**.

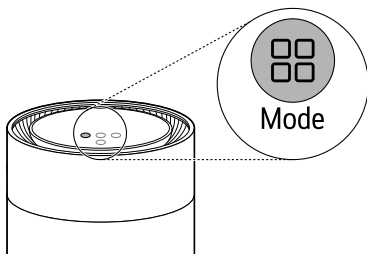

NOTE

- When the product operates in **Pet** mode, turbo will be set for 30 minutes, and after 30 minutes have passed, the fan speed will be set automatically according to the air quality.
- Fan speed can be adjusted by pressing the **Speed** button while **Pet** mode is activated.
 - Each time you press the **Speed** button, the speed changes in the following order: **Auto** → **Middle** → **High** → **Turbo**.

Adjusting the Fan Speed

You can adjust the fan speed from the air purifier.

- Press the **Start/Stop** button to turn on the product.

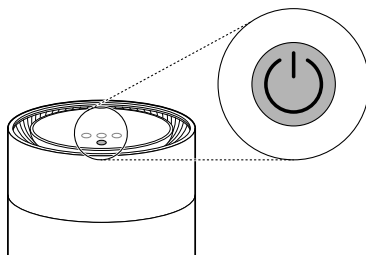

- To adjust the fan speed, press the **Speed** button.
 - When you press the button during product operation, the fan speed changes in the order of **Auto** → **Low** → **Middle** → **High** → **Turbo**.

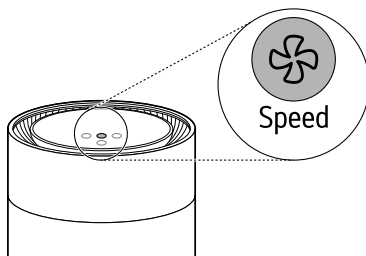

NOTE

- When the operation is started for the first time, it will operate with **Auto** as the fan speed. The **Auto** adjusts automatically the speed according to the air quality level of the indoor air.

Using the Extra Functions

Locking the Control Panel

You can lock the buttons on the control panel to prevent the appliance from operating due to unforeseen reasons, such as a child manipulating the buttons.

18 OPERATION

Press the **Lock** button for 3 seconds or longer during operation.

- The lock icon is displayed on the status panel when the lock function is set.

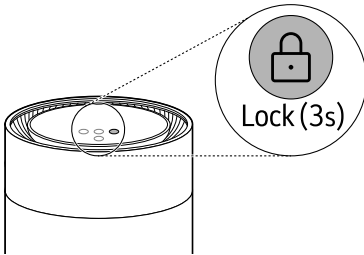

NOTE

- You can turn off the lock function in the same way as turning it on.
 - You can also lock or unlock when the operation has stopped.
-

Overall Air Quality

Understanding Overall Air Quality

The overall air quality is calculated based on the concentration of particulates and is categorized in 4 levels based on the level of pollution in the air. (Green, Yellow, Orange, and Red)

Color	Overall air quality	Concentration of PM (μg/m ³)		
	State	PM10	PM2.5	PM1.0
Red	Poor	255 or more	56 or more	56 or more
Orange	Unhealthy	155 ~ 254	36 ~ 55	36 ~ 55
Yellow	Moderate	55 ~ 154	13 ~ 35	13 ~ 35
Green	Good	54 or less	12 or less	12 or less

NOTE

- Overall air quality can be seen by the color of the air quality indicator.
- The color of the overall air quality indicator is determined based on the concentration of particulate matter (PM).
- PM concentration values are based on the data sheet provided by the sensor manufacturer.
- The PM concentration measurement was tested using LG Electronics' standard test materials.

SMART FUNCTIONS

LG ThinQ Application

The **LG ThinQ** application allows you to communicate with the appliance using a smartphone.

LG ThinQ Application Features

Smart Diagnosis

If you experience a problem while using the appliance, this **Smart Diagnosis** feature will help you diagnose the problem.

Settings

Allows you to set various options on the appliance and in the application.

NOTE

- In the following cases, you must update the network information for each appliance in the **LG ThinQ** application under **Device Cards** → **Settings** → **Change Network**.
 - wireless router is changed
 - wireless router password is changed
 - Internet service provider is changed
- The application is subject to change for appliance improvement purposes without notice to users.
- Functions may vary by model.

Before Using LG ThinQ Application

This feature is only available on models with Wi-Fi function.

- 1 Check the distance between the appliance and the wireless router (Wi-Fi network).
 - If the distance between the appliance and the wireless router is too far, the signal strength becomes weak. It may take a long time to connect or installation may fail.

- 2 Turn off the Mobile data or Cellular Data on your smartphone.

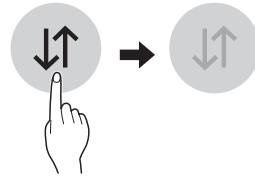

- 3 Connect your smartphone to the wireless router.

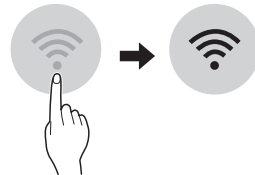

NOTE

- To verify the Wi-Fi connection, check that the Wi-Fi  icon on the status panel is lit.
- **The appliance supports 2.4 GHz Wi-Fi networks only.** To check your network frequency, contact your Internet service provider or refer to your wireless router manual.
- **LG ThinQ** is not responsible for any network connection problems or any faults, malfunctions, or errors caused by network connection.
- If the appliance is having trouble connecting to the Wi-Fi network, it may be too far from the router. Purchase a Wi-Fi repeater (range extender) to improve the Wi-Fi signal strength.
- The Wi-Fi connection may not connect or may be interrupted because of the home network environment.
- The network connection may not work properly depending on the Internet service provider.
- The surrounding wireless environment can make the wireless network service run slowly.
- If the appliance cannot be connected due to problems with the wireless signal transmission,

unplug the appliance and wait about a minute before trying it again.

- If the firewall on your wireless router is enabled, disable the firewall or add an exception to it.
- The wireless network name (SSID) should be a combination of English letters and numbers. (Do not use special characters.)
- Smartphone user interface (UI) may vary depending on the mobile operating system (OS) and the manufacturer.
- If the security protocol of the router is set to WEP, the network setup may fail. Change the security protocol (WPA2 is recommended) and connect the product again.

source code, and to access all referred license terms, copyright notices and other relevant documents, please visit [https://
opensource.lge.com](https://opensource.lge.com).
LG Electronics will also provide open source code to you on CD-ROM for a charge covering the cost of performing such distribution (such as the cost of media, shipping, and handling) upon email request to opensource@lge.com.
This offer is valid to anyone in receipt of this information for a period of three years after our last shipment of this product.

Smart Diagnosis

Use this feature to help you diagnose and solve problems with your appliance.

NOTE

- For reasons not attributable to LGE’s negligence, the service may not operate due to external factors such as, but not limited to, Wi-Fi unavailability, Wi-Fi disconnection, local app store policy, or app unavailability.
- The feature may be subject to change without prior notice and may have a different form depending on where you are located.

Using LG ThinQ to Diagnose Issues

If you experience a problem with your Wi-Fi equipped appliance, it can transmit troubleshooting data to a smartphone using the **LG ThinQ** application.

- Launch the **LG ThinQ** application and select the **Smart Diagnosis** feature in the menu. Follow the instructions provided in the **LG ThinQ** application.

Installing the LG ThinQ Application

Search for the **LG ThinQ** application from the Google Play Store or Apple App Store on a smartphone. Follow instructions to download and install the application.

Radio Equipment Specifications

Model	LCWB-001	
Wi-Fi	Frequency Range	2412 MHz - 2472 MHz
	Output Power(Max)	18.14 dBm
Bluetooth	Frequency Range	2402 MHz - 2480 MHz
	Output Power(Max)	7.03 dBm

Open Source Software Notice Information

To obtain the source code that is contained in this product, under GPL, LGPL, MPL, and other open source licenses that have the obligation to disclose

MAINTENANCE

Maintaining the Product

Scheduled Maintenance

⚠ WARNING

- Be sure to stop the appliance operation and remove the power plug from the outlet before cleaning and replacing the filter.
- Do not spray water directly on the appliance.

Component	Cleaning frequency	Replacement frequency
 Filter	Pre-Filter Clean filter as needed	1 year

NOTE

- The cleaning frequency may vary depending on the operating hours and environment of the appliance.
- If you do not clean the product according to the cleaning frequency, you may experience a bad odor and poor performance.
- The filter must be replaced at the end of its lifespan, and the cost of replacement filters is not covered under the warranty. To purchase new filters, contact an LG Electronics Customer Information Center or visit the website at www.lg.com
- If the overall air quality does not change on the display for a long time, clean the PM1.0 sensor even if it is not scheduled for a cleaning.

- 2 Wipe the air outlet and the exterior of the product with a soft cloth.

⚠ CAUTION

- Do not wipe the appliance with an alkaline detergent.
- Never use sulphuric acid, hydrochloric acid or organic solvent (e.g., thinner, kerosene and acetone) to wipe the appliance exterior, or affix labels on the exterior. Doing so may damage the product surface.
- Care should be exercised to prevent flowing of water into the product.

NOTE

- If dust on the front and rear covers cannot be removed, disassemble the covers and clean them with water. After cleaning, dry the covers thoroughly in the shade.

Cleaning the Particles Sensor

The PM1.0 sensor is the device detecting fine dust and large dust contamination levels, so it is recommended to clean the lens periodically, at least once every 2 months.

Cleaning the Exterior

- 1 Remove any dust from the air inlet and outlet using a vacuum cleaner.

- 1 Hold the top end of the front cover of the product with the **LG** logo and pull it slightly to achieve separation.

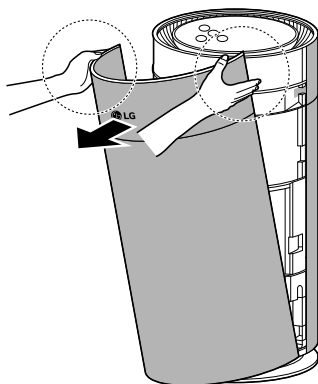

- 2 Push the sensor cover up.

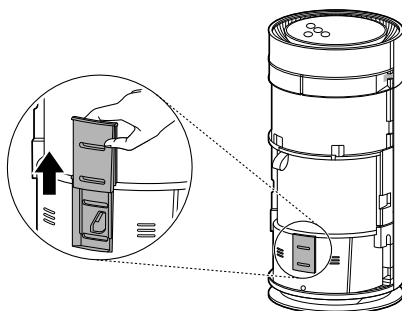

- 3 Clean the lens with a cotton swab soaked with water and clean it again with a dry cotton swab.

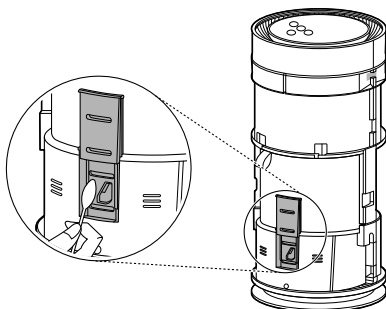

- 4 Close the sensor cover.

NOTE

- Do not wipe the sensor with any substances other than water. It may cause a appliance to malfunction.
- When opening or closing the sensor cover, a sound may be heard as a result of friction.

Cleaning the Filters

- 1 Separate the front and rear covers from the product.

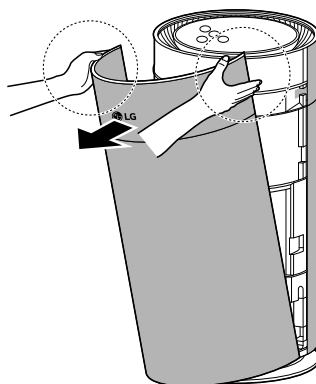

- 2** Using a vacuum cleaner or soft brush, remove any dust from the pre-filter surrounding the filter.

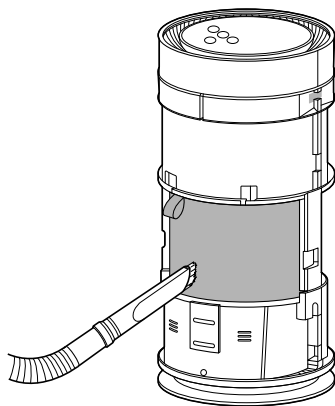

! CAUTION

- Do not clean the filter with water. The service life of the filter may be reduced.
 - Be careful not to damage the pre-filter when using a vacuum cleaner.
 - Take caution because there is a risk of tearing or loss when separating or assembling the pre-filter.
 - Be careful as the filter may be damaged if it is covered with liquid.
-

Replacing the Filters

Checking Filter Status Notification

: Filter Status Notification

Color	Green	Orange	Red
Status	The filter has been installed.	Prepare for filter replacement.	Replace the filter.

NOTE

- Filter Status Notification appears based on the maximum usage time, taking into account the operating hours of the product. Replacement frequency is determined by the operating hours and the environment.
- Once you have replaced the filter, reset the Filter Status Notification.
 - The Filter Status Notification can be reset through the additional Filter Status Notification reset function.
- When the Filter Status Notification is displayed in red, a 0% icon is also displayed.

- Filter Status Notification on the status panel is reset and the time for Filter Status Notification is initialized.

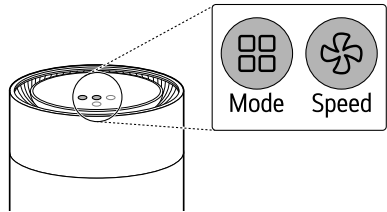

NOTE

- Use when replacing with a new filter.

Replacing the Pre-Filter

Check the Velcro of the pre-filter and replace the pre-filter by separating it slowly.

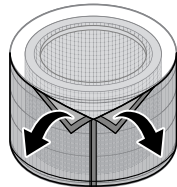

Replacing the Filters

- Separate the cover from the product and replace the filter.
 - To avoid polluting the surroundings when replacing the filter, place a newspaper on the floor before you remove the filter.
- Once you have replaced the filter, disable the Filter Status Notification.
 - When the Filter Status Notification is reset, the color of the Filter Status Notification changes to green.

Reset the Filter Status Notification

Press and hold the **Mode** and **Speed** buttons on the control panel for 3 seconds.

Storage

- If the appliance is not used for a long period of time, store it at a shaded and dry place.
- Operate the product for one hour or more on a fine day.
 - This removes moisture and prevents molds from building-up inside the product.
 - Turn off the product, separate the plug from the outlet, and then separate the adapter.
 - Separate the adapter from the product and store it.
 - Package the appliance to prevent the dust or foreign substance from entering the appliance.

Store the packaged appliance at a shaded place.

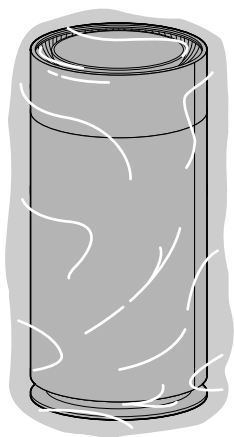

⚠ CAUTION

- Do not store the appliance at a humid place or at a place exposed to the direct sunlight.

Otherwise the appliance may be deformed, malfunction or generate odor.

TROUBLESHOOTING

Before Calling for Service

Please check the following before calling for service. If the problem persists, contact your local service center.

Operation

ENGLISH

Symptoms	Possible Cause & Solution
The product does not power on.	Is the power plug disconnected? <ul style="list-style-type: none">Connect it to an outlet correctly.
	Did the electricity get cut off? <ul style="list-style-type: none">Check the power to other products in the house.
A noise occurs and the fan speed is low.	Has dust accumulated in the pre-filter? <ul style="list-style-type: none">Clean the pre-filter.
	Has dust accumulated in the filter? <ul style="list-style-type: none">Replace the filter.
Air purification is not done properly.	Is the indoor pollution severe? <ul style="list-style-type: none">Ventilate indoors before using the product.
	Has dust accumulated in the pre-filter? <ul style="list-style-type: none">Clean the pre-filter.
	Has dust accumulated in the filter? <ul style="list-style-type: none">Replace the filter.
	Are you using it in a place that is too spacious or too open? <ul style="list-style-type: none">Use a product that suits the size of the room.Avoid well-ventilated places such as doors, windows, etc.
	Is there an obstacle nearby? <ul style="list-style-type: none">Remove any nearby obstacles before operating the product.
	Is the product installed in a corner? <ul style="list-style-type: none">Move the product and reinstall it.
The overall air quality stays red.	Move the appliance to a different room and see if the color changes. <ul style="list-style-type: none">Clean the PM1.0 sensor.Remove the power plug from the outlet and reconnect it one minute later.
	A substance was sprayed near the product. <ul style="list-style-type: none">Do not use sprays near the product.

Symptoms	Possible Cause & Solution
The buttons on the control panel do not work.	Is the lock icon displayed on the status panel? <ul style="list-style-type: none">Press and hold the Lock button for 3 seconds to disable the lock function.
The color of the filter status notification does not change to green.	Is the color of the filter status notification orange or red? <ul style="list-style-type: none">The filter status notification can be reset through the additional filter status notification reset function.<ul style="list-style-type: none">Press and hold the Mode and Speed buttons on the control panel for 3 seconds.

Odor

Symptoms	Possible Cause & Solution
A strange odor comes out from the air outlet as well as the filter.	Appliance is new. <ul style="list-style-type: none">The odor of activated charcoal is not harmful. This is similar to the odor you may experience in a brand new car. The odor should dissipate after 1-2 weeks of use.
	The appliance is located in an area with a lot of smoke or odors. <ul style="list-style-type: none">In areas with a lot of smoke or odors, the lifespan of the filters may be greatly decreased. For best results, ventilate the room first, then use the appliance.
	The odor is coming from the filter. <ul style="list-style-type: none">Replace the filter. The filter replacement frequency may differ depending on the usage environment.
	The appliance is located in an area with a lot of strong odors. <ul style="list-style-type: none">If the appliance is used near where you cook or broil fish or meat, the lifespan of the filters will be greatly decreased.For best results, ventilate the area first by opening a window or using a vent hood. Use the appliance only to minimize odors left after ventilating the area.

LG ThinQ

Symptoms	Possible Cause & Solution
The product and the smartphone cannot be connected through Wi-Fi.	Is the Wi-Fi password used to connect to the smartphone correct? <ul style="list-style-type: none">Press the Settings button on your smartphone, and then find your Wi-Fi in the network list. Press and hold the button to select [Clear Network], and then proceed with product registration again from the beginning.

Symptoms	Possible Cause & Solution
<p>The product and the smartphone cannot be connected through Wi-Fi.</p>	<p>Is your smartphone using mobile data rather than Wi-Fi?</p> <ul style="list-style-type: none"> In the smartphone's settings, turn off Mobile Data, turn on Wi-Fi, and then register the product.
	<p>Does the name (ID) of the wireless router contain special characters?</p> <ul style="list-style-type: none"> Set the name (ID) of the wireless router as a combination of numbers and English letters. Wi-Fi connection may be difficult if you enter special characters.
	<p>Is the frequency of the wireless router not 2,4 GHz?</p> <ul style="list-style-type: none"> When connecting the product via Wi-Fi, only a 2,4 GHz network can be used. Set the wireless router to 2,4 GHz and then connect. To check the frequency of your wireless router, contact your Internet carrier or router manufacturer.
	<p>Are the product and the wireless router too far apart?</p> <ul style="list-style-type: none"> If the distance between the product and the wireless router is too great, the wireless signal may be weak, and the connection may not be smooth. Move the wireless router closer to the product.

APPENDIX

Information

APPLIANCE SPECIFICATIONS

- Appearance and specifications may vary without notice to improve the quality of the appliance.

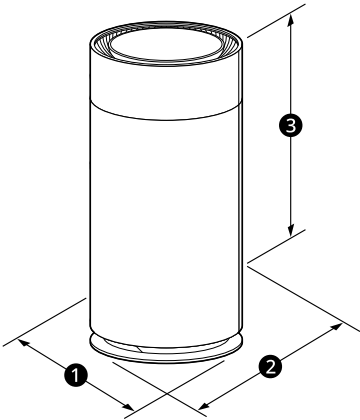

Name	AS35GGW10, AS35GGW20
Power	DC 24 V
Exterior Dimensions (1 x 2 x 3)	240 mm x 240 mm x 500 mm

AC/DC Adapter	
Manufacturer	FOSHAN SHUNDE GUANYUDA POWER SUPPLY CO.,LTD.
Model	GM51-240200-2A
Rated Input	AC 100 V - 240 V ~, 50/60 Hz
Rated Output	DC 24 V, 2.0 A, 48 W



掃描 QR 碼查看說明書。



使用者手冊

空氣清新機



開始安裝前，請仔細閱讀這些操作指引。這將簡化安裝過程，保證產品正確並且安全安裝。將這些操作指引放置在產品旁，以便以後參考。

粵語

AS35GGW10，AS35GGW20

www.lg.com

Copyright © 2017-2025 LG Electronics. All Rights Reserved

目錄

此手冊可能包含與您購買的型號不同的影像或內容。
此手冊以製造商的修訂版本為準。

安全說明

細讀並保存這些說明	3
警告事項	3
注意說明	6

操作

產品概覽	8
操作前準備工作	10
檢查功能	12
操作空氣清新機	14
使用額外功能	15
整體空氣品質	16

智能系統

LG ThinQ 應用程式	17
Smart Diagnosis（智能診斷）	18

維護

維護產品	19
------------	----

疑難排解

在致電尋求服務之前	23
-----------------	----

附錄

資訊	26
----------	----

安全說明

細讀並保存這些說明

下列安全指引是為防止無法預見的危險或由於不安全或不正確的電器操作方式造成的損失。

如下所述，指引分為「警告」和「注意」兩部份。

安全訊息



顯示該符號表示這些情況和操作可能造成危險。
請仔細閱讀標有此符號的內容，並遵循說明以避免發生危險。



警告

表示不遵循操作指引會造成重傷或死亡。



注意

表示不遵循操作指引會造成輕傷或產品損壞。

警告事項



警告

- 在使用產品時，為減少給人體帶來爆炸、火災、死亡、觸電、傷害或燙傷的危險，應遵循基本的安全預防措施，包括以下內容：

技術安全

- 身體、感知或心智能力較弱者或缺乏經驗及知識的人群（包括兒童）不宜使用該電器，除非有負責其安全的人員給予有關使用電器的監督或指引。應監督兒童，避免其把玩該電器。
- 風扇不是玩具。不應讓兒童把玩風扇，也不應將風扇放在兒童可以觸及的地方。
- 若電源線損壞，必須由製造商或其服務代理商或類似合格人員進行更換，以避免發生危害。
- 只有經授權的維修人員才能拆卸、維修或改裝電器。
- 請勿用濕手觸摸電源插頭。
- 請勿將電源線放在墊毯、地毯或墊子下面。

- 請勿安裝和使用破損的零件。
- 如果產品明顯受損，請勿繼續使用該產品。
- 本電器僅可用於其隨附的電源供應器。
 - 未使用隨附的電源供應器可能導致產品效能下降或故障，並可能導致安全隱患。
- 電器只得以電器上的標記對應的安全超低電壓進行供電。
- 注意不要讓電源插頭和適配器遭受撞擊。

安裝

- 請勿將電器安裝在不平坦或傾斜的表面。
- 請勿將電器安裝在陽光直射或靠近發熱設備的區域。
- 請勿將產品安裝在可能洩漏易燃氣體或存放有工業油或金屬顆粒物的地方。
- 請勿讓電器推擠電源線或插頭。
- 請勿過度彎曲電源線或在其上放置重物。
- 請勿延長或更改電源線的長度。
- 請勿在多孔延展插座上使用多個設備。
- 建立穩妥的連接，使端子中的螺絲不會在拉扯電源線時出現鬆動。
- 確保在操作期間無法拉出或損壞電源線。
- 若要拔掉電源線，請始終握住插頭將其拉出。
- 遭遇打雷或閃電，或長期不使用本產品時，請將電器的電源插頭拔下。

操作

- 如果電器被浸入水中，請停止使用並聯絡 LG Electronics 客戶資訊中心。
- 若有漏氣（異丁烷、丙烷與天然氣等）現象，請勿碰觸本產品或電源插頭，並立即讓該區域通風。
- 如果您發現有任何異常噪音、異味或煙霧，請立即拔下本產品的插頭，並聯絡 LG Electronics 客戶資訊中心。
- 請勿使用研磨性或金屬制成的刷子、布條或海綿清潔電器。

- 請勿在本產品附近使用或放置明火、可燃物（乙醚、苯、乙醇、藥物、丙烷、丁烷、可燃噴霧劑、殺蟲劑、空氣清新劑、化妝品等）或易燃物質（蠟燭、燈具等）。
- 請勿讓動物或寵物咀嚼電源線。
- 電器運作期間請勿移動。
- 請勿撞擊電器。
- 請勿將手或金屬物品插入進氣口或出氣口。
- 請勿在電器中放置易燃物。
- 請勿在機蓋打開時移動或操作電器。
- 請勿讓兒童攀爬或把玩電器。
- 請勿在電器頂部放置任何物品。

維護

- 處理包裝材料（乙烯基、泡沫聚苯乙烯等），使兒童無法接觸到它們。
- 在拆下並重新安裝電器部件時，注意不要傷害或夾傷自己。
- 清潔電器或更換濾網之前，請將電器關機並拔下插頭。

注意說明

注意

- 為了在使用本產品時減少人員的輕微受傷、產品故障或損壞或財產風險，請遵循以下基本預防措施，包括：
-

安裝

- 運送時請勿為了拉動或推動電器而去傾斜它。
- 請勿在車輛、房車或船舶上安裝本電器。
- 請勿將電器放置在電視機或立體聲設備附近。
- 請勿將電器放置在強光下。
- 必須根據國家接線規範來安裝電器。
- 移動或存放電器時，請將電源線纏繞至電器底座上，以防止人身傷害、電源線損壞或地板損壞。
- 請勿將本電器放在窗簾附近。
- 將適配器一直插入適配器連接端子，並避免在連接期間移動它。

操作

- 請勿用本產品清除有毒氣體，例如一氧化碳。
- 請勿將本產品用於通風目的。
- 請勿在電壓不穩定的區域長時間使用本電器。
- 請勿將障礙物放置在進氣口或排氣孔附近。
- 為安全起見，兒童或心智能力較弱者使用本電器時需要由負責其安全的人員密切監督。
- 請勿將產品用於特殊用途，例如保存植物、精密儀器、藝術品等。
- 請勿用濕手操作電器。
- 請勿讓加濕器中的水分直接接觸電器。
- 請勿在未直立放置的狀態下使用電器。
- 請勿在易因熱受損的物體附近使用電器。
- 請勿在電器中使用洗滌劑、化妝品、化學品、空氣清新劑或消毒劑。
- 在電器運行時或運行剛結束時，請勿觸摸任何內部零件。

- 請僅將濾網用於其預期用途。
- 除臭過濾器和 Safe+ 濾網被組裝在一起。請勿試圖將它們彼此分離。
- 請勿將任何物件插入出氣孔。

維護

- 請勿使用洗滌劑或溶劑來清潔產品。使用軟布來清潔。
- 請勿用鹼性清潔劑清洗電器。
- 請勿用硫酸、鹽酸或有機溶劑（稀釋劑、煤油等）擦拭電器表面，或在電器上貼標籤。
- 不要讓水進入電器內。
- 請勿用水清洗濾網。
- 請注意在使用真空吸塵機清潔時不要損壞前置濾網。

操作

- 產品的外觀或組件可能會因型號而異。

產品概覽

空氣清新機

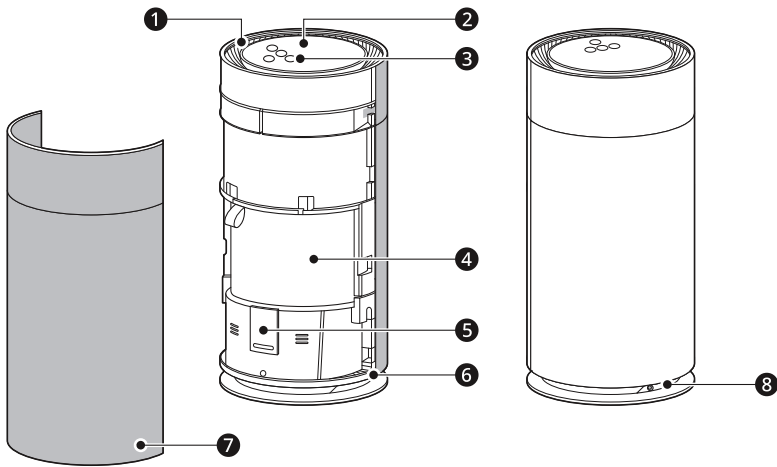

❶ 排氣孔

- 淨化空氣從濾網排出。

❷ 狀態面板

- 用於查看電器設定和空氣質量。

❸ 控制面板

- 用於設定電器功能。

❹ 濾網

- 用於消除細顆粒物、引起煙霧的物質、令人不適的家居綜合症物質和家居異味。

❺ PM1.0 感測器

- 可檢測顆粒物 (PM) 濃度。

❻ 手柄

- 用於搬運產品。

❼ 進氣口（蓋）

- 空氣清新機透過進氣口吸入空氣。
- 允許拆分前蓋和後蓋。

❽ 適配器連接端子

- 適配器是可以分開的。

濾網

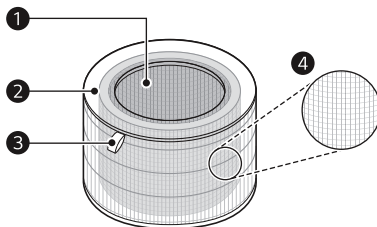

❶ 除臭濾網

- 最大限度減少引起煙霧的物質（ SO_2 、 NO_2 ）、令人不適的家居綜合症物質（甲苯、甲醛）、家居異味和硫化化合物。

❷ Safe+ 濾網

- 最大限度減少空氣中的 PM1.0、過敏原物質、細菌和病毒。

❸ 濾網手柄

- 用於將過濾器與產品分開。

❹ 前置濾網

- 最大限度減少空氣中懸浮的大顆粒物。

⚠ 注意

- 請勿強行分離濾網，因為濾網處於連接狀態。
- 請勿丟棄濾網或將其用於其他目的。

組件



❶

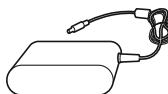

❷

❶ 快速指南

❷ 適配器

操作前準備工作

從濾網撕下保護乙烯基塑料

打開電器包裝，撕下所有包裝膠帶和濾網乙烯基塑料，然後使用電器。

- 1 從包裝箱中取出產品，然後撕下貼在產品上的乙烯基或固定膠帶。
- 2 握住帶 **LG** 標誌的產品前蓋頂端，輕輕拉動分開。

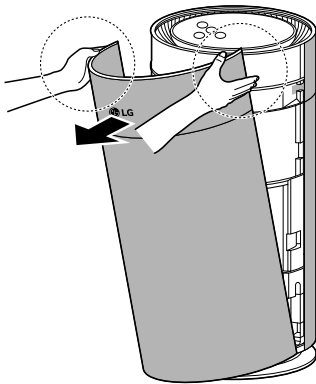

- 3 取出濾網並撕下乙烯基。
 - 取出包裝好的濾網時，請將其與保護乙烯基分離。

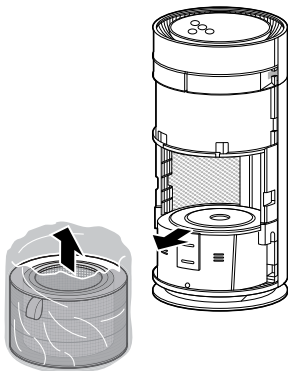

- 4 將濾網安裝到產品中。
 - 確保有濾網手柄 (❶) 的一面朝上。

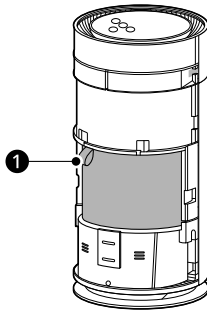

- 5 若要再次安裝蓋子，請將蓋子底部的固定槽插入到產品底部的固定部分中，然後合上蓋子。

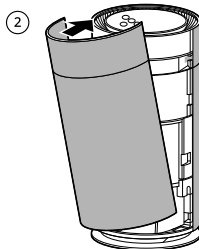
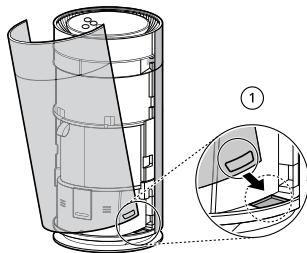

⚠ 注意

- 使用本產品前，請務必撕下濾網上的保護乙烯基。
- 安裝時要注意過濾器的方向。否則可能導致產品故障和失靈。

安裝位置要求

產品安裝時應距離牆壁至少 1m。

- 若空氣吸入空間不夠，則空氣淨化性能可能會下降。

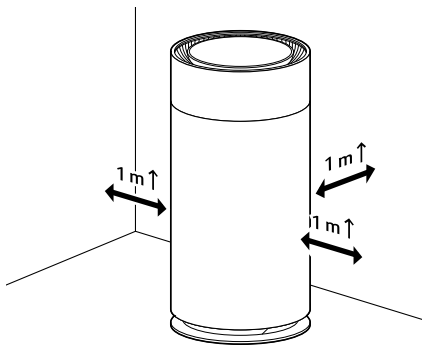

- 電器性能可能根據使用環境（溫度、濕度等）而不同。
 - 電器在濕度介於 40 % 至 70 % 的環境中提供有保證的性能。
- 請勿將本產品安裝於陽光直射的地方或強光照明燈具附近。
 - 這可能導致產品褪色。

運輸要求

- 當移動或儲存產品時，將插頭與插座分開，然後再分開適配器，以使其不會從地面上拖過。
 - 否則可能會損壞適配器或劃傷地板。
- 雙手握住產品底部的手柄 (❶)，安全地搬運產品。

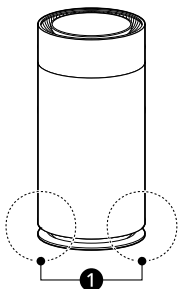

注意

- 請勿透過握住外蓋來搬運產品。
 - 這樣做可能導致外蓋被打開，並使產品跌落。電器墜落可能會導致人身傷害或產品故障。

連接電源

- 1 將適配器連接到產品背面的適配器連接端子。

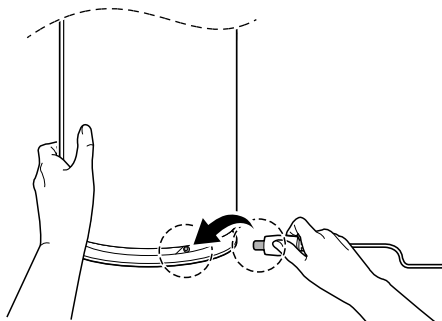

- 2 將適配器的電源插頭插入插座。

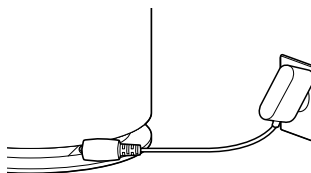

附註

- 握住產品，並水平地連接或斷開適配器。
- 將適配器連接到端部，不要在連接後移動適配器。（如此做可能導致損害。）
- 注意不要撞擊適配器。否則可能導致損害。

檢查功能

控制空氣清新機

· 僅具備此功能的型號上提供 **Pet** 模式。

控制面板

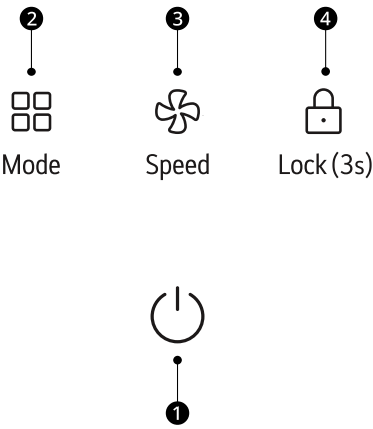

- 1 開始 / 停止按鈕**
開啟和關閉產品。
 - 要透過 **LG ThinQ** 應用程式準備產品以連接到 Wi-Fi，請按住該按鈕 3 秒或以上。
- 2 Mode 按鈕**
用於設定模式。
- 3 Speed 按鈕**
用於調節空氣淨化器的風扇速度。
- 4 Lock 按鈕**
您可透過按住此按鈕 3 秒，來鎖定或解鎖控制面板。

附註

· 您可透過長按控制面板上的按鈕 3 秒來使用其他功能。

長按 (3 秒以上)	額外功能
	濾網狀態通知重設

狀態面板

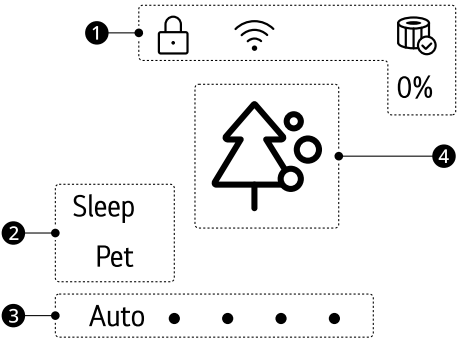

1 附加程式顯示

圖標	描述
	在鎖定功能已設定時亮起。
	在 Wi-Fi 功能啟動時亮起。
	顏色指示濾網壽命。如需詳細資訊，請參閱 更換濾網 。

2 顯示操作模式

指示目前正在運行的模式。

3 顯示速度

顯示空氣清新機的風扇速度。

速度	顯示	描述
自動	Auto ●●●●	LED 根據整體空氣質量而變化。
弱	●	1 個 LED 亮起
中	●●	2 個 LED 亮起
強	●●●	3 個 LED 亮起
最強	●●●●	4 個 LED 亮起

4 整體空氣質量（顏色）

整體空氣品質以顏色表示。→ 請參閱**整體空氣質量**以了解詳細的顏色資訊。

操作空氣清新機

開始 / 停止

按開始 / 停止按鈕，以開啟或關閉空氣清新機。

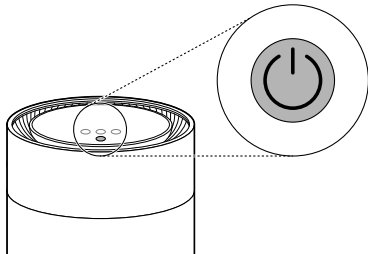

- 每次您按下此按鈕，操作模式都會以如下順序進行變更：淨化 → Sleep → Pet。

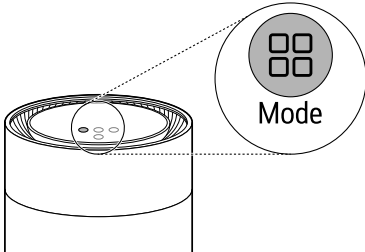

附註

- 如果您是第一次使用本裝置，則其會進入淨化模式。
- 如果由於電源故障而切斷電源，則會記住最近使用的模式。
- 當操作開始時，空氣品質大約需要 30 秒才能顯示在狀態面板上。

附註

- 狀態面板上不會顯示淨化模式。

使用睡眠模式

當您睡覺時，您可以在安靜的環境中使用空氣清新機。

按 **Mode** 按鈕，即可選擇 **Sleep** 模式。

- 每次您按下此按鈕，操作模式都會以如下順序進行變更：淨化 → Sleep → Pet。

操作模式

每次您按下 **Mode** 按鈕，模式會以如下順序進行變更：淨化 → Sleep → Pet。

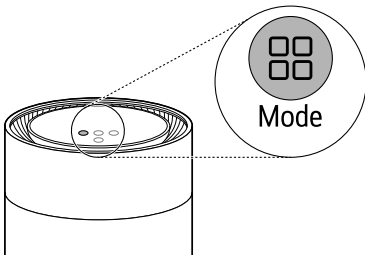
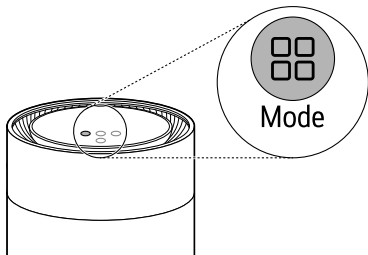

附註

- 除了 **Sleep** 模式的顯示外，整個顯示都將被關閉。
- 您不能單獨在 **Sleep** 模式下設定操作時間。要取消 **Sleep** 模式，請按與設定它的相同方式按 **Mode** 按鈕。

使用淨化模式

空氣清新機可淨化室內空氣。

按 **Mode** 按鈕，即可選擇淨化模式。

使用寵物護理

(僅適用於帶 **Pet** 模式的型號)

這是寵物主人的專用模式。此模式可透過根據整體空氣質量自動調節速度和氣流，來有效吸入寵物毛髮 / 灰塵。

按 **Mode** 按鈕，即可選擇 **Pet** 模式。

- 每次您按下此按鈕，操作模式都會以如下順序進行變更：淨化 → Sleep → **Pet**。

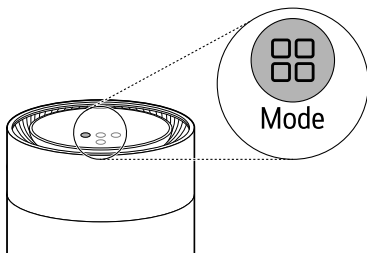

2 要調節風扇速度，請按下 **Speed** 按鈕。

- 當您在產品運轉期間按下此按鈕時，風扇速度將以如下順序進行變更：**自動** → 弱 → 中 → 強 → **最強**。

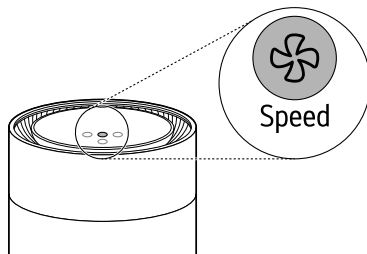

附註

- 首次開始操作時，將以**自動**為風扇速度來運行。**自動**將根據室內空氣的空氣質量水平來自動調節速度。

附註

- 當產品在 **Pet** 模式下運行時，將「最強」設為運行 30 分鐘；過了 30 分鐘後，將自動根據空氣質量設定風扇速度。
- 當 **Pet** 模式啟動時，按 **Speed** 按鈕可調整風扇速度。
 - 每次按下 **Speed** 按鈕時，風扇速度都會依以下順序變化：**自動** → 中 → 強 → **最強**。

使用額外功能

鎖定控制面板

由於某些不可預見的原因（例如兒童觸碰按鈕），您可以鎖定控制面板上的按鈕來阻止電器運行。

在操作期間按住 **Lock** 按鈕 3 秒或以上。

- 設定鎖定功能時，狀態面板上將顯示鎖定圖示。

調節風扇速度

您可調節空氣淨化器的風扇速度。

1 按下開始 / 停止按鈕以開啟產品。

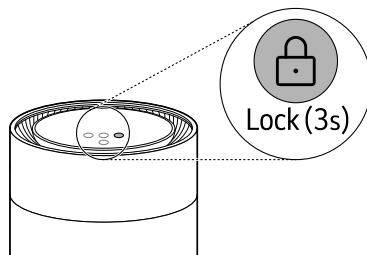
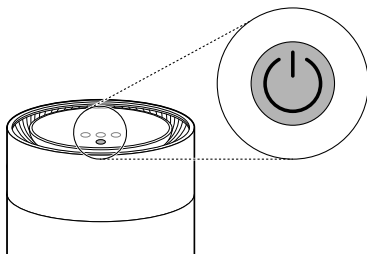

附註

- 您可以用與打開時一樣的方式關閉鎖定功能。
- 您也可在操作停止後鎖定或解鎖。

整體空氣品質

了解整體空氣品質

整體空氣品質是基於顆粒物濃度進行計算，且根據空氣中的污染程度分類為 4 個級別。（綠色、黃色、橙色和紅色）

顏色	整體空氣品質	顆粒物濃度 (µg/m³)		
	狀態	PM10	PM2.5	PM1.0
紅色	較差	255 或以上	56 或以上	56 或以上
橙色	不健康	155 ~ 254	36 ~ 55	36 ~ 55
黃色	中等	55 ~ 154	13 ~ 35	13 ~ 35
綠色	良好	54 或以下	12 或以下	12 或以下

附註

- 整體空氣質量可透過空氣品質指示燈的顏色來了解。
- 整體空氣質量指示燈的顏色是根據顆粒物 (PM) 濃度來確定。
- PM 濃度值基於感應器製造商提供的資料表。
- 採用 LG Electronics 標準測試材質對 PM 濃度測量進行測試。

智能系統

LG ThinQ 應用程式

LG ThinQ 應用程式允許使用智能手機與電器通訊。

LG ThinQ 應用程式功能

Smart Diagnosis (智能診斷)

如果您使用電器過程中遇到問題，此 **Smart Diagnosis** 功能將幫助您診斷問題。

設定

允許您在電器和應用程式中設定各種選項。

附註

- 在以下情況下，您必須在 **LG ThinQ** 應用程式中，於**裝置卡**→**設定**→**變更網絡**下更新各電器的網絡資訊。
 - 無線路由器已變更
 - 無線路由器密碼已變更
 - 互聯網服務供應商已變更
- 為方便後續對電器進行改進，應用程式可能會更改，恕不另行通知。
- 各功能可能因型號而異。

在使用 LG ThinQ 應用程式前

僅具備 Wi-Fi 功能的型號提供此功能。

- 檢查電器和無線路由器 (Wi-Fi 網絡) 之間的距離。
 - 如果電器和無線路由器之間的距離太遠，則信號強度會變弱。連接可能需要更長時間，否則安裝可能會失敗。
- 請關閉智能手機上的流動數據或手機數據。

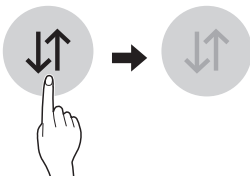

- 將智能手機連接到無線路由器。

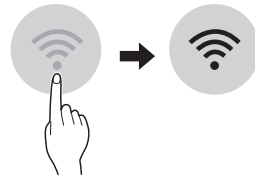

附註

- 如需驗證 Wi-Fi 連接，請檢查狀態顯示屏上的 Wi-Fi 圖標是否亮起。
- 該電器僅支援 **2.4 GHz Wi-Fi 網絡**。如需檢查您的網絡頻率，請聯絡您的互聯網提供服務商或參考您的無線路由器手冊。
- LG ThinQ** 不對任何網絡連接問題或網絡連接導致的任何故障、失效或錯誤負責。
- 如果電器無法連接到 Wi-Fi 網絡，則可能是離路由器太遠。請購買 Wi-Fi 中繼器 (距離擴展器) 以提高 Wi-Fi 信號強度。
- 由於家庭網絡環境，Wi-Fi 連接可能無法完成或斷開。
- 網絡連接可能無法正常工作，具體取決於互聯網服務提供商。
- 周圍存在的無線環境會使 Wi-Fi 服務運行變慢。
- 如果電器因無線訊號傳輸的問題而無法連接，請拔下電器插頭，並等待大約一分鐘，然後再重試。
- 如果無線路由器上的防火牆已啟用，請停用防火牆或對其新增例外。
- 無線網絡名稱 (SSID) 應為英文字母和數字的組合。(請勿使用特殊字元。)
- 智能手機使用者介面 (UI) 可能因流動作業系統 (OS) 和製造商而異。
- 如果路由器的安全性通訊協定設為 WEP，網絡設定可能失敗。變更安全性通訊協定 (推薦使用 WPA2)，然後再次連接產品。

安裝 LG ThinQ 應用程式

在智能手機上從 Google Play 商店或 Apple App Store 搜尋 **LG ThinQ** 應用程式。請依照說明下載和安裝該應用程式。

無線電設備規格

型號	LCWB-001	
Wi-Fi	頻率範圍	2412 MHz - 2472 MHz
	輸出功率 (最大值)	18.14 dBm
藍牙	頻率範圍	2402 MHz - 2480 MHz
	輸出功率 (最大值)	7.03 dBm

注意：開放來源程式碼軟件

欲獲得 GPL、LGPL、MPL 及其他有義務公開包含本產品內容原始程式授權的源代碼，及存取所有提及授權條款、版權聲明及其他相關文件，請瀏覽 <https://opensource.lge.com>。

LG Electronics 也應您要求，在由您支付相關費用（如媒體成本、運費及處理費）的條件下以 CD-ROM 方式提供開放原始程式碼，如有需要請寄送電子郵件至 opensource@lge.com。

該產品最後一次出貨的三年內，任何收到此資訊的人可享此優惠。

Smart Diagnosis（智能診斷）

使用此功能幫助您診斷並解決電器出現的問題。

附註

- 出於與 LGE 的過失無關的原因，此服務可能由於外部因素而無法運行，例如但不限於 Wi-Fi 不可用、Wi-Fi 斷開連接、本地應用商店政策或應用程式不可用。
- 此功能可能會隨時更改，恕不另行通知，並且根據您所在的位置，其形式可能會有所不同。

使用 LG ThinQ 診斷問題

如果您的具備 Wi-Fi 功能的電器出現問題，其可使用 **LG ThinQ** 應用程式將疑難排解數據傳輸至智能手機。

- 啟動 **LG ThinQ** 應用程式，然後在選單中選擇 **Smart Diagnosis** 功能。遵循 **LG ThinQ** 應用程式中的說明。

維護

維護產品

計劃維護

⚠ 警告

- 務必停止電器運作並從插座拔下電源插頭，然後再清潔和更換濾網。
- 不要直接噴水在電器上。

組件	清潔頻率	更換頻率
 濾網	前置濾網 按需要清潔過 濾器	1 年

附註

- 清潔頻率可能根據電器的操作時間和環境而異。
- 如不依照清潔頻率對產品進行清潔，您可能會聞到異味並且產品性能會下降。
- 濾網必須在使用壽命結束時進行更換，並且更換濾網的費用不在保養範圍內。要購買新的濾網，請聯絡 LG Electronics 客戶資訊中心或瀏覽網站 www.lg.com
- 如果顯示屏上的整體空氣質量長時間不改變，則清潔 PM1.0 感應器（即使未安排清潔）。

清潔外部

- 1 使用真空吸塵器清除進氣口和出氣口的灰塵。
- 2 用軟布擦拭出氣口和產品外部。

⚠ 注意

- 請勿用鹼性清潔劑擦拭電器。

- 切勿使用硫酸、鹽酸或有機溶劑（例如稀釋劑、煤油和丙酮）擦拭電器外部或在外部貼標籤。這樣做會損壞產品表面。
- 應格外小心，防止水流入產品。

附註

- 如果無法清除前後蓋上的灰塵，請拆卸蓋並用水進行清潔。清潔後，在陰涼處徹底晾乾蓋。

清潔顆粒物感應器

PM1.0 感測器裝置用於偵測細塵和大顆粒粉塵污染程度，因此建議定期清潔鏡頭，至少每 2 個月清潔一次。

- 1 握住帶 LG 標誌的產品前蓋頂端，輕輕拉動分開。

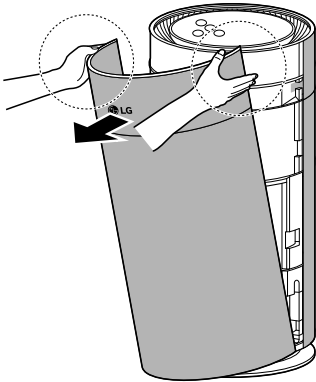

2 向上推感測器的蓋。

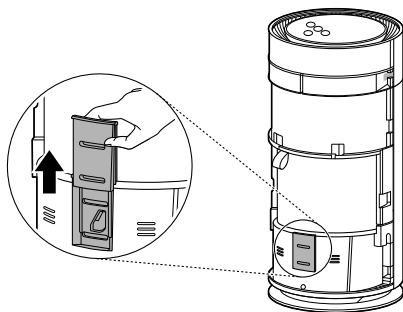

3 用沾水的棉棒清潔鏡頭並再次用一根乾的棉棒清潔一遍。

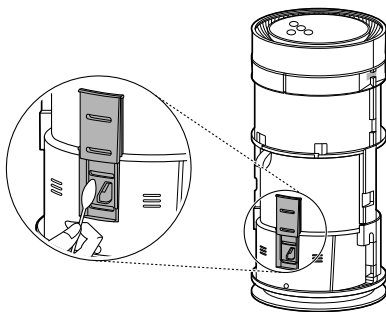

4 關上感測器的蓋。

附註

- 請勿使用水以外的任何物質擦拭感應器。可能致使電器發生故障。
- 打開或關上感測器的蓋時，可能會聽到摩擦的聲音。

清潔濾網

1 分離產品的前後蓋。

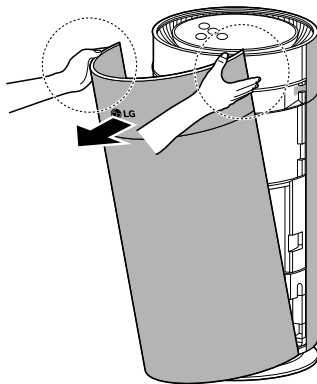

2 使用真空吸塵機或軟刷，清除濾網周圍前置濾網上的灰塵。

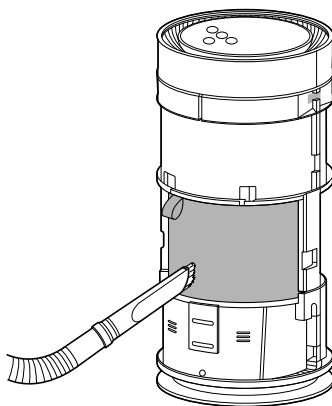

▲ 注意

- 請勿用水清洗濾網。濾網的使用壽命可能會縮短。
- 請注意在使用真空吸塵機時不要損害前置濾網。
- 請小心，因為分離或組裝前置濾網時有撕裂或丟失的危險。
- 請注意，若濾網浸入液體中，則可能會損壞濾網。

更換濾網

查看濾網狀態通知

：濾網狀態通知

顏色	綠色	橙色	紅色
狀態	濾網已安裝。	準備更換濾網。	更換濾網。

附註

- 濾網狀態通知會根據最長的使用時間（考慮產品的運行時間）而顯示。更換頻率由運行時間和環境來確定。
- 更換濾網後，重設濾網狀態通知。
 - 濾網狀態通知可透過額外的濾網狀態通知重設功能來重設。
- 當濾網狀態通知顯示為紅色時，也會顯示 0% 圖示。

更換濾網

- 移除外蓋並更換濾網。
 - 在更換過濾器時，為了避免污染環境，請在您移除過濾器之前在地板上鋪上一張報紙。
- 更換濾網後，停用濾網狀態通知。
 - 濾網狀態通知重設後，濾網狀態通知的顏色將變為綠色。

重設濾網狀態通知

按住控制面板上的 **Mode** 和 **Speed** 按鈕 3 秒鐘。

- 狀態面板上的濾網狀態通知將被重設，且濾網狀態通知的時間也會被初始化。

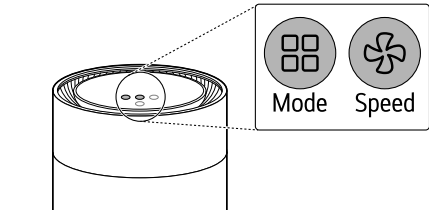

附註

- 在用新濾網更換時使用。

更換前置濾網

檢查前置濾網的粘合扣，慢慢將其分離，以更換前置濾網。

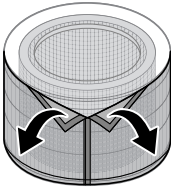

存放

如長時間沒有使用電器，請將它放置在陰涼、乾爽的地方。

- 在好天氣的情況下操作產品一小時或以上。
 - 這樣可以去除水分，並阻止黴菌在產品內部堆積。
- 關閉產品，將插頭從插座分開，然後分開適配器。
 - 從產品分開適配器，並妥善儲存。
- 包裝電器以防止灰塵或異物進入電器。

將包裝的電器存放在陰涼的地方。

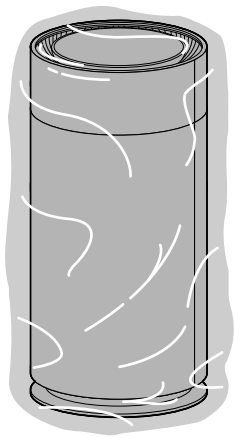

⚠ 注意

- 請勿將電器存放在潮濕位置或陽光直射的地方。
否則電器可能會變形、發生故障或產生異味。
-

疑難排解

在致電尋求服務之前

請查看以下內容，然後再聯絡服務中心。如果問題仍然存在，請聯絡當地的服務中心。

操作

癥狀	可能的原因和解決方案
產品電源未開啟。	電源插頭是否已拔下？ · 將其正確地連接到插座上。
	斷電了嗎？ · 檢查家中其他產品的電源。
有噪音，風速低。	前置濾網內是否堆積有灰塵？ · 清潔前置濾網。
	濾網內是否堆積有灰塵？ · 更換濾網。
空氣淨化效果不良。	室內是否污染嚴重？ · 使用本產品前，請保持室內通風。
	前置濾網內是否堆積有灰塵？ · 清潔前置濾網。
	濾網內是否堆積有灰塵？ · 更換濾網。
	是否於太寬敞或太開放的空間內使用產品？ · 使用適合房間大小的產品。 · 避開通風良好的地方，如門、窗等。
	附近是否有障礙物？ · 操作本產品前，請清除附近的任何障礙物。
	本產品是否安裝於角落？ · 移動本產品並進行重新安裝。
整體空氣質量指示燈保持紅色。	將電器移至其他房間，查看顏色是否改變。 · 清潔 PM1.0 感應器。 · 將電源插頭從電源插座上移除並在一分鐘後重新連接。
	在產品附近噴灑了一種物質。 · 請勿在產品附近使用噴霧劑。
控制面板的按鈕不工作。	狀態面板上是否顯示鎖定圖示？ · 按住 Lock 按鈕 3 秒以停用鎖定功能。

癥狀	可能的原因和解決方案
濾網狀態通知的顏色不會變為綠色。	<p>濾網狀態通知的顏色是否為橙色或紅色？</p> <ul style="list-style-type: none">濾網狀態通知可透過額外的濾網狀態通知重設功能來重設。按住控制面板上的 Mode 和 Speed 按鈕 3 秒鐘。

異味

癥狀	可能的原因和解決方案
出氣口和過濾器發出一股奇怪的氣味。	<p>電器是新的。</p> <ul style="list-style-type: none">活性炭的氣味無害。這種氣味類似於您在新車中聞到的氣味。該氣味會在使用一兩周後消散。
	<p>本電器位於有大量煙霧或氣味的區域。</p> <ul style="list-style-type: none">在有大量煙霧或氣味的區域，過濾器的使用壽命可能會大大縮短。為了達到最佳效果，請先為房間通風，然後再使用電器。
	<p>氣味來自過濾器。</p> <ul style="list-style-type: none">更換過濾器。根據使用環境的不同，過濾器更換的頻率可能會不同。
	<p>本電器位於有大量強烈氣味的區域。</p> <ul style="list-style-type: none">如果在烹飪或烤魚或肉的地方附近使用本電器，過濾器的使用壽命將大大縮短。為了達到最佳效果，請首先打開窗戶或使用通風罩對該區域進行通風。使用本電器的唯一目的是，最大限度減少對區域進行通風後殘留的氣味。

LG ThinQ

癥狀	可能的原因和解決方案
無法透過 Wi-Fi 連接本產品和智能手機。	<p>用於連接智能手機的 Wi-Fi 密碼是否正確？</p> <ul style="list-style-type: none">按下智能手機上的設定按鈕，然後在網絡清單中找到您的 Wi-Fi。按住該按鈕選擇 [清除網絡]，然後重新開始進行產品註冊。
	<p>智能手機使用的是流動數據而不是 Wi-Fi 嗎？</p> <ul style="list-style-type: none">在智能手機的設定中，關閉流動數據，開啟 Wi-Fi，然後註冊產品。
	<p>無線路由器的名稱 (ID) 是否包含特殊字符？</p> <ul style="list-style-type: none">將無線路由器的名稱 (ID) 設定為數字和英文字母的組合。若輸入特殊字元，Wi-Fi 連接可能有困難。
	<p>無線路由器的頻率不是 2.4GHz 嗎？</p> <ul style="list-style-type: none">透過 Wi-Fi 連接產品時，僅能使用 2.4GHz 網絡。將無線路由器設定為 2.4GHz，然後進行連接。若要檢查無線路由器的頻率，請聯絡您的互聯網營運商或路由器製造商。

癥狀	可能的原因和解決方案
無法透過 Wi-Fi 連接本產品和智能手機。	<p data-bbox="325 158 647 181">本產品與無線路由器是否相距太遠？</p> <ul data-bbox="325 196 1033 247" style="list-style-type: none"><li data-bbox="325 196 1033 247">· 若本產品距離無線路由器太遠，則無線訊號可能較弱，並且連接可能不順暢。將無線路由器靠近本產品。

附錄

資訊

電器規格

· 為提高電器質量，外觀和規格可能會有所變化，恕不另行通知。

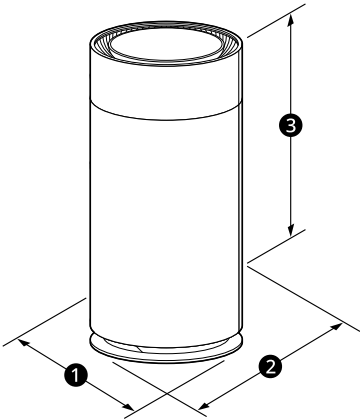

名稱	AS35GGW10，AS35GGW20
電源	DC 24V
外部尺寸 (1 x 2 x 3)	240mm x 240mm x 500mm

AC/DC 適配器	
製造商	FOSHAN SHUNDE GUANYUDA POWER SUPPLY CO.,LTD.
型號	GM51-240200-2A
額定輸入	AC 100 V - 240 V ~，50/60 Hz
額定輸出	DC 24 V，2.0 A，48 W

