



OWNER'S MANUAL

AIR PURIFIER

For safe and easy use of the product please the manual before use.

Please keep the warranty also included in a safe location.

This appliance is an indoor home appliance for use only at home.

Do not use this appliance for commercial, experimental or industrial purposes.

AS60GH Series

EN ENGLISH



LBR42258HKOMR1
Rev.00_042023

www.lg.com

Copyright © 2023 LG Electronics Inc. All Rights Reserved.

Table of Contents

SAFETY INSTRUCTION

- 04 Please Read Before Using the Product**
- 04 Safety Symbols and their Meanings
- 04 WARNING**
- 04 Children in the Household
- 04 When Handling the Power Plug and the Power Cord
- 05 When Installing the Product
- 06 When Using the Product
- 07 Just in case
- 07 CAUTION**
- 07 When Installing the Product
- 07 When Using the Product

USING LG ThinQ

- 09 LG ThinQ Application**
- 09 LG ThinQ Application Features
- 09 Before using LG ThinQ Application
- 10 Installing the LG ThinQ Application
- 10 Wireless LAN module Specifications
- 10 Open Source Software Notice Information

OVERVIEW

- 11 Exploring the Appearance of the Product**
- 11 Air Purifier
- 12 Filter
- 13 Components

- 14 Installing and Getting Ready**
- 14 Removing the Protective Vinyl from the Filter
- 15 Selecting the Installation Site
- 15 When Carrying the Product

USING

- 16 Exploring the Control Panel**
- 16 Using the Control Panel
- 18 Using the Basic Functions of the Air Purifier**
- 18 Start/Stop
- 18 Adjusting the Fan Speed
- 18 Using the Additional Functions of the Air Purifier**
- 18 Using Sleep Mode
- 19 Locking the Control Panel
- 19 Using the Ionizer
- 20 Overall Air Quality**
- 20 Understanding Overall Air Quality

MAINTENANCE

- 21 Cleaning**
- 21 Cleaning the Exterior
- 21 Cleaning the PM1.0 Sensor
- 21 Frequency of Filter Cleaning and Replacement
- 22 Cleaning the Filters
- 22 Replacing the Filters
- 23 Storing**
- 23 Storing the Product

This manual may contain images or content that may be different from the model you purchased. This manual is subject to revision by the manufacturer.

THINGS TO CHECK BEFORE REPORTING A MALFUNCTION

24 Diagnosing a Malfunction

- 24 Diagnosing the Cause of a
Malfunction with the LG ThinQ
Application

25 Troubleshooting

- 25 Before Calling for Service
- 25 Operation
- 26 Odor
- 27 LG ThinQ

APPENDIX

28 Product Specifications

- 28 Specifications Guide
- 31 Warranty Certificate

SAFETY INSTRUCTION

Please Read Before Using the Product

'SAFETY INSTRUCTION' below are designed to prevent expected risks or damage, so be sure to read them carefully.

'SAFETY INSTRUCTION' are separated into 'WARNING' and 'CAUTION'.

Safety Symbols and their Meanings



This graphical symbol is used to call the user's attention to matters and operations that can cause risk. Read the text marked with this symbol carefully and follow the instructions in order to avoid risk.



WARNING

This indicates that failure to follow the instructions can cause serious injury or death.



CAUTION

This indicates that failure to follow the instructions can cause minor injury or damage to the product.

General users can access the appliance.

WARNING



WARNING

- This indicates that failure to follow the instructions can cause serious injury or death due to fire or electric shock.

Children in the Household

- This appliance is not intended for use by persons (including children) with reduced physical, sensory or mental capabilities, or lack of experience and knowledge, unless they have been given supervision or instruction concerning use of the appliance by a person responsible for their safety. Children should be supervised to ensure that they do not play with the appliance.

When Handling the Power Plug and the Power Cord



Prohibitions

- Do not touch the power plug with wet hands.

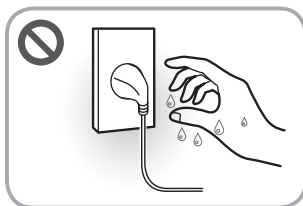

- Do not destroy the power plug or the power cord. Do not damage, extend, place near high temperatures, excessively bend, twist, place heavy objects on top, or tie a knot in the power cable.
- Do not connect the power plug to a multi-outlet (attached type), a plug adapter, or other accessories with no grounding cable.
- Do not let the back of the product to press the power plug or plug it in backwards.

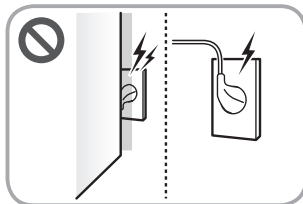

- Turn off and unplug the appliance before cleaning it or replacing the filter.
- Do not repeatedly connect and disconnect the power plug.
- Do not unplug during operation.

○ Compliance

- This appliance is for use with 220-240 V only. Be sure to connect the power plug to a 220-240 V outlet with a grounding terminal.
- If you wish to use a multi-socket extension outlet, use a multi-socket extension outlet with a ground terminal with a current capacity of 20 A or more. Connect only this appliance to the multi-socket extension outlet.
- When installing a new appliance, use a newly purchased multi-socket extension outlet if possible, and periodically check the condition of the wire sheath and plug connection.
- If there is moisture or dust on the power plug, remove it completely and then plug into the outlet firmly.
- When unplugging the power cord, always pull it by the plug.
- Unplug the appliance during thunder or lightning storms or when not in use for a long time.
- Do not allow your pet animals to nibble the power cord.
- If moisture penetrates inside the product, disconnect the power plug and contact an LG Electronics Customer Information Center.
- If the power cord or power plug is damaged, or the holes in the power socket are loose, stop using the product immediately and contact an LG Electronics Customer Information Center.

When Installing the Product

⊗ Prohibitions

- Do not install the appliance in the following places:
 - Places exposed to water or rainwater, or places with high humidity.
 - Places under direct sunlight or where there are heating appliances.
 - Places with a lot of dust or extreme temperature changes (outdoor, vinyl greenhouses, etc.).
 - Places with a leak of flammable gas leaks or with a lot of industrial oil or metallic dust.
- Only an authorized repair person from from an LG Electronics Customer Information Center should disassemble, repair, or modify the appliance.

○ Compliance

- Install the product in a place where it can be easily unplugged from the power outlet.
- Dispose of product packaging materials (vinyl, Styrofoam, etc.) immediately after installation. Children can choke on packaging whilst playing with it.

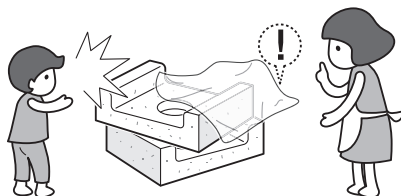

When Using the Product

⊘ Prohibitions

- Do not move the product while power is connected.
- Do not put flammable substances into the product.
- Do not use damaged components.
- Do not operate the appliance while its cover is open.
- Do not forcibly open the air inlet or outlet or insert a finger or any foreign object (sticks, pins, etc.) into the air inlet or outlet during operation.
- Do not operate the appliance with wet hands.
- Do not put your hands or any foreign objects in or spray water on the product.
- Do not place the power cord under mats.
- Do not use or store the product near flame, combustibles (ether, benzene, alcohol, medicines, LP gas, combustible spray, insecticide, air freshener, cosmetics, etc.) or flammable materials (candles, lamps, etc.).

○ Compliance

- Unplug the appliance before cleaning it.
- Be careful not to subject the product to strong impact or to overturn it.
- Do not allow animals or pets to chew on the power cord.

Just in case

Compliance

- If you detect any abnormal noise, odor or smoke, unplug the product immediately and contact an LG Electronics Customer Information Center.
- If the appliance is immersed in water, stop using it and contact an LG Electronics Customer Information Center.
- If there is a gas leakage (isobutane, propane, LNG, etc.), do not touch the product or power plug and ventilate the area immediately.

CAUTION



CAUTION

- This indicates that failure to follow the instructions can cause minor injury or damage to the product.

When Installing the Product

Prohibitions

- Do not install the appliance in an unstable place or in a place with severe vibration.
- Do not install the appliance above the user's eye level.
- Do not install the appliance in a RV, marine vesselship, or an airplane.
- Do not tilt the appliance to pull or push it when transporting.
- Do not place the appliance near a TV or stereo equipment.
- Do not place the appliance under bright light.
- Do not install or use the product in a location where there is a risk of explosion.

Compliance

- Install the appliance in a level space with a hard floor and no threshold.

When Using the Product

Prohibitions

- Do not insert foreign objects or spray water into the appliance or the sensor hole.
- Do not use the product for removal of toxic gas such as carbon monoxide.
- Do not use the product for ventilation purposes.
- Do not place obstacles around the air inlet or outlet.

- Do not use the appliance near curtains.
- Do not use the appliance for special purposes or areas, such as preservation of animals and plants, precision instruments, or art works, etc.
- Do not use the appliance while it is not in an upright position.
- Do not use the appliance near objects vulnerable to heat.
- Do not use the filter for purposes other than those for which the appliance is designed.
- Do not use detergents, cosmetics, chemicals, air fresheners, or disinfectants in the appliance.
- Do not use strong detergents or solvents to clean the product.
- Do not place coffee, vases or other beverages on top of the appliance.
- Do not place magnets or metallic objects on top of the appliance.
- Do not expose the appliance to impact shock.
- Do not let the moisture from a humidifier directly touch the appliance.

Compliance

- Be careful not to place objects or liquids on top of the appliance.
- Do not let children climb onto the appliance or let the appliance tip over as a result of excessive impact.
- Do not clean the appliance with brushes, cloths or sponges which are abrasive or made of metal. Use a soft microfiber cloth to clean the product.
- Be careful not to let body parts get caught in the product when removing product components and/or reassembling them.

USING LG ThinQ

LG ThinQ Application

The LG ThinQ application allows you to communicate with the appliance using a smartphone.

LG ThinQ Application Features

Smart Diagnosis

If you experience a problem while using the appliance, this smart diagnosis feature will help you diagnose the problem.

Settings

Allows you to set various options on the appliance and in the application.

NOTE

- If you change your wireless router, Internet service provider, or password, delete the connected appliance from the LG ThinQ application and connect it again.
- The application is subject to change for appliance improvement purposes without notice to users.
- Functions may vary by model.

Before using LG ThinQ Application

This feature is only available on models with Wi-Fi function.

- 1 Check the distance between the appliance and the wireless router (Wi-Fi network).
 - If the distance between the appliance and the wireless router is too far, the signal strength becomes weak. It may take a long time to connect or installation may fail.
- 2 Turn off the Mobile data or Cellular Data on your smartphone.

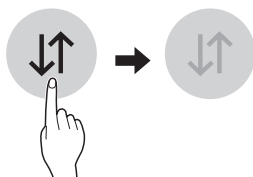

- 3 Connect your smartphone to the wireless router.

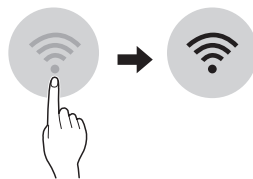

NOTE

- To verify the Wi-Fi connection, check that the Wi-Fi icon on the control panel is lit.
- **The appliance supports 2.4 GHz Wi-Fi networks only.** To check your network frequency, contact your Internet service provider or refer to your wireless router manual.
- LG ThinQ is not responsible for any network connection problems or any faults, malfunctions, or errors caused by network connection.
- If the appliance is having trouble connecting to the Wi-Fi network, it may be too far from the router. Purchase a Wi-Fi repeater (range extender) to improve the Wi-Fi signal strength.
- The Wi-Fi connection may not connect or may be interrupted because of the home network environment.
- The network connection may not work properly depending on the Internet service provider.
- The surrounding wireless environment can make the wireless network service run slowly.
- If the appliance cannot be connected due to problems with the wireless signal transmission, unplug the appliance and wait about a minute before trying it again.
- If the firewall on your wireless router is enabled, disable the firewall or add an exception to it.
- The wireless network name (SSID) should be a combination of English letters and numbers. (Do not use special characters.)

- Smartphone user interface (UI) may vary depending on the mobile operating system (OS) and the manufacturer.
- If the security protocol of the router is set to WEP, the network setup may fail. Change the security protocol (WPA2 is recommended) and connect the product again.

Installing the LG ThinQ Application

Search for the LG ThinQ application from the Google Play Store or Apple App Store on a smartphone. Follow instructions to download and install the application.

Wireless LAN module Specifications

Model	LCW-010
Frequency Range	2412 MHz - 2472 MHz
Output Power (Max)	IEEE 802.11b: 18.06 dBm IEEE 802.11g: 18.95 dBm IEEE 802.11n(HT20):18.43 dBm IEEE 802.11n(HT40): 17.96 dBm

Open Source Software Notice Information

To obtain the source code that is contained in this product, under GPL, LGPL, MPL, and other open source licenses that have the obligation to disclose source code, and to access all referred license terms, copyright notices and other relevant documents, please visit <https://opensource.lge.com>.

LG Electronics will also provide open source code to you on CD-ROM for a charge covering the cost of performing such distribution (such as the cost of media, shipping, and handling) upon email request to opensource@lge.com.

This offer is valid to anyone in receipt of this information for a period of three years after our last shipment of this product.

OVERVIEW

Exploring the Appearance of the Product

Air Purifier

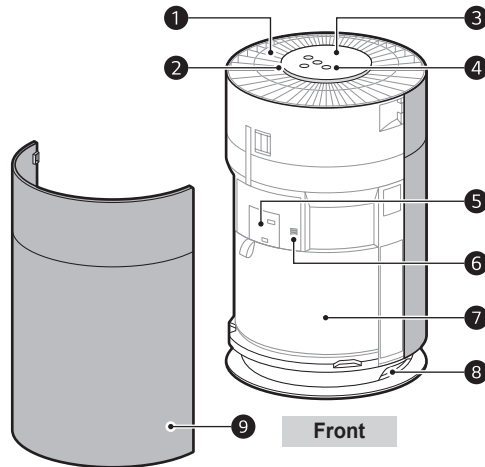

- ① **Air outlet**
 - Purified air is emitted from the filter.
- ② **Air quality light**
 - The current air quality is indicated by a color (green, yellow, orange, red).
- ③ **Display panel**
 - Use it to check the settings of the product and the air condition.
- ④ **Control panel**
 - Use it to set the appliance functions.
- ⑤ **PM1.0 (particles with a diameter between 1.0 and 2.5 micrometers) sensor**
 - Use it to detect dust concentration.
- ⑥ **Odor (gas) sensor**
 - Use it to detect odors and gases.
- ⑦ **Filter**
 - Minimizes PM2.5, smog-causing substances, sickening house syndrome materials and domestic odor.
- ⑧ **Handle**
 - Allows you to hold the handle and relocate the appliance.
- ⑨ **Air inlet**
 - Allows you to disassemble the front and the rear covers separately.

Filter

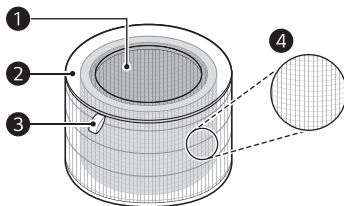

- ❶ Deodorizing care filter
 - Use it to eliminate smog-causing substances (SO_2 , NO_2), sickening house syndrome materials (toluene, formaldehyde) and domestic odor (ammonia, acetic acid, acetaldehyde).
- ❷ Total allergy care filter
 - Minimizes $\text{PM}_{2.5}$.
- ❸ Filter handle
 - Use it when inserting or removing the filter from the product.
 - Position the side with the handle facing up.
- ❹ Ultra-fine filter
 - The Ultra-fine filter is attached to the outer surface of the filter, and primarily removes large particles of living dust from the air.



CAUTION

- The filter is attached, so do not forcibly separate the filter.
- Do not throw or use the filter for other purposes.

✔ NOTE

- A slight odor may be emitted from a new filter at the start of use following purchase. The odor will disappear after a day or so of using the product, so you can use it without concern.
- The filter cleaning and replacement frequency may differ depending on the usage environment and duration of use.
- The filter can be used for up to 1 year. The more polluted the indoor air, the shorter the life of the filter.
- If there is excessive odor in the room, first ventilate the room to eliminate odors and gases, then use the appliance for eliminating remaining odors.
- If the air purifier has not been used for a long time and as a result it generates odors, you can reduce such odors from the filter by operating the air purifier in a well-ventilated place at high speed.
- The filter may emit an odor when used continuously in a humid environment or where moisture from a humidifier has been absorbed into the filter. If there is an odor from the filter due to moisture, only use the filter after sufficiently drying it in sunlight.
- Carbon monoxide (CO) is a harmful gas that is mainly introduced from the outside, and cannot be removed with a filter.
- Keep windows or doors closed when operating the appliance. However, if you operate the appliance for a long time in a closed space, carbon dioxide concentrations may rise. So be sure to ventilate the indoor regularly.
- The deodorization function of the air purifier traps odors and gases from the air in a filter. If you use the product for a long time in a room with excessive odor, the performance of the filter may decrease significantly.
- If the surrounding odor is absorbed by the filter and the product smells while operating, it is time to replace the filter. Filter replacement costs are not covered under warranty. To purchase new filters, contact an LG Electronics Customer Information Center or visit the website at www.lg.com.

Components



1

- 1 Owner's manual

Installing and Getting Ready

Removing the Protective Vinyl from the Filter

- 1 Unpack the appliance and remove all packing tape and filter vinyl before using the appliance.
- 2 Hold the top end of the front cover of the product with the **LG logo** and pull it slightly to achieve separation.

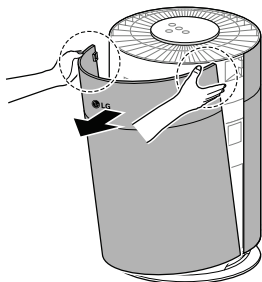

- 3 Disassemble the filter and remove the vinyl.

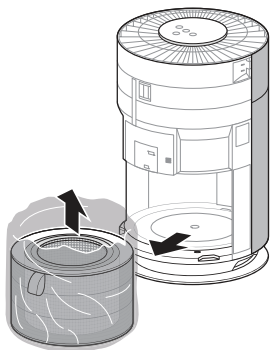

- 4 Install the filter in the appliance with the side where the filter handle is attached facing up.

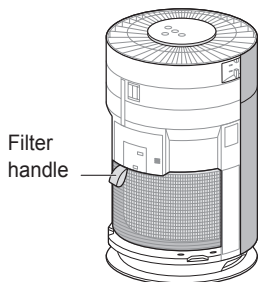

- 5 Insert the fixing part at the bottom of the cover into the fixing grooves at the bottom of the product and close the cover.

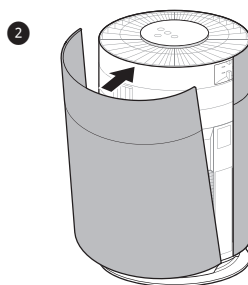
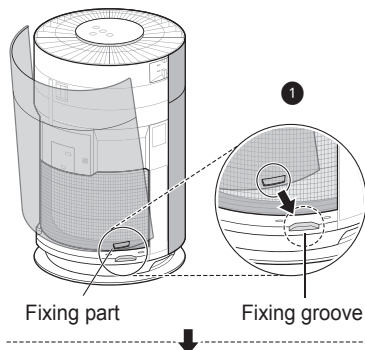

CAUTION

- Be sure to remove the vinyl before using the product.
- Pay attention to filter direction when installing it.

Selecting the Installation Site

- Install the appliance 1 m away from a wall.
 - If there is not enough space for air to be taken in, performance of the air purifier may be reduced.

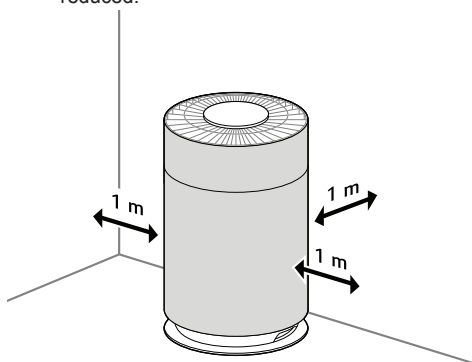

- The performance of the appliance may vary depending on the service environment (temperature, humidity, etc.).
 - The appliance can provide the guaranteed performance in an environment with humidity ranging between 40 % and 70 %.
- Do not install the product in a place exposed to direct sunlight or near lighting fixtures with strong light.

When Carrying the Product

- When you relocate or store the appliance, wind the power cord onto the bottom of the product to prevent it from dragging on the floor.
 - Failure to do so may damage the power plug or leave a scratch on the floor.
- Do not carry the product by holding the external cover.
 - Doing so may allow the cover to open and the product to drop. Dropping the appliance may cause personal injury or product malfunction.



- Transport the product safely by holding the handle at the bottom of the product with both hands.

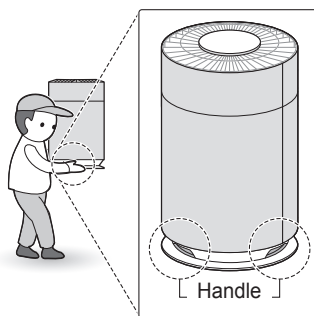

USING

Exploring the Control Panel

Using the Control Panel

Control panel

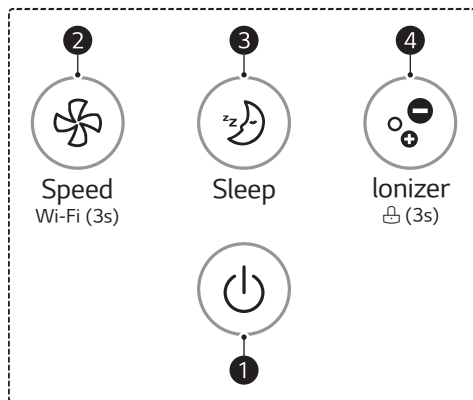

1 Start/Stop button

Turns the product on and off.

2 Speed button

Sets the fan speed of the product.

- When you press and hold the button for 3 seconds, the product will be ready to connect to Wi-Fi.

3 Sleep button

The Sleep Mode can be set or cancelled.

4 Ionizer button



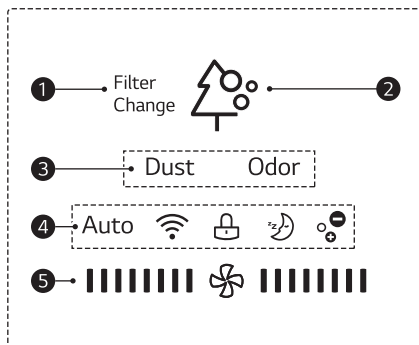

It generates ion and removes various bacteria in the indoor air.

- You can lock or unlock the control panel by pressing and holding the button for 3 seconds.

Display panel



- ❶ Indication of filter replacement
Displays when it is time to replace the filter.
- ❷ Overall air quality
Indicates the overall air quality using colors (green, yellow, orange, red).
→ See **Understanding the Overall Air Quality** for detailed color information.
- ❸ Indication of dust/odor
Dust: Displays when the concentration of dust is higher than the concentration of odor.
Odor: Displays when the concentration of odor is higher than the concentration of dust.
• Displays at the same time when the concentration of dust is the same as the concentration of odor.
- ❹ Icons

Icon		Description
Auto	Clean Auto	Lights up when fan speed is set to Auto.
	Wi-Fi	Lights up when the Wi-Fi function is activated.
	Lock	Lights up when the control panel is locked.
	Sleep	Lights up when the sleep mode is activated.
	Ionizer	Lights up when the ionizer is activated.

- ❺ Indication of fan speed
The fan speed of the air purifier is displayed.

Using the Basic Functions of the Air Purifier

Start/Stop

Turns the product on and off.

- Press the **Start/Stop** button.

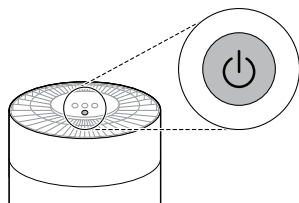

NOTE

- The most recently used mode is memorized if the power supply is cut off as a result of a power failure.
- When the operation begins, the display of sensor ready will appear for approximately 30 seconds.

Adjusting the Fan Speed

You can adjust the fan speed from the air purifier.

- Press the **Start/Stop** button to turn on the product.

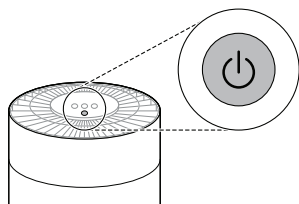

- To adjust the fan speed, press the **Speed** button.

- When you press the button during product operation, the fan speed changes in the order of **Auto** → **Low** → **Medium** → **High** → **Turbo**.

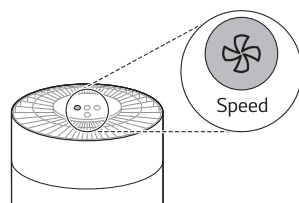

NOTE

- When the operation is started for the first time, **Auto** is set as the fan speed. In **Auto** mode, the fan speed is adjusted automatically according to the contamination level of indoor air.
- The fan speed is displayed on the display panel when it is adjusted. The indication of fan speed increases by 2 columns at a time. It is displayed as below when the fan speed is set to Medium.



Using the Additional Functions of the Air Purifier

Using Sleep Mode

You can use the air purifier in a quiet environment when you go to sleep.

- Press the **Start/Stop** button to turn on the product.

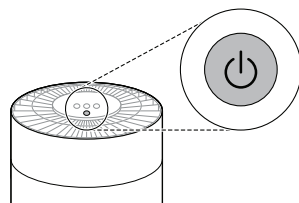

- Press the **Sleep** button.

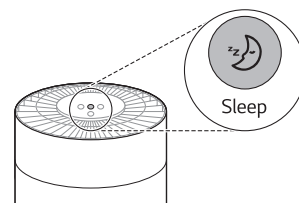

NOTE

- The sleep mode icon is displayed on the display panel.
- The whole display is turned off except for the display of sleep mode.
- During operation in sleep mode, the fan speed is set to Low, and after a set period of time, it is reset to Low or Medium depending on the degree of indoor air pollution.
- Fan speed can be adjusted by pressing the **Speed** button while the sleep mode is activated.
- You cannot set the operation time in sleep mode separately. To cancel the sleep mode, press the **Sleep** button in the same way as in setting it.

Locking the Control Panel

You can lock the buttons on the control panel to prevent the appliance from operating due to unforeseen reasons, such as a child manipulating the buttons.

- Press the **ionizer** button for 3 seconds or longer.
-  is displayed on the display panel when the Lock function is set.

NOTE

- You can turn off the lock function in the same way as turning it on.
- You can also lock or unlock when the operation has stopped.

Using the Ionizer

To generate ions to minimize various bacteria from the air.

- 1 Press the **Start/Stop** button to turn on the product.

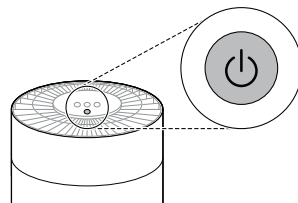

- 2 Press the **ionizer** button.

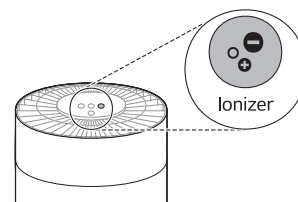

NOTE

- This product may generate ozone due to the ionizer, so ventilation is recommended when using it for a long time.

Overall Air Quality

Understanding Overall Air Quality

The overall air quality is calculated based on the particles and odor (gas) concentrations and is categorized in 4 levels, including green, yellow, orange, and red, depending on the contamination of the air.

Color	Overall air quality	Concentration of PM (µg/m³)			Concentration of odor	
	State	PM10 (Coarse particles)	PM2.5 (Fine particles)	PM1.0 (Ultra-fine particles)	State	Level
Red	Poor	255 or more	56 or more	56 or more	Very strong	4
Orange	Unhealthy	155 ~ 254	36 ~ 55	36 ~ 55	Strong	3
Yellow	Moderate	55 ~ 154	13 ~ 35	13 ~ 35	Normal	2
Green	Good	54 or less	12 or less	12 or less	Weak	1

NOTE

- The color of the overall air quality is determined by the worst level among the concentration of dust and odor (gas).
- The level of dust concentration for LG Electronics products is the result expressed after measuring the quantity of dust using an optical method and converting the measurement into PM10 concentration.
- The overall air quality level is a result of both PM concentration and the odor level.
- Whether it is a different product or the same product used in the same space, the concentration measurement may vary due to air circulation.
- Unlike odors (gases), fine dust (PM10) spreads slowly, so the time at which the dust concentration is measured may be delayed.
- Air flow near the PM1.0 sensor may interrupt normal operation of the PM1.0 sensor and indicated concentration may be different from actual concentration, accordingly.
- When the product is used in the following environment, the measured concentration may differ from the actual concentration.
 - Near fabric sofas and beds, around hairy carpets, while making beds/folding clothes, while using vacuum cleaners, places with bugs and pets, and places with high humidity.
 - Places where outside air is available, such as construction sites, roadsides, and factories, or near outside doors, windows, and vents.
 - Places where products generating steam or fine particles (humidifiers, kitchen tools, or sprays) are used.
 - The sensor may not detect particles larger than PM10 generated by activities such as dusting off blankets or cleaning, but they are removed by the filter.
- The concentration of odors (gas) may vary due to items emitting odors such as air fresheners, deodorizers, detergents, cosmetics, or perfumes.
- You can check the dust concentration through the LG ThinQ application.

MAINTENANCE

Cleaning

Cleaning the Exterior

- 1 Remove any dust from the air inlet and outlet using a vacuum cleaner.
- 2 Wipe the exterior with a soft cloth.

WARNING

- Turn off and unplug the appliance before cleaning or replacing the filter.
- Do not spray water directly onto the product.

CAUTION

- Do not clean the appliance with an alkaline detergent.
- Do not wipe the appliance surface using sulfuric acid, hydrochloric acid or organic solvents (thinner, kerosene etc.) or attach a sticker on the appliance. This may damage the appliance surface.
- Do not allow water inside the appliance.

NOTE

- If you find it difficult to remove dust from the front and rear covers, remove the filters and wash them with water. Then, dry them completely in the shade.

Cleaning the PM1.0 Sensor

The PM1.0 (particles with a diameter between 1.0 and 2.5 micrometers) sensor is the device detecting fine dust and large dust contamination levels, so the lens must be cleaned periodically, at least once every 2 months.

- 1 Separate the front cover with the **LG logo** from the product.

- 2 Open the sensor cover.

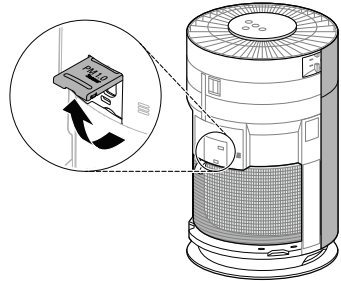

- 3 Clean the lens with the cotton swab soaked with water and clean it again with a dry cotton swab.

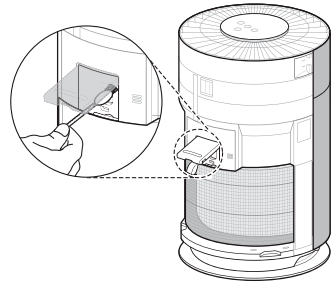

NOTE

- Do not wipe the sensor with anything other than water. This may cause failure.

Frequency of Filter Cleaning and Replacement

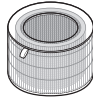
Type	Cleaning frequency	Replacement frequency
 Filter	Ultra-fine filter Clean filter as needed	1 year

NOTE

- The cleaning frequency may vary depending on the operating hours and environment of the appliance.
- If you do not clean the product according to the cleaning frequency, you may experience a bad odor and poor performance.

NOTE

- A filter is a consumable item. Therefore, you must purchase new ones for replacement when they have reached the end of their lifespan even during the warranty period.
To purchase new filters, contact a near-by LG Electronics Customer Information Center or visit the website (www.lg.com).
- You can also have the filter cleaned or replaced by an LG Electronics Customer Information Center.
You will be charged a nominal fee for filter cleaning and replacement services.

Cleaning the Filters

- 1 Separate the front and rear covers of the product.
- 2 Remove particles off of the ultra-fine filter with a vacuum cleaner or a soft brush.

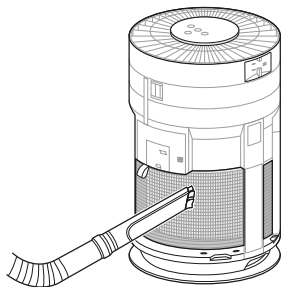

CAUTION

- Do not clean the filter with water. The service life of the filter may be reduced.
- Be careful not to damage the ultra-fine filter when using a vacuum cleaner.

Replacing the Filters

Replace the filter when the filter replacement alert is displayed on the display panel.

- 1 Separate the cover from the product and replace the filter.
 - To avoid polluting the surroundings when replacing the filter, place a newspaper on the floor before you remove the filter.
- 2 Once you have replaced the filter, disable the filter replacement alert.

NOTE

- Filter replacement alerts appear based on the maximum usage time, taking into account the operating hours of the product. Replacement frequency is determined by the operating hours and the environment.

Disabling the Filter Replacement Alert

Press and hold the **Sleep** button and the **Ionizer** button at the same time for 3 seconds.

- The filter replacement alert on the display panel is disabled and the replacement alarm is reset.

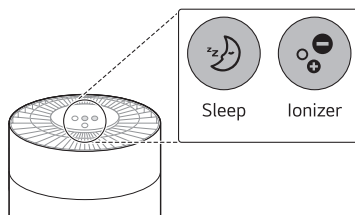

Replacing the ultra-fine filter

Check the Velcro of the ultra-fine filter and replace the ultra-fine filter by separating it slowly.

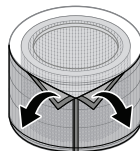

Storing

Storing the Product

If the product is not used for a long period of time, store it in a shady place away from moisture.

- 1 Operate the product for one hour or more on a fine day.
 - This removes the moisture and prevents molds from building up inside the product.
- 2 Turn off the power and unplug it from the electrical outlet.
 - Wind the power cord around the bottom of the appliance.
- 3 Package the appliance to prevent the dust or foreign substance from entering the appliance. Store the packaged appliance at a shaded place.

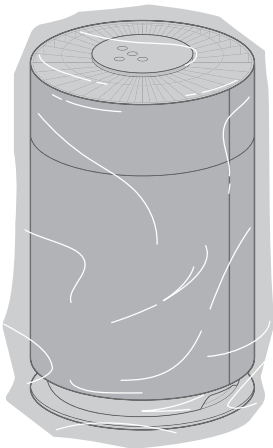

CAUTION

- Do not store the appliance at a humid place or at a place exposed to the direct sunlight. Otherwise the appliance may be deformed, malfunction or generate odor.

THINGS TO CHECK BEFORE REPORTING A MALFUNCTION

Diagnosing a Malfunction

Diagnosing the Cause of a Malfunction with the LG ThinQ Application

This feature will help you diagnose the problem.

✔ NOTE

- For reasons not attributable to LGE's negligence, the service may not operate due to external factors such as, but not limited to, Wi-Fi unavailability, Wi-Fi disconnection, local application store policy, or application unavailability.
- The feature may be subject to change without prior notice and may have a different form depending on where you are located.

Using LG ThinQ to Diagnose Issues

If you experience a problem with your Wi-Fi equipped appliance, it can transmit troubleshooting data to a smartphone using the **LG ThinQ** application.

- Launch the **LG ThinQ** application and select the **Smart Diagnosis** feature in the menu.
- Follow the instructions provided in the **LG ThinQ** application.

Troubleshooting

Before Calling for Service

Please check again for any of the symptoms below while using the product. Such symptoms may not be a sign of malfunction.

Operation

Symptoms	Possible Causes & Solution
The appliance does not operate.	Is the power plug unplugged from the outlet? <ul style="list-style-type: none"> Plug it into the outlet properly.
	Did the electricity get cut off? <ul style="list-style-type: none"> Check the power to other products in the house.
A noise occurs and the fan speed is low.	Is the ultra-fine filter clogged with dust? <ul style="list-style-type: none"> Clean the ultra-fine filter properly.
	Is the filter clogged with dust? <ul style="list-style-type: none"> Replace the filter.
Air purification is not done properly.	Is indoor air very dirty? <ul style="list-style-type: none"> Ventilate the indoor air before you use the product.
	Is the ultra-fine filter clogged with dust? <ul style="list-style-type: none"> Clean the ultra-fine filter properly.
	Is the filter clogged with dust? <ul style="list-style-type: none"> Replace the filter.
	Is the location too large for the capability of the air purifier? <ul style="list-style-type: none"> Use a product that fits the size of the room. Avoid well-ventilated places such as doors, windows, etc.
	Is there any obstacle nearby? <ul style="list-style-type: none"> Remove the obstacle before using the air purifier.
	Is the appliance installed in a corner? <ul style="list-style-type: none"> Move the appliance and install it again.
There is odor, but the air quality light doesn't change.	Is the air quality light red or orange? <ul style="list-style-type: none"> The color of the overall air quality light is determined by the worst level sensed, whether that is a PM concentration level or odor (gas) level. Check if the PM concentration level is worse than the odor level. Since the odor(gas) sensor is a sensor that detects contaminated gases, it may not react to the smell of food. But the Deodorizing Care filter removes the odor.
The air quality light stays red.	Move the appliance to a clean room and see if the color changes. <ul style="list-style-type: none"> If the odor level is beyond the capacity of the product to dispel, the air quality light may not change. Clean the PM1.0 sensor. Remove the power plug from the outlet and reconnect it one minute later.

Symptoms	Possible Causes & Solution
The air quality light stays red.	Did you use a spray near the product? <ul style="list-style-type: none"> Do not use sprays near the product.
The buttons on the control panel do not work.	Is  (Lock) displayed on the display panel? <ul style="list-style-type: none"> Press and hold the ionizer button for 3 seconds to unlock.

Odor

Symptoms	Possible Causes & Solution
A strange odor comes out from the air outlet as well as the filter.	Is it the odor you may experience after purchasing the appliance? <ul style="list-style-type: none"> The smell from activated charcoal is not harmful to human body. This is similar to the odor you may experience in a brand new car. The odor should dissipate after more than one day of use.
	Is the appliance used in an area with a lot of smoke or odors? <ul style="list-style-type: none"> If the air purifier is operated after an air freshener, diffuser, or scented candle has been used, or interior work or wallpaper replacement have occurred, the filter may absorb and emit an odor. Ventilate first, then use the appliance.
	Is an odor coming out from the filter? <ul style="list-style-type: none"> The filter replacement frequency may differ depending on the usage environment. If the odor is coming from the filter, replace the filter.
	Is it in an environment in which food is prepared? <ul style="list-style-type: none"> If you use the product for a long period of time where you cook or broil fish/meat, the filter lifespan may be significantly decreased. If possible, open a window for ventilation while cooking, and use the appliance to remove the remaining odor.
	Is it a humid environment? <ul style="list-style-type: none"> The filter may emit an odor if used in a humid environment. Dry the filter in sunlight before use.

LG ThinQ

Symptoms	Possible Causes & Solution
Your home appliance and smartphone is not connected to the Wi-Fi network.	The password for the Wi-Fi that you are trying to connect to is incorrect. <ul style="list-style-type: none"> Find the Wi-Fi network connected to your smartphone and remove it, then connect your appliance in LG ThinQ.
	Mobile data for your smartphone is turned on. <ul style="list-style-type: none"> Turn off the Mobile data of your smartphone and connect the appliance using the Wi-Fi network.
	The wireless network name (SSID) is set incorrectly. <ul style="list-style-type: none"> The wireless network name (SSID) should be a combination of English letters and numbers. (Do not use special characters.)
	The router frequency is not 2.4 GHz. <ul style="list-style-type: none"> Only a 2.4 GHz router frequency is supported. Set the wireless router to 2.4 GHz and connect the appliance to the wireless router. To check the router frequency, check with your Internet service provider or the router manufacturer.
	The appliance is too far from the router. <ul style="list-style-type: none"> If the appliance is too far from the router, the signal may be weak and the connection may not be configured correctly. Move the router closer to the appliance.

APPENDIX

Product Specifications

Specifications Guide

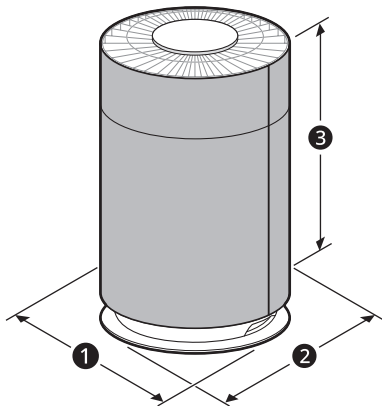

Name	Air Purifier
Power	AC 220-240 V, 50/60 Hz
External dimensions (1 x 2 x 3)	315 mm x 315 mm x 511 mm

**Please
Affix
Stamp
Here**

LG Electronics (S) PTE Ltd

Service Centre
No: 991D, Alexandra Road
#01-14
Singapore 119972

Warranty Card No : **CE**

LGE Service Centre's Copy

LG Electronics Singapore Pte Ltd

(Customer Service Centre)

No: 991D, Alexandra Road (Opposite PSA Building)

#01-14, Singapore 119972

MRT: Labrador Park station (Circle Line)

Tel: (65) 6512-0555 Fax: (65) 6479-5598

Operation Hours: Mon – Fri 0830-1800, Sat 0830-1400

Sun & P.H. closed

Website: www.lg.com/sg (Online warranty Registration)

(Please fill in the form in BLOCK letters)

(*are compulsory fields)

Invoice No: _____

Personal Information

*Name: _____

*Gender: MALE / FEMALE

*Address: _____

_____ *Postal Code _____

*Contact: (Home) _____ (Mobile) _____

*Email: _____

Personal Information

*Model _____ *Serial Number _____

*Purchase Date _____

DD/MM/YYYY

Dealer's Information

Note

- **Warranty is only valid with Dealer's Stamp & enclosed with a photocopy of the purchase receipt**
- **Warranty is only valid when form is duly filled & send to LGE within 14 days from original date of purchase**

Dealer's Stamp

Would you like to receive latest news and promotional updates from LG?

Yes ☐ No ☐

Warranty Card No: **CE****Customer's Copy**

LG Electronics Singapore Pte Ltd

(Customer Service Centre)

No: 991D, Alexandra Road (Opposite PSA Building)

#01-14, Singapore 119972

MRT: Labrador Park station (Circle Line)

Tel: (65) 6512-0555 Fax: (65) 6479-5598

Operation Hours: Mon – Fri 0830-1800, Sat 0830-1400

Sun & P.H. closed

Website: www.lg.com/sg (Online warranty Registration / E- appointment service)

Warranty Certificate**Personal Information**

*Name: _____

*Gender: MALE / FEMALE

*Address: _____

_____ *Postal Code _____

*Contact: (Home) _____ (Mobile) _____

*Email: _____

Personal Information

*Model _____ *Serial Number _____

*Purchase Date _____
DD/MM/YYYY**Dealer's Information****Note**

- 1 warranty card is applicable for only 1 product
- When service is required, please call our service centre & provide the following information: *Full Name *Address *Warranty Card No *Model & Serial No
- Please produce this card, together with original purchase receipt upon servicing

Dealer's Stamp

*** Warranty Period**

Air Purifier	1 year
Air Purifier Part	10 Years on Inverter Motor only (Except for Wearable Air Purifier, Puricare Mini, 360° Air Purifier Hit)

** Warranty coverage applies to brand new unit with proof of purchase invoice which is inclusion of display unit sold at dealer outlets.

*** With effect from July 2012, there will be no warranty for refurbished unit with bore a "REFURBISH" mark at the back of the product.

**** This warranty is valid only in respect of LG products purchased locally (in Singapore) & through authorized dealers agents with supporting Document (i.e. proof of purchase), otherwise the warranty is considered invalid.

OWNER'S RESPONSIBILITY

Please note that you will have to pay for attendance and correction of the under mentioned problems although the set is under warranty:

1. POWER – No power because power plug is not pushed in or power is not switched on or no power at points (check by using another appliance)
2. USER'S CONTROL – Not set according to Owner's Instruction Manual
3. Please log on to www.lg.com/sg for a list of self help answers for simple troubleshooting.

TERMS & CONDITIONS OF WARRANTY

- 1 This appliance is guaranteed for periods as specified respectively above in respect of service and manufacturing faults and defective materials and parts from the date of registered purchase: and LG Electronics (S) Pte Ltd guarantees the following.
 - 1.1 The sales receipt or purchase invoice showing the date of purchase of the Product, showing the serial number and date of purchase by showing the sales receipt/ purchase invoice. This warranty extends only to the original purchaser, and is non-transferable to anyone who subsequently purchases, leases or otherwise obtains the product from the original purchaser.
 - 1.1.1 Servicing will provided free of charge for period specified above from the date of purchase.
 - 1.1.2 Service will provided only during normal business hours and under safety condition and circumstances.
 - 1.1.3 The warranty does not cover demonstration / installation of the product purchase.
 - 1.1.4 Transportation, delivery and handling charges incurred in the transport of Product to and from LG or its authorized service centre will be borne by the Consumer.

- 1.2 Defective parts will be replaced free of charge if the defect is reported within the specified period from date of registered purchase.
- 1.2.1 Defective inverter motor will be replaced free of charge if defect is reported within 10 years from date of registered purchase. Labour charges, however, be borne by the purchaser.
- 2 Notwithstanding anything contained herein, LG Electronics (S) Pte Ltd shall not be responsible or liable for any of the following:
 - 2.1 Damage or malfunction caused by the act or acts of any person or persons intentional or otherwise, including but not limited to misuse or mishandling, fire or any act of God.
 - 2.2 Defects or fault in **Home Appliances** which have been used for **commercial purposes** or which have been rented/ leased or which have been otherwise subject to other than household use.
 - 2.3 Damaged or missing parts which are reported more than one week from the date registered purchase.
 - 2.4 Damage / malfunction to accessories including but not limited to remote control units, antennas, LID or battery covers, casing, plastics panels, control knobs, electrical plugs and cables, and/ or other detachable parts.
 - 2.5 Damage or malfunction caused by improper or incorrect installation, poor or inadequate maintenance, or use or operation of the appliance otherwise than in accordance with the manufactures' instructions, for example, subjecting the appliance to excessive electrical voltage.
 - 2.6 Home servicing of portable appliances.
 - 2.7 Normal wear and tear, corrosion, rust, stains, scratches, dents on the body or casing or paintwork of the appliance.
 - 2.8 Any damage to property including but not limited to arising from or in connection with the use of the appliance or any malfunction of defect in the appliance.
 - 2.9 The cost of providing access to any appliance by whatever means necessary for purpose of carrying out repairs or servicing in the event that the location or position at which the appliance is installed is such that there is no reasonable access to the appliance for such repairs or servicing to be carried out.
 - 2.10 Any damage to property caused in the process of carrying out repair or servicing of appliance which are installed in positions or locations which make it difficult or unreasonable for such damage to be avoided.
 - 2.11 Damages caused during transit where appliance is transported for the purpose of servicing or repair, or in relation thereof or in connection therewith.

- 2.12 Damages for loss of use due to any malfunction, defect, damage or breakdown of the appliance.
- 2.13 LG strongly recommends that separate permanent written records be kept of all important date. Data may be lost or altered in virtually any electronic memory product under certain circumstances. Therefore, LG assumes no responsibility for data lost rendered unusable whether as a result of improper use, repairs, defects, battery replacement, use after the specified battery life has expired, or any other cause.
- 2.14 All the rights of the warranty will be void and null if serial number has been altered, effaced or removed.
- 3 This warranty shall exclude request pertaining to all refund, replacement or exchange.
- 4 It is hereby expressly provide that any liability of LG Electronics (S) Pte Ltd for any loss or damage whatsoever arising from, relating to or in connection with the purchase of the appliance shall not exceed the purchase price (excluding installation costs) of the appliance. Similarly, LG Electronics (S) Pte Ltd's liability for any breach of this guarantee shall be limited to the purchase price (excluding installation costs) of the appliance.
- 5 This guarantee is valid only in the mainland of the Republic of Singapore.
- 6 This guarantee shall not apply in respect of any appliance which has been tampered with, or which has undergone repair, adjustment or servicing by persons other than those authorized by LG Electronics (S) Pte Ltd to do so.
- 7 Replacement Units and Repair Parts may be new or factory remanufactured.
- 8 The terms of this guarantee shall not be varied except with the written and express consent or agreement of LG Electronics (S) Pte Ltd.
- 9 While LG Electronics (S) Pte Ltd endeavours to repair any defect after the warranty period, it is subject to availability of parts from the manufacturers.

MEMO

MEMO

MEMO



使用者手冊

空氣清新機

為了安全輕鬆地使用本產品，請於使用前細閱手冊。

請妥善保管隨附的保用證。

本電器為僅供在家使用的室內家用電器。

請勿將此電器用於商業、試驗或工業用途。

AS60GH 系列

HK HONGKONG

目錄

安全說明

- 04 請在使用產品前閱讀
- 04 安全符號及其含義
- 04 警告
 - 04 家中的兒童
 - 04 操作電源插頭和電源線時
 - 05 安裝產品時
 - 06 使用產品時
 - 07 以防萬一
- 07 注意
 - 07 安裝產品時
 - 07 使用產品時

使用 LG ThinQ

- 09 LG ThinQ 應用程式
 - 09 LG ThinQ 應用程式功能
 - 09 使用 LG ThinQ 應用程式前
 - 10 安裝 LG ThinQ 應用程式
 - 10 開放源碼軟體通知資訊

概觀

- 11 探索產品外觀
 - 11 空氣清新機
 - 12 濾網
 - 13 組件
- 14 安裝和準備就緒
 - 14 撕下濾網的保護膜
 - 15 選擇安裝位置
 - 15 攜帶本產品時

使用

- 16 探索控制面板
- 16 使用控制面板
- 18 使用空氣清新機的基本功能
 - 18 開/關
 - 18 調節風扇轉速
- 18 使用空氣清新機的其他功能
 - 18 使用 Sleep Mode
 - 19 鎖定控制面板
 - 19 使用 Ionizer
- 20 整體空氣質量
 - 20 了解整體空氣質量

維護

- 21 清潔
 - 21 清潔外側
 - 21 清潔 PM1.0 感測器
 - 21 清潔和更換濾網的頻率
 - 22 清潔濾網
 - 22 更換濾網
- 23 存放
 - 23 存放產品

本手冊可能包含與您購買的型號不同的圖像或內容。
本手冊可能被製造商修訂。

報告故障前需要檢查的事項

- 24 診斷故障
- 24 透過 LG ThinQ 應用程式診斷故障的原因
- 25 疑難排解
- 25 在調用服務前
- 25 操作
- 26 氣味
- 27 LG ThinQ

附錄

- 28 產品規格
- 28 規格指南

安全說明

請在使用產品前閱讀

以下「安全說明」旨在預防預期風險或損害，因此務必仔細閱讀。

「安全說明」分為「警告」和「注意」。

安全符號及其含義

 此圖形符號用於提醒使用者注意可能引致風險的事宜和操作。
請仔細閱讀標有此符號的文字，並遵循說明以規避風險。

 **警告**
如若不遵循該標誌指示則可能會導致重傷或死亡。

 **注意**
如若不遵循該標誌指示則可能會導致輕微受傷或產品損壞。

一般使用者可使用此電器。

警告

警告

- 這表示，如若不遵循該標誌指示則可能會因火災或電擊導致重傷或死亡。

家中的兒童

- 身體、感知或心理能力較弱者或缺乏經驗及知識的人群（包括兒童）不宜使用本電器，除非有負責其安全的人員給予有關使用本電器的監督或指引。請看管好兒童以免視本電器為玩具。

操作電源插頭和電源線時

禁令

- 請勿用濕手觸摸電源插頭。

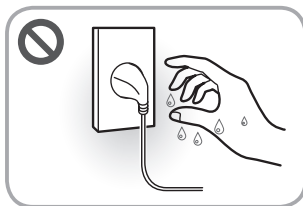

- 請勿損壞電源插頭或電源線。請勿損壞、拉伸電源線，將電源線置於高溫附近，過度彎摺、扭曲電源線，在電源線頂部放置重物，或將電源線打結。
- 請勿將電源插頭連接至無接地線的多孔插座（連接型）、插塞式適配器、或其他配件。
- 請勿產品背面按壓電源插頭或將其向後插。

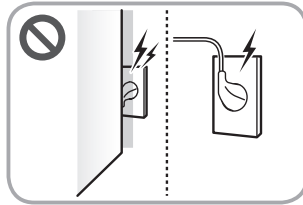

- 清潔電器或更換濾網之前，請將電器關機並拔下插頭。
- 請勿反復連接和斷開電源插頭。
- 請勿在操作期間拔下插頭。

○ 合規

- 本電器僅用於 220-240 V。務必將電源插頭連接至帶接地端子的 220-240 V 插座。
- 若您要使用多孔插口延伸插座，請使用帶電流量 20A 或以上的接地端子的多孔插口延伸插座(便携式)。如使用拖板(延長分插線)，請僅連接本產品使用。
- 當安裝新的電器時，請盡可能使用新購買的多孔插口延伸插座，並定期檢查導線外皮和插頭連接的狀況。
- 若電源插頭上有濕氣或灰塵，請將其完全清除，然後再穩穩插入插座。
- 若要拔掉電源線，請始終握住插頭將其拉出。
- 遭遇打雷或閃電，或長期不使用本產品時，請將電器的電源插頭拔下。
- 不要讓寵物咬電源線。
- 若濕氣進入產品，請斷開電源插頭連接，並聯絡 LG 電子客戶服務中心。
- 若電源線或電源插頭受損，或電源插座的孔變鬆，則立即停止使用產品，並聯絡 LG 電子客戶服務中心。

安裝產品時

⊗ 禁令

- 請勿在以下場所安裝電器：
 - 有水或雨水的地方，或高濕度的地方。
 - 陽光直射下的地方，或有加熱電器的地方。
 - 有大量灰塵或溫度急劇變化的地方（戶外、乙烯基溫室等）
 - 存在易燃氣體洩漏或有大量工業油或金屬粉塵的地方
- 僅限來自 LG 電子客戶服務中心的授權維修人員拆卸、維修或改動本電器。

○ 合規

- 在可以輕鬆從電源插座拔下插頭的地方安裝產品。
- 安裝後立即丟棄包裝材料（乙烯產品、泡沫塑料等）。兒童在玩耍這些包裝材料時可能存在窒息危險。

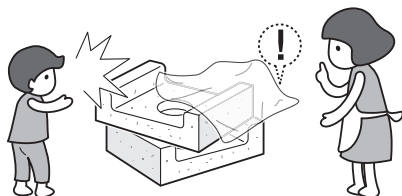

使用產品時

⊘ 禁令

- 請勿在連接電源期間移動產品。
- 請勿將易燃物放入產品內。
- 請勿使用受損的組件。
- 若蓋子打開，請勿運行本電器。
- 運行過程中，請勿強行打開進氣口或出氣口，或將手指或任何異物（棍棒、別針等）插入進氣口或出氣口。
- 請勿用濕手操作本電器。
- 請勿將您的手或任何異物放入產品內或在產品上噴水。
- 請勿將電源線放在墊子下方。
- 請勿在火焰、可燃物（乙醚、苯、酒精、藥物、液化石油氣、可燃噴霧、殺蟲劑、空氣清新劑、化妝品等）或易燃材料（蠟燭、電燈等）附近使用或存放本產品。

○ 合規

- 清潔電器前拔下電器插頭。
- 注意不要讓產品受到強烈衝擊或翻倒。
- 請勿讓動物或寵物咀嚼電源線。

以防萬一

○ 合規

- 若您發現有任何異常噪音、氣味或煙霧，請立即拔下本產品的插頭，並聯絡 LG 電子客戶服務中心。
- 若電器浸入水中，請停止使用並聯絡 LG 電子客戶服務中心。
- 若有漏氣（異丁烷、丙烷與液化天然氣等）現象，請勿碰觸本產品或電源插頭，並立即讓該區域通風。

注意

注意

- 不遵循該說明則可能會導致輕微受傷或產品損壞。

安裝產品時

⊘ 禁令

- 請勿將電器安裝在不穩定的地方或激烈振動的地方。
- 請勿在使用者視線以上安裝電器。
- 請勿將電器安裝在房車、船舶或飛機上。
- 搬運時，請勿傾斜本電器以方便拖拽或推拉。
- 請勿將電器放置在電視機或立體聲電器附近。
- 請勿將電器放置在強光下。
- 請勿在有爆炸風險的位置安裝或使用產品。

○ 合規

- 將電器安裝在地面堅硬且無門檻的水平空間內。

使用產品時

⊘ 禁令

- 請勿將異物插入電器或感測器孔中或向其噴水。
- 請勿將本產品用於去除一氧化碳等有毒氣體。
- 請勿將本產品用於通風目的。
- 請勿將障礙物放置在進氣口或出氣口附近。

- 請勿在窗簾附近使用電器。
- 請勿將電器用於特殊目的或區域，如動植物、精密儀器或藝術品等的維護。
- 請勿在未直立放置的狀態下使用電器。
- 請勿在易因熱受損的物體附近使用電器。
- 請勿將濾網用於電器預期用途之外的目的。
- 請勿在電器中使用洗滌劑、化妝品、化學品、空氣清新劑或消毒劑。
- 請勿使用強力洗滌劑或溶劑清潔本產品。
- 請勿將咖啡、花瓶或其他飲料放在電器頂部。
- 請勿將磁體或金屬物體放在電器頂部。
- 請勿讓電器遭受衝擊。
- 請勿讓加濕器中的水分直接接觸電器。

○ 合規

- 注意不要在電器頂部放置物體或液體。
- 請勿讓兒童爬上電器，也不要讓電器因過大衝擊而傾翻。
- 請勿使用研磨性或金屬制成的刷子、布條或海綿清潔電器。使用柔軟的超細纖維布清潔產品。
- 在移除產品組件和/或重新組裝產品組件時，注意不要讓身體部位卡入產品。

使用 LG ThinQ

LG ThinQ 應用程式

通過 LG ThinQ 應用程式，您可使用智慧型手機向本設備發出指令。

LG ThinQ 應用程式功能

Smart Diagnosis

如在使用本設備時遇到問題，本 Smart Diagnosis 功能可幫助進行問題診斷。

設置

您可以在本設備及應用程式中設定各項功能。

✔ 附註

- 如您變更了無線路由器、網際網路服務提供者或密碼，請從 LG ThinQ 應用程式中刪除已連接的設備，然後再次連接。
- 該機器為進行改良而變更時，恕不通知使用者應用程式變更事宜。
- 功能依各型號而有不同。

使用 LG ThinQ 應用程式前

本功能僅適用於帶有 Wi-Fi 功能的型號。

- 1 檢查本設備與無線路由器（Wi-Fi 網路）之間的距離。
 - 如設備距離無線路由器相當距離，訊號強度會減弱。連接可能耗時很長，或可能安裝失敗。
- 2 關閉智慧型手機上的行動數據或手機資料。

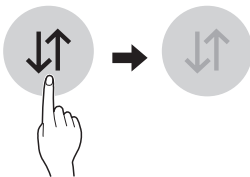

- 3 將智慧型手機連接您的無線路由器。

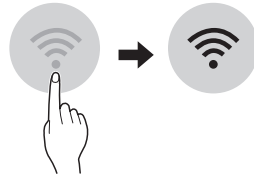

✔ 附註

- 如要確認 Wi-Fi 連線，請檢查狀態顯示器上的 Wi-Fi 圖示是否亮起。
- 本設備僅支持 2.4 GHz Wi-Fi 網路。若要檢查您的網路頻率，請聯絡網際網路服務供應商或參閱您的無線路由器手冊。
- LG ThinQ 對於任何網路連線問題或網路連線造成的任何失效、故障或錯誤，概不負責。
- 如果設備無法連線至 Wi-Fi 網路，則可能是離路由器太遠。請購買 Wi-Fi 中繼器（網路信號加強器），改善 Wi-Fi 訊號強度。
- 由於家庭網路環境的差異，Wi-Fi 連線可能會中斷或受到干擾。
- 依據網際網路服務提供商，網路連線可能無法正常作業。
- 周圍的無線環境可能導致無線網路服務速度緩慢。
- 如若設備因無線訊號問題無法連接，請拔掉設備的電源，等待一分鐘左右後重新嘗試連接。
- 如若您已啟用無線路由器的防火牆，請停用防火牆或在其中新增其他。
- 無線網路名稱（SSID）應為英文字母和數字的組合。（請勿使用特殊字元。）
- 智慧型手機使用者介面（UI）因手機操作系統（OS）及製造商的而定。
- 如路由器的安全協議設為 WEP，網路設置可能失敗。請更換安全協議設（建議使用 WPA2），並再次連接本產品。

安裝 LG ThinQ 應用程式

在智慧型手機上，透過 Google Play Store 或 Apple App Store 搜尋 LG ThinQ 應用程式。

依照說明，下載並安裝應用程式。

開放源碼軟體通知資訊

欲獲得 GPL、LGPL、MPL 及其他有義務公開包含本產品內容原始程式授權的源代碼，及存取所有提及授權條款、版權聲明及其他相關文件，請瀏覽 <https://opensource.lge.com>。

LG Electronics 也可應您要求，在由您支付相關費用（如媒體成本、運費及處理費）的條件下以 CD-ROM 方式提供開放原始程式碼，如有需要請寄送電子郵件至 opensource@lge.com。

該產品最後一次出貨的三年內，任何收到此資訊的人可享此優惠。

概觀

探索產品外觀

空氣清新機

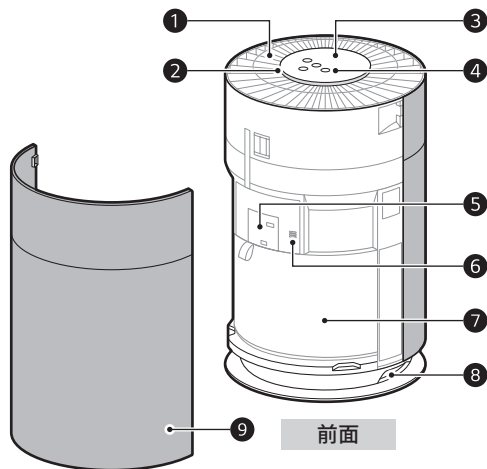

- ❶ 出氣口
 - 淨化後的空氣從濾網排出。
- ❷ 空氣質量指示燈
 - 目前的空氣質量用顏色來指示（綠色、黃色、橙色、紅色）。
- ❸ 顯示面板
 - 利用它來檢查產品的設定與空氣狀況。
- ❹ 控制面板
 - 利用它來設定電器功能。
- ❺ PM1.0（直徑為 1.0~2.5 微米的顆粒物）感測器
 - 利用它來檢測粉塵濃度。
- ❻ 氣味（氣體）感測器
 - 利用它來檢測氣味和氣體。
- ❼ 濾網
 - 大幅減少 PM2.5、產生煙霧的物質、令人作嘔的居室症候群物質和室內氣味。
- ❽ 把手
 - 用於握住把手並移動電器。
- ❾ 進氣口
 - 前蓋和後蓋可以分開。

濾網

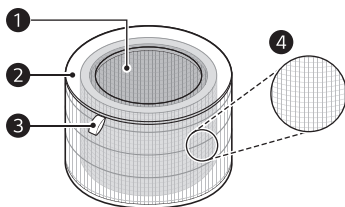

❶ 除臭濾網

- 利用它來消除產生煙霧的物質（ SO_2 、 NO_2 ）、令人作嘔的居室症候群物質（甲苯、甲醛）和室內氣味（氨、醋酸、乙醛）。

❷ 全效防敏濾網

- 大幅減少 $\text{PM}_{2.5}$ 。

❸ 濾網把手

- 利用它來將濾網插入產品或從產品取出濾網。
- 讓有把手的一側朝上。

❹ 超細濾網

- 超細濾網連接至濾網的外表面，主要從空氣移除大顆粒的活性灰塵。

⚠ 注意

- 濾網已連接，因此不要用力分離濾網。
- 請勿亂扔濾網或將其用於其他目的。

✔ 附註

- 購買後開始使用時，新濾網可能發出輕微的氣味。本產品運轉一天後氣味就會消失，請放心使用。
- 濾網清潔和更換頻率可能視使用環境和使用持續時間而異。
- 濾網可以使用長達 1 年。室內空氣的污染程度越高，濾網的使用壽命越短。
- 若室內氣味過大，首先讓室內通風，除去氣味和氣體，然後使用電器消除剩餘的氣味。
- 若空氣清新機長時間未使用並因此產生氣味，您可以透過在通風良好的地方高速運行空氣清新機，從濾網減少此類氣味。
- 當在潮濕環境中連續使用或加濕器中的水分被濾網吸收時，濾網可能會散發出氣味。若濾網因水分而存在氣味，則僅在陽光下充分乾燥後使用濾網。
- 一氧化碳（CO）是有害氣體，主要從室外飄入，且無法透過濾網消除。
- 電器運行時須保持門窗關閉。然而，如果您長時間在一個封閉的空間內使用本電器，二氧化碳的濃度可能會升高。請確保定期進行室內通風。
- 空氣清新機的除臭功能利用濾網濾除空氣中的氣味和氣體。若在氣味過大的室內長時間使用本產品，濾網性能可能會大幅下降。
- 若濾網因吸收了周圍的氣味並且產品在運行時產生異味，即需更換濾網。濾網更換的費用不包含在保養範圍內。如需購買新濾網，請聯絡 LG 電子客戶服務中心或進入網站 www.lg.com。

組件



❶

❶ 使用者手冊

安裝和準備就緒

撕下濾網的保護膜

- 1 打開電器包裝，撕下所有的包裝膠帶和濾網乙烯基塑料，然後再使用電器。
- 2 握住帶 LG 標誌的產品前蓋頂端，輕輕拉扯進行分離。

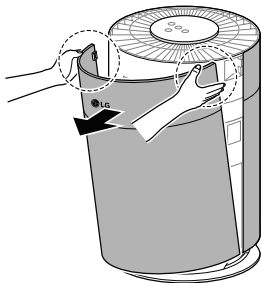

- 3 拆卸濾網並移除乙烯基塑料。

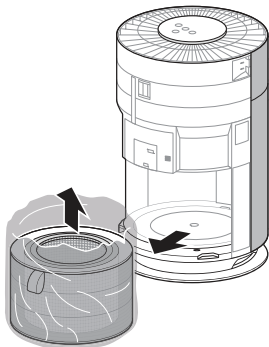

- 4 讓連接濾網把手的一側朝上，將濾網安裝到電器中。

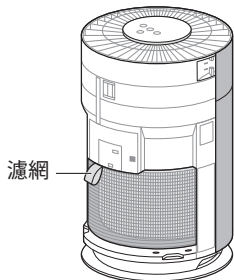

- 5 將蓋子底部的固定部分插入產品底部的固定凹槽，然後合上蓋子。

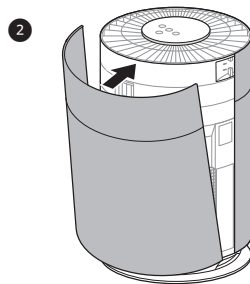
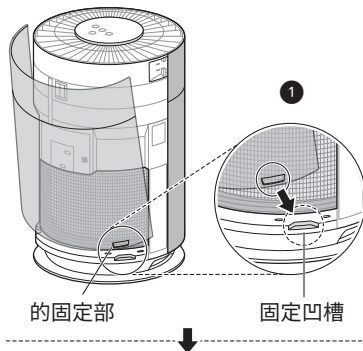

⚠ 注意

- 使用本產品前，請務必移除乙烯基塑料。
- 安裝時要注意濾網的方向。

選擇安裝位置

- 離牆壁 1 米安裝電器。
 - 如果沒有足夠空間供空氣進入，可能會導致空氣清新機性能下降。

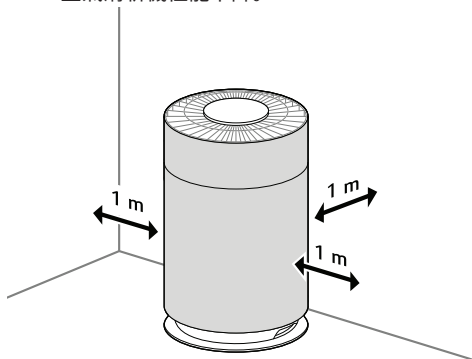

- 電器性能可能根據使用環境（溫度、濕度等）而不同。
 - 電器在濕度介於 40% 至 70% 的環境中提供有保證的性能。
- 請勿在陽光直射的地方或者靠近強光燈具的地方安裝產品。

攜帶本產品時

- 在搬運或存放電器時，應將電源線繞在產品底部，以防止電源線在地板上拖拽。
 - 否則可能會損壞電源插頭或在地板上留下劃痕。
- 不要以握住外蓋的方式攜帶產品。
 - 這樣做可能導致蓋被打開，並使產品跌落。電器墜落可能會導致人身傷害或產品故障。

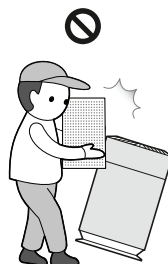

- 雙手握住產品底部的把手，安全運送產品。

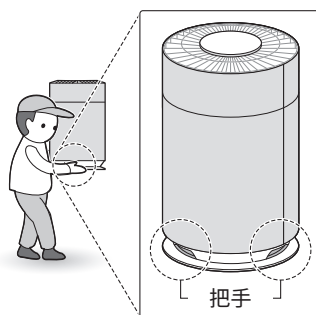

使用

探索控制面板

使用控制面板

控制面板

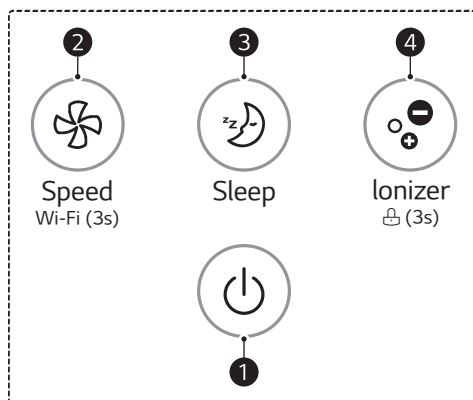

❶ 開/關鍵

開啟和關閉產品。

❷ Speed 按鈕

設定產品的風扇轉速

- 按住此按鈕 3 秒時，產品將準備連接至 Wi-Fi。

❸ Sleep 按鈕

可定或取消 Sleep Mode。

❹ Ionizer 按鈕

按下此按鈕可以釋放離子並消除室內空氣中的各種細菌。

- 您可按住此按鈕 3 秒，以鎖定或解鎖控制面板。

顯示面板

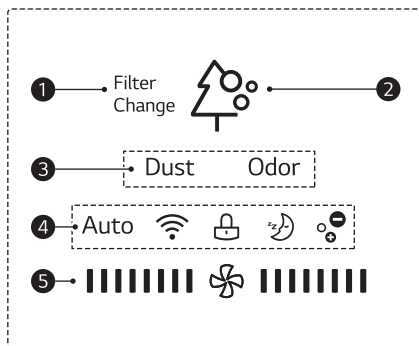

① 濾芯更換指示

在需要更換濾芯時顯示。

② 整體空氣質量

使用顏色（綠色、黃色、橙色、紅色）指示整體空氣質量。

→ 請參閱「了解整體空氣質量」，了解詳細的顏色資訊。

③ 灰塵/異味顯示

Dust：在粉塵濃度高於氣味濃度時顯示。

Odor：在氣味濃度高於粉塵濃度時顯示。

- 在粉塵濃度與氣味濃度相同時同時顯示。

④ 圖示

圖示		說明
Auto	自動清潔	在風扇轉速設為 Auto 時亮起。
	Wi-Fi	在 Wi-Fi 功能啟動時亮起。
	鎖定	在控制面板鎖定時亮起。
	Sleep	在 sleep mode 啟動時亮起。
	Ionizer	在離子發生器功能啟動時亮起。

⑤ 風扇轉速指示

將顯示空氣清新機的風扇轉速。

使用空氣清新機的基本功能

開/關

開啟和關閉產品。

- 按開/關鍵。

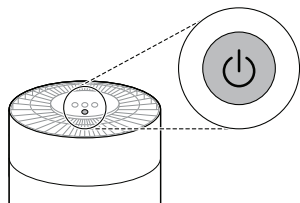

附註

- 如果由於電源故障而切斷電源，則會記住最近使用的模式。
- 開始操作時，將顯示感測器就緒約 30 秒。

調節風扇轉速

您可以從空氣清新機調節風扇轉速。

1 按開/關鍵打開產品。

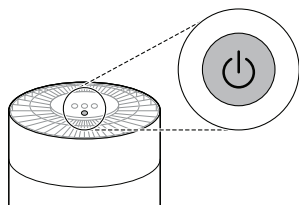

2 要調節風扇轉速，按 Speed 按鈕。

- 在产品運行期間按此按鈕時，風扇轉速將按 Auto → Low → Medium → High → Turbo 的順序變化。

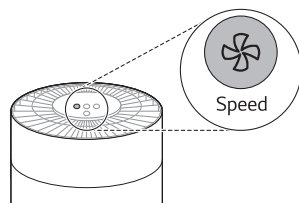

附註

- 首次開始運行時，Auto 將被設為風扇轉速。在自動模式下，根據室內空氣的污染程度自動調節風扇轉速。
- 調節風扇轉速時，顯示面板上會顯示風扇轉速。風扇轉速的指示每次增加 2 欄。當風扇轉速設為 Medium 時，將顯示如下。



使用空氣清新機的其他功能

使用 Sleep Mode

您可以在去睡覺時的安靜環境中使用空氣清新機。

1 按開/關鍵打開產品。

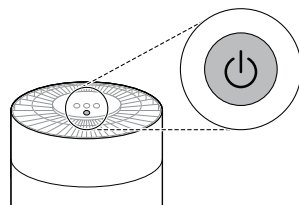

2 按 Sleep 按鈕。

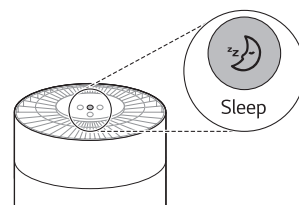

✔ 附註

- 顯示面板上顯示 sleep mode 圖示。
- 除了睡眠顯示外，全部顯示都將關閉。
- 在 sleep mode 下，風扇轉速設為「低」，在一段時間後，風扇轉速將根據室內空氣的污染程度重設為「低」或「中等」。
- 在 sleep mode 啟動後，可以按 Speed 按鈕來調節風扇轉速。
- 您無法單獨在 sleep mode 下設定運行時間。要取消 sleep mode，以設定的相同方式按 Sleep 按鈕。

鎖定控制面板

由於某些不可預見的原因（例如兒童觸碰按鈕），您可以鎖定控制面板上的按鈕來阻止電器運行。

- 按住 Ionizer 按鈕 3 秒或以上。
-  設定鎖定功能時，顯示面板上會顯示。

✔ 附註

- 您可以按與打開時相同的方式關閉鎖定功能。
- 您還可在停止運行時鎖定或解鎖。

使用 Ionizer

產生離子來最大限度清除空氣中的各種細菌。

1 按開/關鍵打開產品。

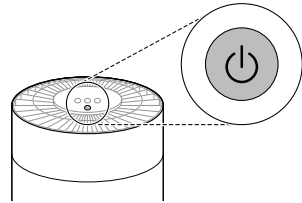

2 按 Ionizer 按鈕。

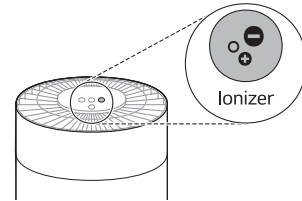

✔ 附註

- 本產品可能因 Ionizer 而產生臭氧，因此建議在長時間使用本產品時進行通風。

整體空氣質量

了解整體空氣質量

整體空氣質量是根據顆粒物和氣味（氣體）的濃度計算出來的，並且可依據空氣的污染程度分為 4 個等級，包括綠色、黃色、橙色或紅色。

顏色	整體空氣質量	PM 濃度 (µg/m ³)			氣味濃度	
	狀態	PM10 (粗顆粒物)	PM2.5 (細顆粒物)	PM1.0 (直徑介於 1.0 至 2.5 µm 之間的顆粒物)	狀態	等級
紅色	較差	255 或以上	56 或以上	56 或以上	非常強	4
橙色	不健康	155 ~ 254	36 ~ 55	36 ~ 55	強	3
黃色	中等	55 ~ 154	13 ~ 35	13 ~ 35	正常	2
綠色	良好	54 或以下	12 或以下	12 或以下	弱	1

✔ 附註

- 整體空氣質量的顏色根據粉塵濃度及氣味（氣體）濃度之最差水平確定。
- LG 電子產品的粉塵濃度水平，是在使用光學方法測量粉塵數量並將測量值轉化成 PM10 濃度後表示的結果。
- 整體空氣質量等級是 PM 濃度和氣味等級共同的結果。
- 無論是不同產品還是同一產品在同一空間內使用，由於空氣流通情況不同，濃度測量值可能會有所不同。
- 與氣味（氣體）不同，細塵（PM10）緩慢擴散，因此測量粉塵濃度的時間可能會延遲。
- PM1.0 感測器附近的氣流可能中斷 PM1.0 感測器的正常運行，因此所指示的濃度可能與實際濃度不同。
- 在以下環境中使用產品時，測得的濃度可能與實際濃度不同。
 - 靠近布藝沙發和床、毛地毯周圍、鋪床/疊衣服期間、使用吸塵機期間、有蟲子和寵物的地方、濕度高的地方
 - 建築工地、路邊、工廠等室外空氣流通的場所，或室外門窗、通風口附近
 - 使用會產生蒸氣或細顆粒物的產品（加濕器、廚房用具或噴霧器）的地方
 - 感測器可能無法檢測因地毯除塵或清潔等活動產生的大於 PM10 的顆粒物，但會被濾網清除。
- 氣味（氣體）濃度可能因散發氣味的物品（例如空氣清新劑、除臭劑、清潔劑、化妝品或香水）而異。
- 您可以透過 LG ThinQ 應用程式檢查粉塵濃度。

維護

清潔

清潔外側

- 1 使用吸塵機除去進氣口和出氣口的粉塵。
- 2 用柔軟的布擦拭外部。

警告

- 清潔或更換濾網前，先將電器關閉並拔掉電源。
- 請勿直接在產品上灑水。

注意

- 請勿用鹼性清潔劑清洗電器。
- 請勿用硫酸、鹽酸或有機溶劑（稀釋劑、煤油等）擦拭電器表面，或在電器上貼標籤。這樣可能會毀損電器表面。
- 切勿讓水進入產品內。

附註

- 如果您難以清除前後蓋上的粉塵，請卸下濾網並使用清水進行清洗。然後，在陰涼處完全晾乾。

清潔 PM1.0 感測器

PM1.0（直徑為 1.0~2.5 微米的顆粒物）感測器是檢測細塵和較大粉塵污染程度的裝置，因此必須定期（至少每 2 個月一次）清潔鏡頭。

- 1 將帶 LG 標誌的前蓋與產品分開。

- 2 打開感測器蓋。

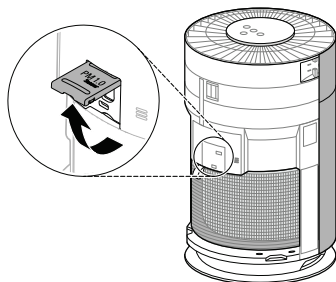

- 3 用沾水的棉棒清潔鏡頭並再次用一根乾的棉棒清潔一遍。

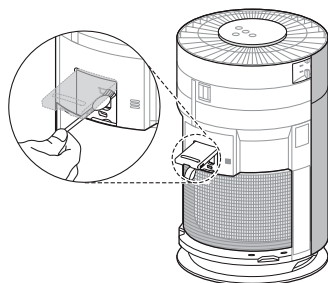

附註

- 請勿用水以外的任何物質擦拭感測器。這可能導致故障。

清潔和更換濾網的頻率

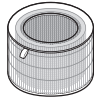
類型	清潔頻率	更換頻率
 濾網	超細濾網 按需要清潔濾網	1 年

附註

- 清潔頻率可能根據電器的操作時間和環境而異。
- 如不依照清潔頻率對產品進行清潔，您可能會聞到異味並且產品性能會下降。

✔ 附註

- 濾網是一種耗材項。因此，您必須購買新品來更換已達到壽命期限、仍在保養期內的產品。如需購買新濾網，請聯絡附近的 LG 電子客戶服務中心或進入網站 (www.lg.com)。
- 您也可將濾網交由 LG 電子客戶服務中心進行清潔或更換。
濾網清潔及更換服務是收費項目。

清潔濾網

- 1 分開產品的前後蓋。
- 2 使用真空吸塵機或軟刷，清除超細濾網上的顆粒物。

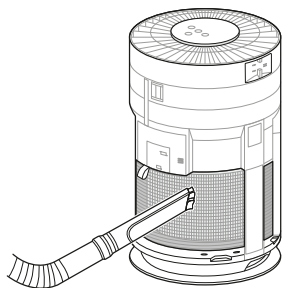

⚠ 注意

- 請勿用水清洗濾網。濾網的使用壽命可能會縮短。
- 請注意在使用真空吸塵機時不要損壞超細濾網。

更換濾網

當顯示面板上顯示濾網更換提示時，請更換濾網。

- 1 將蓋從產品分離，然後更換濾網。
 - 在更換濾網時，為了避免污染環境，請在您移除濾網之前在地板上鋪上一張報紙。
- 2 更換濾網後，停用濾網更換提示。

✔ 附註

- 根據最長使用時間並考量產品運行時長會出現濾網更換提示。將根據運行時長和環境決定更換頻率。

停用濾網更換提示

同時按住 Sleep 按鈕和 Ionizer 按鈕 3 秒。

- 顯示面板上的濾網更換提示將被停用，更換警報將重設。

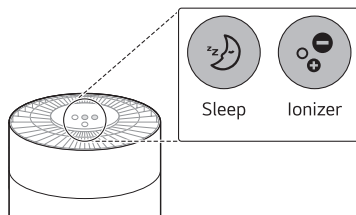

更換超細濾網

檢查超細濾網的魔術貼，並緩慢分開以更換超細濾網。

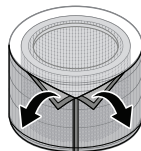

存放

存放產品

如長時間沒有使用產品，請將它放置在陰涼、乾爽的地方。

- 1 在好天氣的情況下操作產品一小時或以上。
 - 這樣可以去除水分，並阻止黴菌在產品內部堆積。
- 2 關閉電源並將電源插頭從電源插座上拔出。
 - 將電源線繞在電器的底部。
- 3 包裝電器以防止灰塵或異物進入電器。將包裝的電器存放在陰涼的地方。

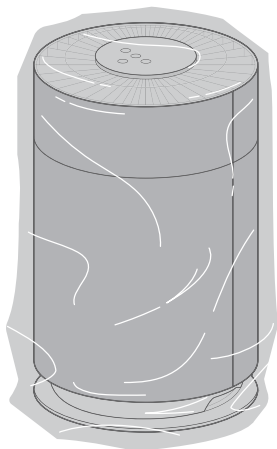

注意

- 請勿將電器存放在潮濕位置或陽光直射的地方。否則電器可能會變形、發生故障或產生異味。

報告故障前需要檢查的事項

診斷故障

透過 LG ThinQ 應用程式診斷故障的原因

此功能將幫助您診斷問題。

✔ 附註

- 出於與 LGE 的過失無關的原因，此服務可能由於外部因素而無法運行，例如但不限於 Wi-Fi 不可用、Wi-Fi 斷開連接、本地應用商店政策或應用程式不可用。
- 此功能可能會隨時更改，恕不另行通知，並且根據您所在的地區，其形式可能會有所不同。

使用 LG ThinQ 診斷問題

如果您的具備 Wi-Fi 功能的電器出現問題，其可使用 LG ThinQ 應用程式將疑難排解數據傳輸至智能手機。

- 啟動 LG ThinQ 應用程式，然後在選單中選擇智能診斷功能。
- 遵循 LG ThinQ 應用程式中的說明。

疑難排解

在調用服務前

請在使用產品期間再次檢查以下任何現象。

此類現象可能不是故障的跡象。

操作

現象	可能的原因和解決方法
電器不工作。	<p>電源插頭是否已從插座拔出？</p> <ul style="list-style-type: none"> 將電源插頭正確地插入電源插座內。 <p>是否斷電？</p> <ul style="list-style-type: none"> 檢查室內其他產品的電源。
出現噪音，風扇轉速低。	<p>超細濾網是否被灰塵堵塞？</p> <ul style="list-style-type: none"> 正確清潔超細濾網。 <p>濾網是否被灰塵堵塞？</p> <ul style="list-style-type: none"> 更換濾網。
未正確完成空氣淨化。	<p>室內空氣非常骯髒？</p> <ul style="list-style-type: none"> 在使用本產品前，請先保持室內空氣流通。 <p>超細濾網是否被灰塵堵塞？</p> <ul style="list-style-type: none"> 正確清潔超細濾網。 <p>濾網是否被灰塵堵塞？</p> <ul style="list-style-type: none"> 更換濾網。 <p>位置對於空氣清新機的能力而言太大？</p> <ul style="list-style-type: none"> 使用適合房間大小的產品。 避免在通風良好處（如門窗等附近）使用。 <p>附近是否有任何障礙物？</p> <ul style="list-style-type: none"> 使用空氣清新機前移除障礙物。 <p>本電器是否安裝在角落裏？</p> <ul style="list-style-type: none"> 移動電器並再次安裝。
存在異味，但空氣質量指示燈未改變。	<p>空氣質量指示燈是紅色還是橙色？</p> <ul style="list-style-type: none"> 整體空氣質量指示燈的顏色取決於所感測到的最差水平，無論是 PM 濃度還是氣味（氣體）。檢查 PM 濃度是否差於氣味水平。 由於氣味（氣體）感測器是一種檢測受污染氣體的儀器，因此它可能不會對食物的氣味作出反應。但除臭濾網可去除異味。
空氣質量指示燈保持紅色。	<p>將電器移至清潔房間，查看顏色是否改變。</p> <ul style="list-style-type: none"> 如果氣味水平超出了產品的驅散能力，則空氣質量指示燈可能不會改變。 清潔 PM1.0 感測器。 將電源插頭從電源插座上移除並在一分鐘後重新連接。

現象	可能的原因和解決方法
空氣質量指示燈維持紅色。	您是否在本產品周圍使用噴霧？ <ul style="list-style-type: none"> 請勿在產品附近使用噴霧。
控制面板上的按鈕無法使用。	顯示面板上是否顯示  （鎖定）？ <ul style="list-style-type: none"> 按住 Ionizer 按鈕 3 秒鐘解鎖。

氣味

現象	可能的原因和解決方法
出氣口和濾網傳出異味。	購買電器後是否出現氣味？ <ul style="list-style-type: none"> 活性炭的氣味對人體無害。這與您在全新汽車中或會聞到氣味的原因一致。該氣味應該在使用多天後消散。
	本電器是否應該在有大量煙霧或氣味的區域使用？ <ul style="list-style-type: none"> 如在使用空氣清新劑、擴散器或香薰蠟燭，或進行室內作業或更換牆紙後運轉空氣清新機，濾網可能會吸收此類氣味並散發出異味。先保持通風，然後使用電器。
	濾網是否發出氣味？ <ul style="list-style-type: none"> 濾網更換頻率會因使用環境而不同。若氣味來自濾網，請更換濾網。
	是在煮飯環境中使用嗎？ <ul style="list-style-type: none"> 如果您烹煮或烤魚類/肉類長時間使用此產品，濾網壽命將顯著縮短。 若可能，烹煮期間開窗通風，並使用電器清除剩餘氣味。
	是在潮濕環境中使用嗎？ <ul style="list-style-type: none"> 在潮濕環境下使用時，濾網會散發出氣味。使用前將濾網放在陽光下曬乾。

LG ThinQ

現象	可能的原因和解決方法
本設備和智慧型手機無法通過 Wi-Fi 連接。	如您正在嘗試連接的 Wi-Fi 密碼錯誤。 <ul style="list-style-type: none">找到連接至您智慧型手機上的 Wi-Fi 網路並將其刪除，然後在 LG ThinQ 上連接您的設備。
	智慧型手機的行動數據處於開啟狀態。 <ul style="list-style-type: none">關閉智慧型手機的行動數據並使用 Wi-Fi 網路重新連接該設備。
	如所設置的無線網路名稱 (SSID) 不正確。 <ul style="list-style-type: none">無線網路名稱 (SSID) 應為英文字母和數字的組合。(請勿使用特殊字元。)
	路由器頻率不是 2.4 GHz。 <ul style="list-style-type: none">僅支持 2.4 GHz 的路由器頻率。將無線路由器設定為 2.4 GHz，並將該設備連接至無線路由器上。要查看路由器頻率，請聯繫您的網際網路服務提供者或路由器製造商。
	本設備與路由器間存在較遠距離。 <ul style="list-style-type: none">如本設備距離無線路由器太遠，網路訊號強度會變弱，且可能無法正確設置連接。將路由器移動至靠近本設備。

附錄

產品規格

規格指南

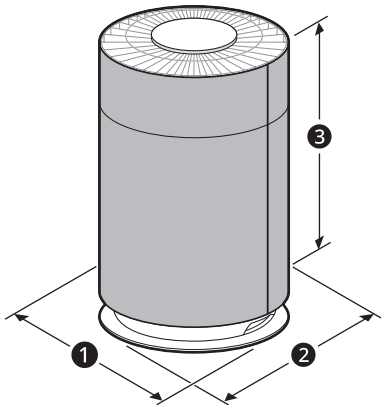

名稱	空氣清新機
電源	AC 220-240 V, 50/60 Hz
外部尺寸 (❶ x ❷ x ❸)	315 mm x 315 mm x 511 mm

Service Commitment
服務承諾

LG's mission is to create value for customers. We are committed to improve the life of our customers by putting the customers first, and delivering the best possible pre and after sales services in the way they want.

為顧客創造價值乃LG一貫宗旨。我們致力提供最貼心的售前及售後服務，一切以顧客為先，希望為客戶帶來最優質的生活。



Warranty Card
產品保用證

Product Type 產品	Product Description 產品種類	Warranty Period (Year) 保用期 (年)
Refrigerator 雪櫃	Appliance 主機	3
	Inverter Linear Compressor* 線性變頻式壓縮機*	10
	Smart Inverter Compressor* 智能變頻式壓縮機*	10
Washing Machine 洗衣機	Appliance 主機	2
	Inverter Direct Drive Motor* 直驅式變頻摩打*	10
	Smart Inverter Motor* 智能變頻式摩打*	10
Dryer 乾衣機	Appliance 主機	2
	Inverter Motor* 變頻摩打*	10
	Dual Inverter Compressor* 雙迴轉變頻式壓縮機*	10
Vacuum Cleaner 吸塵機	Appliance 主機	2
	Inverter Motor* 變頻摩打*	10
	Battery* 電池*	1
Air Purifier 空氣清新機	Appliance 主機	2
	Appliance 主機	2
	Dual Inverter Compressor* 雙迴轉變頻式壓縮機*	10
Styler 衣物護理機	Appliance 主機	2
	Smart Inverter Compressor* 智能變頻式壓縮機*	10

* This extended parts warranty is applicable on specific parts only. The consumer will be charged for labour after the product warranty has expired.

* 零件延長保用僅適用於產品上的指定零件，在產品的保用期後則需另付人工費用。

