

Funcionamiento básico

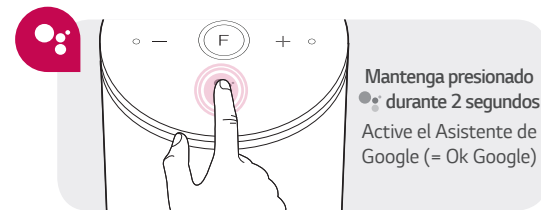

Get Started with **WK7**

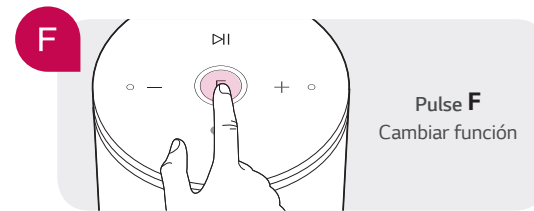
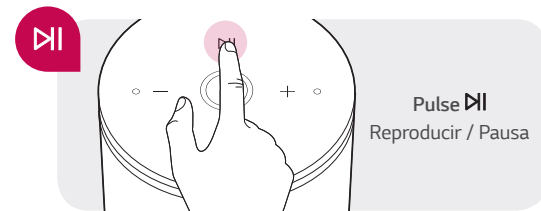
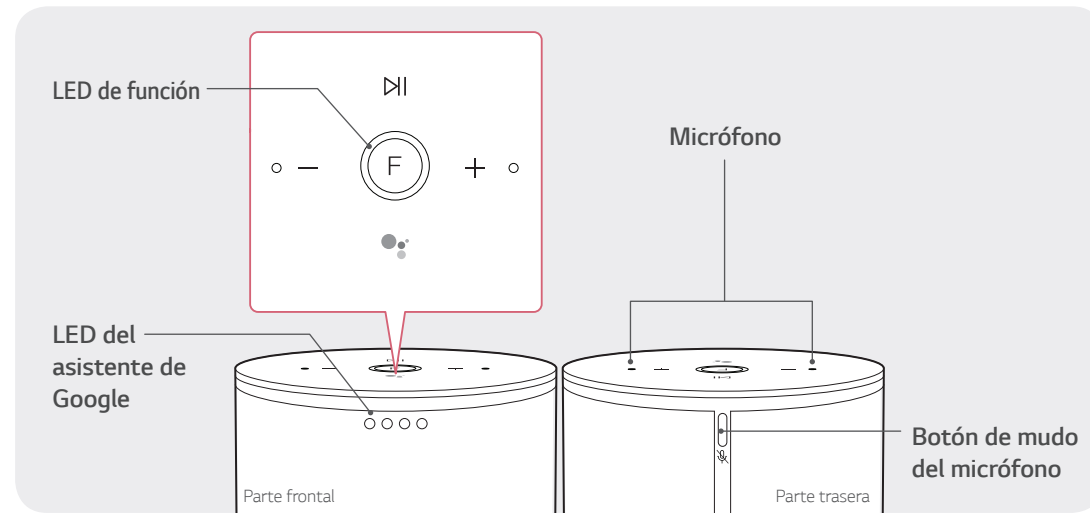

Step
01

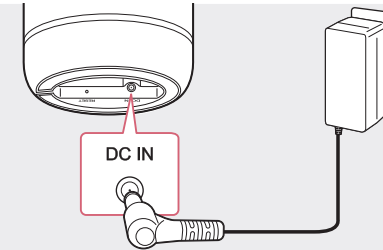

Connect the AC adapter

After connecting the AC adapter, the speaker starts booting. Then Function LED rotates for tens of seconds (Approx. 30 ~ 50 seconds) during booting.

Step
02

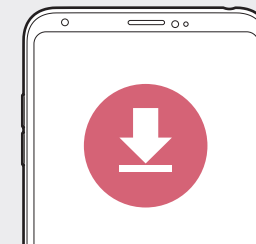

Install "Google Home" App

Download the Google Home App from the Google Play or App Store.

Step
03

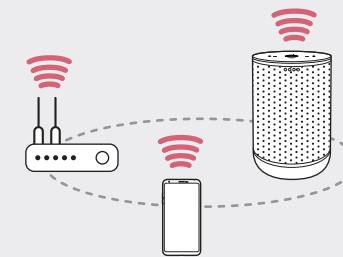

Set up the Wi-Fi connection

Launch the "Google Home" app and Follow the steps for Wi-Fi connection on the app.

- ① Quick set up
Activate Bluetooth function on smart device → Follow the steps on app → Set up Wi-Fi connection faster

Basic Operation

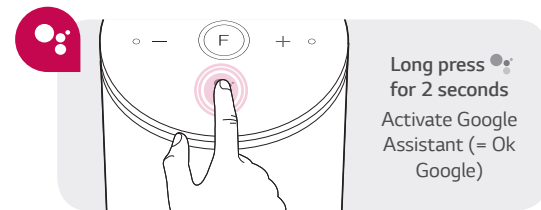
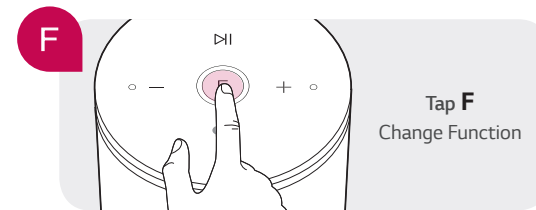
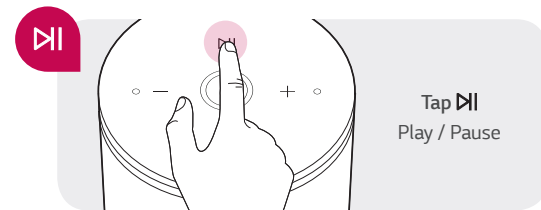
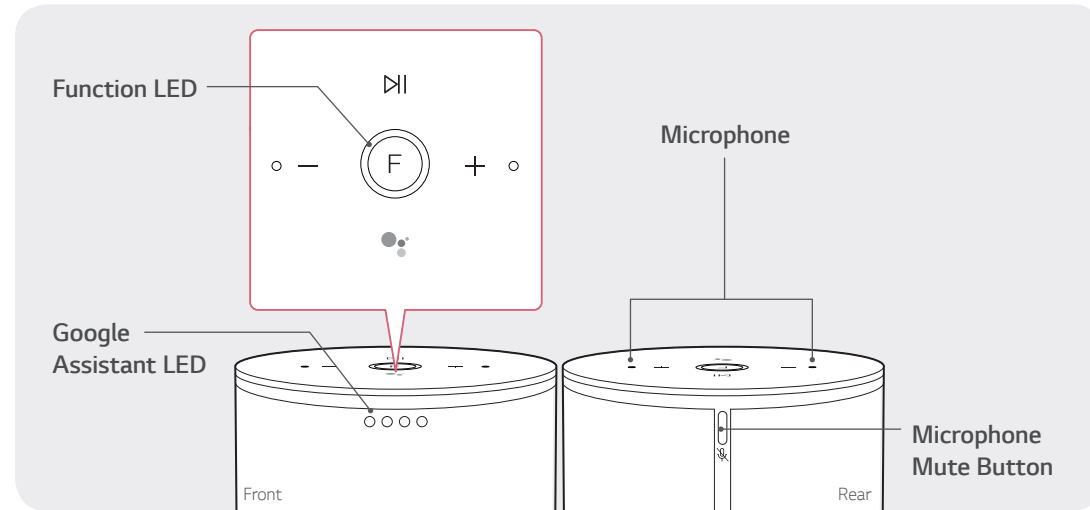

Comenzar con **WK7**



Paso
01

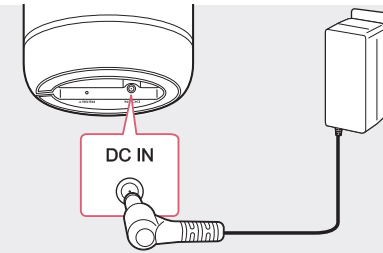

Conectar el adaptador de CA

Una vez realizada la conexión del adaptador de CA, el altavoz comienza a encenderse. La función LED gira durante diez segundos (aprox. 30-50 segundos) durante el proceso de encendido.

Paso
02

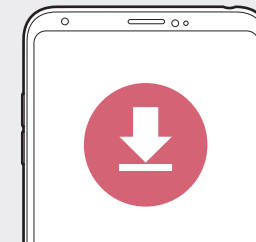

Instalar la aplicación "Google Home"

Descargue la aplicación Google Home de Google Play o App Store.

Paso
03

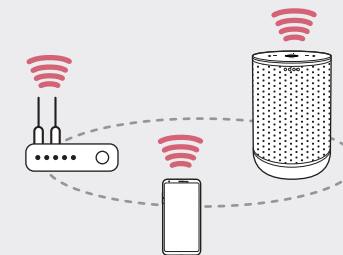

Configurar la conexión Wi-Fi

Inicie la aplicación "Google Home" y siga los pasos para la conexión Wi-Fi en la aplicación.

- ① Ajuste rápido
Active la función Bluetooth en el dispositivo inteligente. → Siga los pasos en la aplicación → Configure la conexión Wi-Fi más rápido.