



LG Pra.L Dual Motion Cleanser

Model Name
BCJ1 BCJ2



Charge

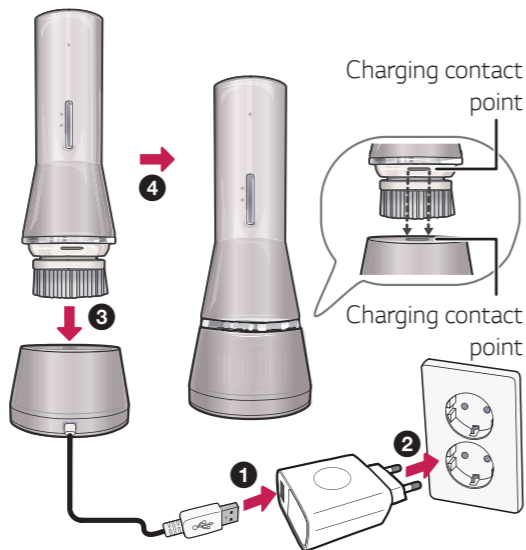

① When charging, place this device on the contact point of the charging stand. The UV light on the bottom of the charging cradle turns on.

Power on / off

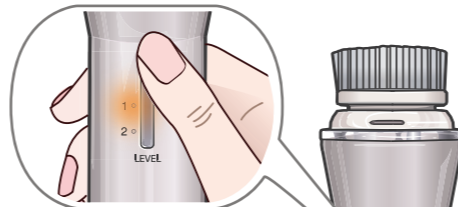

Press the (power) button for a short while.

Choose vibration speed and level



Press the LEVEL button for a short while.
(1 → 2)

Set voice guide function

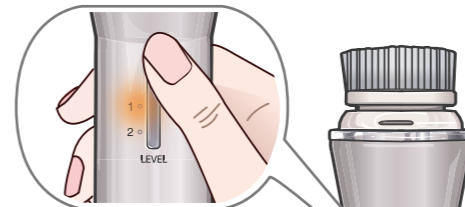

Press the (power) button for a long while (until the guide).
(Voice guide → Sound effect guide → Turn off guide(mute))

Language Setting

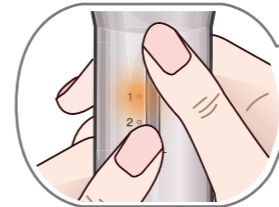

Press the (power) button and the LEVEL button at the same time for a long while (until the guide).
(Korean → English → Chinese)

Precautions for use

- When using this device, depending on individual skin condition, it may cause a variety of skin irritation. If such irritation persists, please reduce the number of use.
- In the following cases, it is recommended to use the device after consultation with a specialist.
 - Allergies skin, acne, dermatitis, skin treatment, cosmetic surgery or hair loss surgery
 - Wearing a cardiac pacemakers, device implantation or a metal prosthetic device
- As a facial treatments only, it is not recommended to use for a body.
- Before using the device, if you are currently undergoing dermatology related treatment or have skin problems, consult your dermatologist and then use it.
- Recommend using the product once a day. Using more than twice a day may make skin more sensitive.
- Do not use the device for purposes other than those set out in this guideline.



How to use

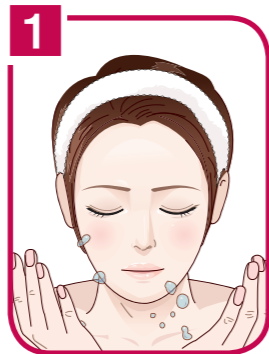

Wet your face or brush with tepid water.



Put cleansing product for your skin type on the wet brush.



Turn on the power



Press the LEVEL button and choose cleansing vibration speed and level.

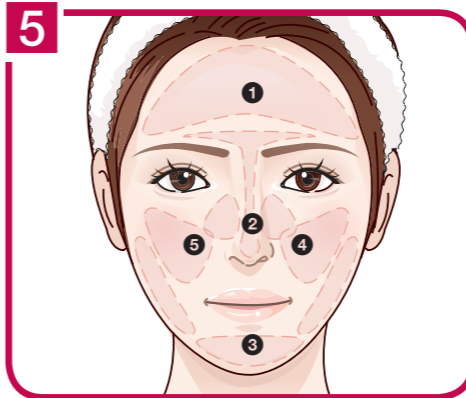

Start cleansing in the following order.

① Forehead (20 seconds) → ② Nose (20 seconds) → ③ Chin (10 seconds) → ④ Left cheek (10 seconds) → ⑤ Right cheek (10 seconds) → Power off



Rinse your face sufficiently with tepid water after cleansing.

ⓘ Making sufficient amount of bubble before cleansing is recommended.

How to hold the device

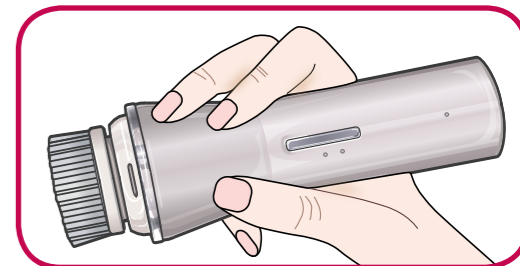

Use the device by holding it like a pencil.

ⓘ Before use, make sure that the brush is correctly attached.

