



SIMPLE MANUAL

LG WOWCAST

Wideband audio On Wireless

MODEL

WTP3



MFL71841391

2201_Rev03

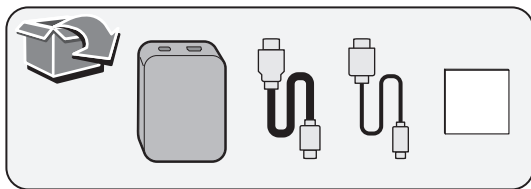

www.lg.com
Copyright © 2022 LG
Electronics Inc. All Rights
Reserved.



LG Wi-Fi Sound Bar



(Compatible LG Wi-Fi Sound Bar)

- 1** Check if the sound bar is updated. Press the  or  button of the remote control for 3 seconds. When **LG WOWCAST READY** is displayed, proceed from **4**.

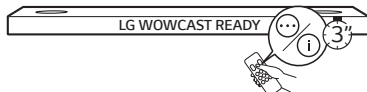

- 2** To reset, press the  or  button of the sound bar for 3 seconds.



- 3** Use the QR code to install the LG Sound Bar app. Turn on **Bluetooth** on the smartphone and add the sound bar according to the guide of the LG Sound Bar app.



(Android Phone OS) (iPhone OS)

4 Connect LG WOWCAST to TV.

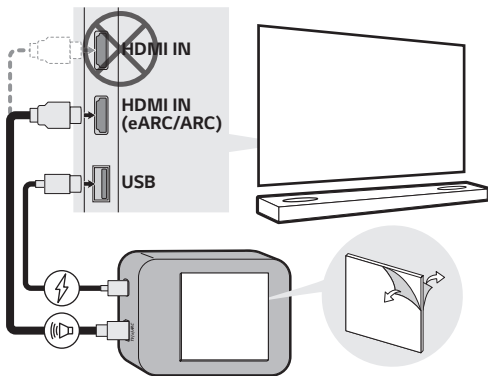

HDMI™
HIGH-DEFINITION MULTIMEDIA INTERFACE

- 5 Press the **[F]** or **[@]** button of the sound bar remote control and select **OPT/HDMI ARC**. When connected, **LG WOWCAST** scrolls once and then “ARC” or “E-ARC” will be displayed.

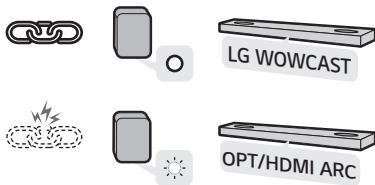

Note

- You can find compatible soundbars using the QR code on page 2 in this manual.
- On your TV's settings, set the output speaker to [HDMI ARC].
- On your TV's settings, set the HDMI-CEC to [On]. Settings and menu items may vary depending on the TV manufacturer.
- To reset LG WOWCAST, press the **RESET** button for 3 seconds or longer. You also need to reset the sound bar. Press the **[VOLUME DOWN]** or **[POWER]** button of the sound bar for 3 seconds or longer.

- Depending on TV, time taken for sound output may differ. It is recommended to use a separate adapter instead of a USB to connect your TV.
- LG WOWCAST only outputs audio, not video.
- Before attaching LG WOWCAST to the TV, wipe the area to be attached with cloth such as gauze.
- When attaching LG WOWCAST to the TV, make sure not to block ventilation holes of the TV.
- You can check the manual with details on www.lg.com.

ENGLISH

Specifications

- **Power requirements:** Refer to the main label on the unit.
- **Power consumption:** Refer to the main label on the unit.
- **Dimensions (W x H x D):** 65.0 mm x 13.0 mm x 85.0 mm

Safety Information

CAUTION: TO REDUCE THE RISK OF ELECTRIC SHOCK DO NOT REMOVE COVER (OR BACK) NO USER-SERVICEABLE PARTS INSIDE REFER SERVICING TO QUALIFIED SERVICE PERSONNEL



This lightning flash with arrowhead symbol within an equilateral triangle is intended to alert the user to the presence of uninsulated dangerous voltage within the product's enclosure that may be of sufficient magnitude to constitute a risk of electric shock to persons.



The exclamation point within an equilateral triangle is intended to alert the user to the presence of important operating

and maintenance (servicing) instructions in the literature accompanying the product.

WARNING:

- TO PREVENT FIRE OR ELECTRIC SHOCK HAZARD, DO NOT EXPOSE THIS PRODUCT TO RAIN OR MOISTURE.
- Do not install this equipment in a confined space such as a book case or similar unit.

CAUTION:

- The apparatus should not be exposed to water (dripping or splashing) and no objects filled with liquids, such as vases, should be placed on the apparatus.
- To avoid fire or electric shock, do not open the unit. contact to qualified personnel only.

- Do not leave the unit in a place near the heating appliances or subject to direct sunlight, moisture, or mechanical shock.
- To clean the unit, use a soft, dry cloth. If the surfaces are extremely dirty, use a soft cloth lightly moistened with a mild detergent solution. Do not use strong solvents such as alcohol, benzine, or thinner, as these might damage the surface of the unit.
- Do not use volatile liquids such as insecticide spray near the unit. Wiping with strong pressure may damage the surface. Do not leave rubber or plastic products in contact with the unit for a long period of time.

- Do not leave the unit on an unstable place such as high shelves. it may fall down because of the vibration of the sound.
- Do not use high voltage products around this product. (ex. Electrical swatter) This product may malfunction due to electrical shock.
- It is recommended that you use the 5 V AC adapter (more than 0.5 A) with this device.

CAUTION when using this product in environments of low humidity.

- It may cause static electricity in environments of low humidity.
- It is recommended to use this product after touching any metal object which conducts electricity.

NOTICE: For safety marking information including product identification and supply ratings, please refer to the main label on the bottom or the other surface of the product.

Symbols

~	Refers to alternating current (AC).
≡	Refers to direct current (DC).
⏻	Refers to class II equipment.
⏻	Refers to stand-by.
I	Refers to "ON" (power).
⚡	Refers to dangerous voltage.





