



## OWNER'S MANUAL

# WASHING MACHINE

---



Before beginning installation, read these instructions carefully. This will simplify installation and ensure that the product is installed correctly and safely. Leave these instructions near the product after installation for future reference.

**ENGLISH**

F2T2TYM1S



52291028  
Rev.00\_093022

[www.lg.com](http://www.lg.com)

Copyright © 2022 LG Electronics Inc. All Rights Reserved.

# TABLE OF CONTENTS

This manual may contain images or content that may be different from the model you purchased.

This manual is subject to revision by the manufacturer.

## SAFETY INSTRUCTIONS

READ ALL INSTRUCTIONS BEFORE USE.....	3
WARNING .....	3

## INSTALLATION

Parts and Specifications .....	8
Installation Place Requirements .....	11
Levelling the Appliance .....	12
Connecting the Water Supply Hose .....	13
Installing the Drain Hose .....	15

## OPERATION

Operation Overview.....	17
Control Panel .....	19
Preparing the Wash Load .....	20
Adding Detergents and Softeners .....	20
Programme Table .....	23
Extra Options and Functions .....	28
Auxiliary Functions.....	30

## MAINTENANCE

Cleaning After Every Wash.....	32
Cleaning the Appliance Periodically .....	33

## TROUBLESHOOTING

Before Calling for Service.....	35
---------------------------------	----

# SAFETY INSTRUCTIONS

## READ ALL INSTRUCTIONS BEFORE USE

The following safety guidelines are intended to prevent unforeseen risks or damage from unsafe or incorrect operation of the appliance. The guidelines are separated into 'WARNING' and 'CAUTION' as described below.

### Safety Messages



This symbol is displayed to indicate matters and operations that can cause risk. Read the part with this symbol carefully and follow the instructions in order to avoid risk.



#### **WARNING**

This indicates that the failure to follow the instructions can cause serious injury or death.



#### **CAUTION**

This indicates that the failure to follow the instructions can cause the minor injury or damage to the product.

## WARNING



### **WARNING**

To reduce the risk of explosion, fire, death, electric shock, injury or scalding to persons when using this product, follow basic precautions, including the following:

### Technical Safety

- This appliance is not intended for use by persons (including children) with reduced physical, sensory or mental capabilities, or lack of experience and knowledge, unless they have been given supervision or instruction concerning use of the appliance by a person responsible for their safety.

## 4 SAFETY INSTRUCTIONS

---

- Children should be supervised to ensure that they do not play with the appliance.
- If the power cord is damaged, it must be replaced by the manufacturer, its service agent or similarly qualified persons in order to avoid a hazard.
- Use a new hose or hose-set supplied with the appliance. Reusing old hoses can cause a water leak and subsequent property damage.
- Ventilation openings must not be obstructed by a carpet.
- This appliance is intended to be used in household only.
- The inlet water pressure must be between 50 kPa and 800 kPa.

### Maximum Capacity

The maximum capacity in some cycles for dry clothes to be washed is **8 kg**.

The recommended maximum capacity for each washing programme may differ. To get good wash results, please refer to **Programme Table** in **OPERATION** chapter for further details.

### Installation

- This appliance should only be transported by two or more people holding the appliance securely.
- Do not install the appliance in a damp and dusty place. Do not install or store the appliance in any outdoor area, or any area that is subject to weathering conditions such as direct sunlight, wind, rain, or temperatures below freezing.
- Make sure the power plug is completely pushed into the power outlet.
- Do not plug the appliance into multiple outlet sockets, power boards, or an extension power cable.
- Do not modify the power plug provided with the appliance. If it does not fit the power outlet, have a proper outlet installed by a qualified electrician.

- This appliance is equipped with a power cord having an equipment-earthing / grounding conductor (earthing pin) and a grounding power plug. The power plug must be plugged into an appropriate outlet socket that is installed and earthed / grounded in accordance with all local codes and ordinances.
- Improper connection of the equipment-grounding conductor can result in risk of electric shock. Check with a qualified electrician or service personnel if you are in doubt as to whether the appliance is properly grounded.

## Operation

- Never attempt to operate the appliance if it is damaged, malfunctioning, partially disassembled, or has missing or broken parts, including a damaged cord or plug.
- Do not apply any sharp objects to the control panel in order to operate the appliance.
- Do not attempt to separate any panels or disassemble the appliance.
- Do not repair or replace any part of the appliance. All repairs and servicing must be performed by qualified service personnel unless specifically recommended in this Owner's Manual. Use only authorized factory parts.
- Do not push down the door excessively, when the appliance door is open.
- Do not put animals, such as pets into the appliance.
- Do not wash any items that are specified by the manufacturer as not washable on the care label.
- Keep the area underneath and around the appliance free of combustible materials such as lint, paper, rags, chemicals, etc.
- Do not leave the appliance door open. Children may hang on the door or crawl inside the appliance, causing damage or injury.
- Do not put in, wash or dry articles that have been cleaned in, washed in, soaked in, or spotted with combustible or explosive substances (such as waxes, wax removers, oil, paint, gasoline, degreasers, drycleaning solvents, kerosene, petrol, spot removers, turpentine,

## 6 SAFETY INSTRUCTIONS

---

vegetable oil, cooking oil, acetone, alcohol, etc.). Improper use can cause fire or explosion.

- Do not use or store flammable or combustible substances (ether, benzene, alcohol, chemical, LPG, combustible spray, gasoline, thinner, petroleum, insecticide, air freshener, cosmetics, etc.) near the appliance.
- Never reach into the appliance while it is operating. Wait until the drum has completely stopped.
- Do not touch the door during a high temperature programme.
- In case of a water leak from the appliance or flood, disconnect the power plug and contact the LG Electronics customer information centre.
- Turn off water taps to relieve pressure on hoses and valves and to minimize leakage if a break or rupture should occur. Check the condition of the fill hoses; they should be replaced after 5 years.
- If there is a gas leakage (isobutane, propane, natural gas, etc.) within the home, do not touch the appliance or power plug and ventilate the area immediately.
- If the drain hose or inlet hose is frozen during winter, use it only after thawing.
- Keep all washing detergents, softener and bleach away from children.
- Do not touch the power plug or the appliance controls with wet hands.
- Do not bend the power cable excessively or place a heavy object on it.
- Avoid touching any water that is drained from the appliance during the wash.
- Make sure that drainage is working properly. If water is not drained properly, your floor may get flooded.
- When the air temperature is high and the water temperature is low, condensation may occur and thus wet the floor.
- Wipe off dirt or dust on the contacts of the power plug.

## Maintenance

- Disconnect the appliance from the power supply before cleaning the appliance. Setting the controls to the OFF or stand by position does not disconnect this appliance from the power supply.
- Securely plug the power plug in the outlet socket after completely removing any moisture and dust.
- Do not spray water inside or outside the appliance to clean it.
- Never unplug the appliance by pulling on the power cable. Always grip the power plug firmly and pull straight out from the outlet socket.
- Only qualified service personnel from LG Electronics service centre should disassemble, repair, or modify the appliance. Contact an LG Electronics customer information centre if you move and install the appliance in a different location.

## Disposal

- Before discarding an old appliance, unplug it. Cut off the cable directly behind the appliance to prevent misuse.
- Dispose of all packaging materials (such as plastic bags and styrofoam) away from children. The packaging materials can cause suffocation.
- Cut off the power cord and remove the door before disposing of this appliance to avoid the danger of children or small animals getting trapped inside.

## 8 INSTALLATION

# INSTALLATION

## Parts and Specifications

### NOTE

- Appearance and specifications may change without notice to improve the quality of the appliance.

### Front View

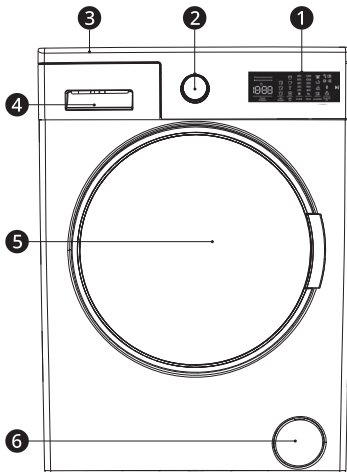

- ❶ Control Panel
- ❷ Programme Knob
- ❸ Top Plate
- ❹ Detergent Dispenser Drawer
- ❺ Drum
- ❻ Pump Filter Cover

### Rear View

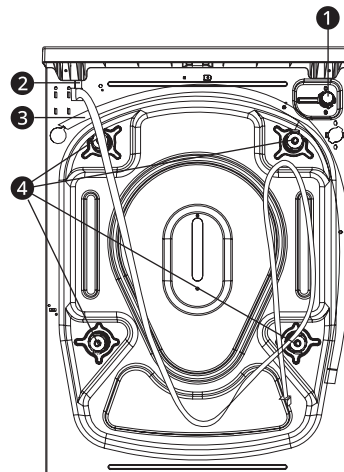

- ❶ Water Inlet Valve
- ❷ Power Cable
- ❸ Drain Hose
- ❹ Transit Bolts



## Specifications

Model	F2T2TYM1S
Power Supply	220–240 V~, 50 Hz
Product Weight	70.0 kg

ENGLISH

### Dimension(mm)

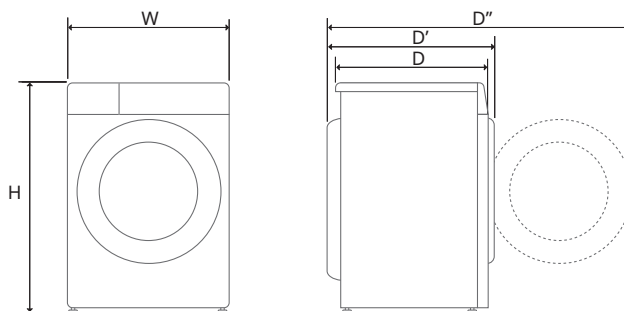

W	600	D	560	D''	1035
H	850	D'	595		

## 10 INSTALLATION

### Accessories

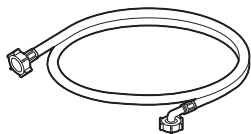

Cold Supply Hose

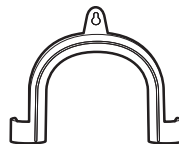

Elbow Bracket for Securing Drain Hose

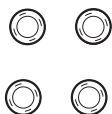

Caps for Covering Transit Bolt Holes

## Installation Place Requirements

Before installing the appliance, check the following information to make sure that the appliance should be installed in a correct place.

### Installation Location

- This appliance must be installed on firm flooring to minimize vibration during the spin cycle. Concrete flooring is best, being far less prone to vibration during the spin cycle than wooden floorboards or a carpeted surface.
- If it is impossible to avoid positioning the appliance next to a gas cooker or coal burning stove, an insulation (850 X 600 mm) covered with aluminum foil on the side facing the cooker or stove must be inserted between the two appliances.
- Ensure that when the appliance is installed, it is easily accessible for an engineer in the event of a breakdown.
- When installing the appliance, adjust all four feet using spanner to ensure the appliance is stable.
- Ensure that there is enough room for full opening of the appliance door.
- To ensure sufficient clearance for water inlet hoses, drain hose and airflow, allow minimum clearances of at least 20 mm at the sides and 100 mm behind the appliance. Be sure to allow for wall, door, or floor moldings that may increase the required clearances.

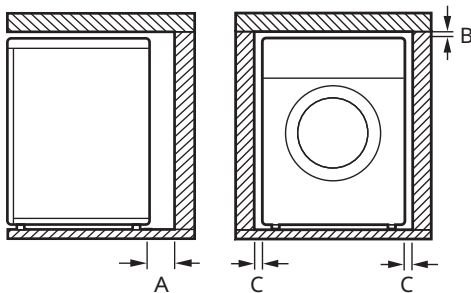

Index	Clearance (mm)
A	100

Index	Clearance (mm)
B	5
C	20

### ⚠ WARNING

- This appliance must only be used for domestic household purposes and should not be used in mobile applications.

### Wooden Floors (Suspended Floors)

When installing the appliance on wooden floors, use rubber cups to reduce excessive vibration and unbalance. Timber or suspended type flooring may contribute to excessive vibration and unbalance, errors and malfunction.

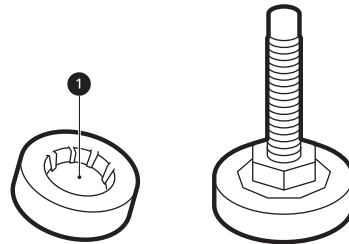

- To reduce vibration, we recommend placing at least 15 mm thickness of rubber cups ① under each adjusting foot of the appliance, secured to at least two floor beams with screws.
- If possible, install the appliance in one of the corners of the room, where the floor is more stable.
- Fit the rubber cups to reduce vibration.

### ⚠ CAUTION

- If the appliance is installed on the unstable floor (e.g. wooden floor), the warranty does not cover any damages and cost occurred due to the installation on the unstable floor.

## 12 INSTALLATION

### NOTE

- You can purchase rubber cups (part No. **4620ER4002B**) from the LG service centre.

grounded/earthed in accordance with all local codes and ordinances.

### Ventilation

- Make sure that air circulation around the appliance should not be impeded by carpets, rugs, etc.

### Ambient Temperature

- Do not install the appliance in rooms where freezing temperatures may occur. Frozen hoses may burst under pressure. The reliability of the electronic control unit may be impaired at temperatures below freezing point.
- If the appliance is delivered in winter and temperatures are below freezing, place the appliance at room temperature for a few hours before putting it into operation.

### Electrical Connection

- Do not use an extension cord or double adapter.
- Always unplug the appliance and turn off the water supply after use.
- Connect the appliance to an earthed socket in accordance with current wiring regulations.
- The appliance must be positioned so that the plug is easily accessible.
- Power outlet must be within 1 meter of either side of the appliance.

### WARNING

- Repairs to the appliance must only be carried out by qualified personnel. Repairs carried out by inexperienced persons may cause injury or serious malfunctioning. Contact your local authorised LG repairer.
- The power plug must be plugged into an appropriate outlet socket that is installed and

## Levelling the Appliance

### Removing the Transit Bolt Assemblies

#### CAUTION

- To prevent the appliance from severe vibration and breakage, remove transit bolts and retainers.

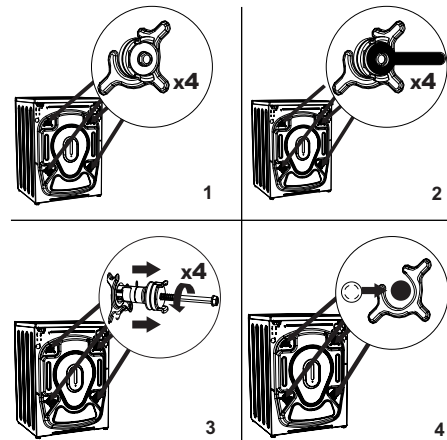

- 1 Remove the 4 transit bolts and rubber spacers from the rear of the appliance.
- 2 Loosen the transit bolts by turning them anticlockwise with an appropriate spanner.
- 3 Remove the transit bolts with a straight pull.
- 4 Fit the plastic blanking caps supplied in the accessories bag into the gaps left by the removal of the transit bolts. The transit bolts should be stored for future use.

## Checking the Level

When pushing down the edges of the top plate diagonally, the appliance should not move up and down at all (check both directions).

- If the appliance rocks when pushing the top plate of the appliance diagonally, adjust the feet again.
- Check whether the appliance is perfectly level after installation.

### NOTE

- Timber or suspended type flooring may contribute to excessive vibration and unbalance. Reinforcement or bracing of the timber floor may need to be considered to stop or reduce excessive noise and vibration.
- Never try to level any uneven floor by putting pieces of wood, cardboard or similar materials under the appliance.

### NOTE

- Do not install the appliance on a plinth, stand or elevated surface unless it is manufactured by LG Electronics for use with this model.

- 2 To increase the height of the appliance, turn the feet clockwise. To decrease the height of the appliance, turn the feet anticlockwise..

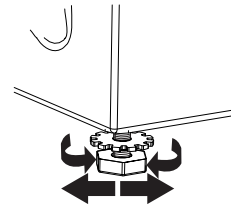

- 3 Check if all lock nuts at the bottom of the appliance are secured properly.

### NOTE

- Proper placement and levelling of the appliance will ensure long, regular, and reliable operation.
- The appliance must be 100% horizontal and stand firmly in position on a hard flat floor.
- It must not 'Seesaw' across corners under the load.
- Do not let the feet of the appliance get wet. Failure to do so may cause vibration or noise.

## Adjusting and Levelling the Feet

When installing the appliance, the appliance should be aligned and perfectly level. If the appliance is not aligned and level properly, the appliance may be damaged or may not operate properly.

- 1 Loosen the plastic locking nut.
  - Do not insert pieces of wood etc. under the feet.
  - Make sure that all four feet are stable and resting on the floor.

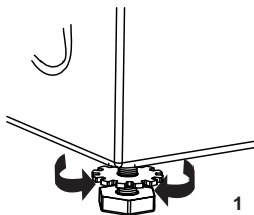

## Connecting the Water Supply Hose

### Note for Connection

- Water pressure must be between **50 kPa** and **800 kPa** (0.5–8.0 kgf/cm<sup>2</sup>). If the water pressure is more than **800 kPa**, a decompression device should be installed.
- Periodically check the condition of the water supply hose and replace the water supply hose if necessary.

## 14 INSTALLATION

### NOTE

- Do not overtighten the water supply hose or use mechanical devices to tighten onto the inlet valves.
- No further backflow protection required for connection to the water inlet.

### Checking the Rubber Seal

Two rubber seals **1** are supplied with the water supply hose. They are used to prevent water leaks. Connection to taps is sufficiently tight.

- Do not use mechanical devices such as multi grips to tighten the water supply hose. Ensure that the curved end of the water supply hose is connected to the appliance.

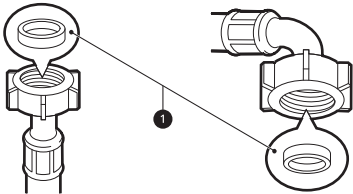

### Connecting the Hose to the Water Tap

**Connecting Screw-Type Hose to Tap with Thread**  
Screw the supply hose connector onto the water supply tap.

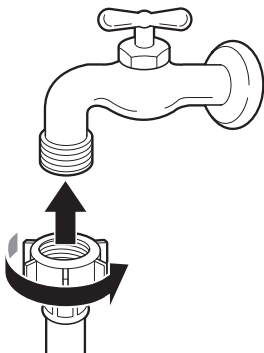

### Connecting Screw-Type Hose to Tap Without Thread

- 1 Loosen the 4 fixing screws **1**.

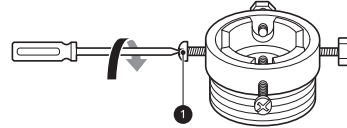

- 2 Remove the guide plate **2** if the tap is too large to fit the adapter.

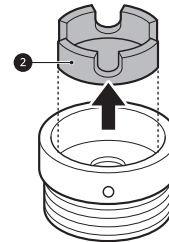

- 3 Push the adapter onto the end of the tap so that the rubber seal is connected to be watertight. Tighten the 4 fixing screws.

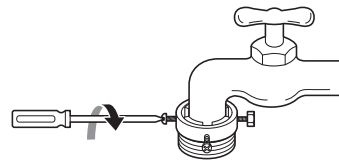

- 4 Push the inlet hose **3** vertically upwards so that the rubber seal within the hose can adhere completely to the tap and then tighten the hose by screwing it to the right.

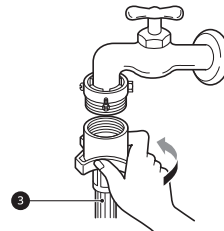

### Connecting One Touch Type Hose to Tap Without Thread

- 1 Unscrew the adapter ring plate ④ and loose the 4 fixing screws.

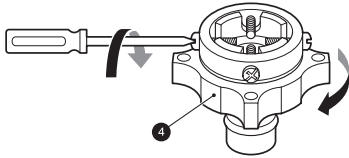

- 2 Remove the guide plate ⑤ if the tap is too large to fit the adapter.

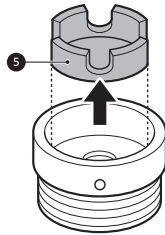

- 3 Push the adapter onto the end of the tap so that the rubber seal is connected to be watertight. Tighten the 4 fixing screws and the adapter ring plate.

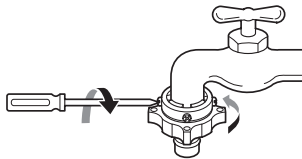

- 4 Pull the connector latch plate ⑥ down, push the inlet hose onto the adapter, and release the connector latch plate. Make sure the adapter locks into place.

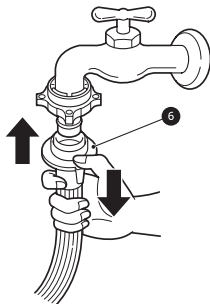

### NOTE

- After connecting the water inlet hose to the water tap, turn on the water tap to flush out foreign substances (dirt, sand, sawdust, and etc.) in the water lines. Let the water drain into a bucket, and check the water temperature.

ENGLISH

### Connecting the Hose to the Appliance

Screw the supply hose to the water inlet valve on the back of the appliance.

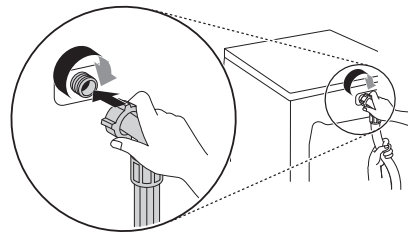

- Do not connect the hose to the hot water supply for models with one water inlet. Connect to the cold water supply only.

### NOTE

- After completing connection, if water leaks from the hose, repeat the same steps. Use the most conventional type of tap for the water supply. In case that the tap is square or too big, remove the guide plate before inserting the tap into the adaptor.
- Make sure that the hose should not be kinked or trapped.

## Installing the Drain Hose

### Installing the Drain Hose with the Elbow Bracket

The drain hose should not be placed higher than **100 cm** above the floor. Water in the appliance may not drain or may drain slowly.

## 16 INSTALLATION

- Securing the drain hose correctly will protect the floor from damage due to water leakage.

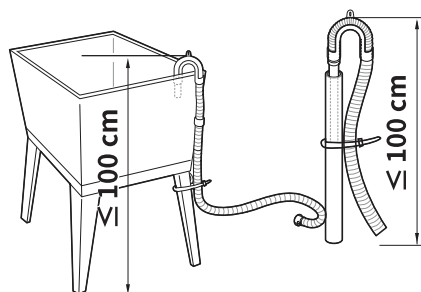
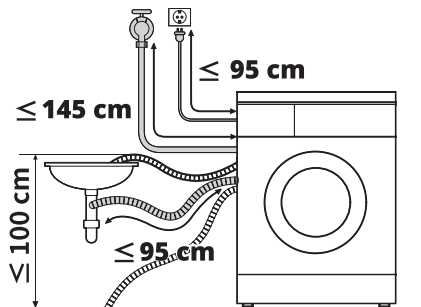

- If the drain hose is too long, do not force it back into the appliance. This will cause abnormal noise.
- When installing the drain hose to a sink, secure it tightly with string.

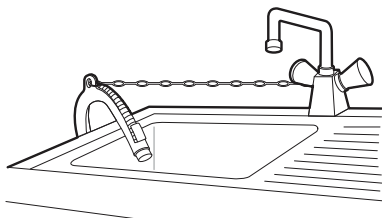



# OPERATION

## Operation Overview

### Using the Appliance

Before the first wash, select the **Cotton** wash programme and add a half amount of the detergent. Start the appliance without clothes. This will remove possible residues and water from the drum that may have been left during manufacturing.

- 1 Sort clothes and load items.
  - Sort clothes by fabric type, soil level, colour and load size as needed. Open the door and load items into the appliance.

### CAUTION

- Before closing the door, ensure that all clothes and items are inside the tub and not overhanging on the rubber door seal where they will become caught when the door is closed. Failing to do so will cause damage to the door seal and the clothes.

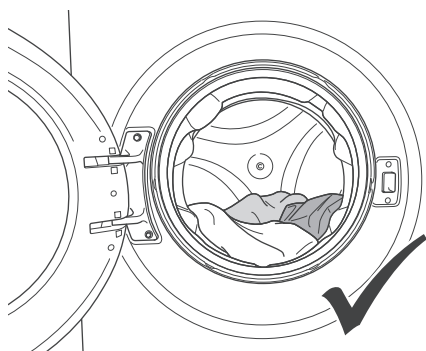

### CAUTION

- Remove items from the flexible door seal gasket to prevent clothing and door seal damage.

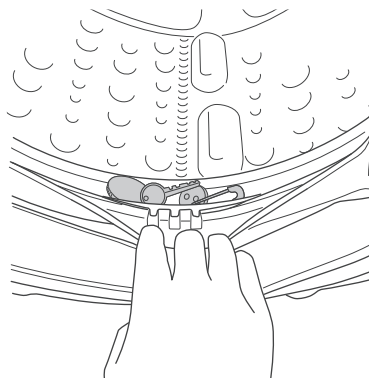

ENGLISH

- 2 Add cleaning products or detergent and softener.

- Add the proper amount of detergent to the detergent dispenser. If desired, add bleach or fabric softener to the appropriate areas of the dispenser.

- 3 Plug your machine into the mains supply and then turn on the water supply.

- 4 Choose the desired cycle.

- Turn the cycle selector knob until the desired cycle is selected.
- Now select a wash temperature and spin speed. Pay attention to the fabric care label of your clothes.

- 5 Begin a programme.

- Press the **Start/Pause** button to begin the programme. The appliance will agitate briefly without water to measure the weight of the load.



## 18 OPERATION

### 6 End of programme.

- When the programme is finished, **End** will appear on the electronic display.

### NOTE

- Your machine features a half-load detection system.
  - If you put less than half the maximum load of laundry into your machine it will automatically set the half-load function, regardless of the programme you selected.
  - This means that the selected programme will take less time to complete and will use less water and energy.
- If you want to pause/cancel a running program or add laundry

	<p>Press the button to pause or restart the selected program.</p> <ul style="list-style-type: none"> <li>- When you want to add laundry, you can use this function.</li> </ul>
	<p>LED lights up when the programme starts and the door is unlocked.</p> <ul style="list-style-type: none"> <li>- You can open the loading door and add laundry.</li> </ul>
	<p>LED lights up when the programme starts and the door is locked.</p> <ul style="list-style-type: none"> <li>- The step where you can add laundry has passed.</li> </ul>
<b>Off</b>	<p>If you want to cancel a running program, turn the program knob to "Off" position.</p> <ul style="list-style-type: none"> <li>- Your machine will stop washing process and the program will be cancelled.</li> <li>- To drain the water in the machine, turn the program knob to any program position. Your machine will drain the water and cancel the program.</li> </ul>

## Control Panel

The actual control panel may differ from model to model.

### Control Panel Features

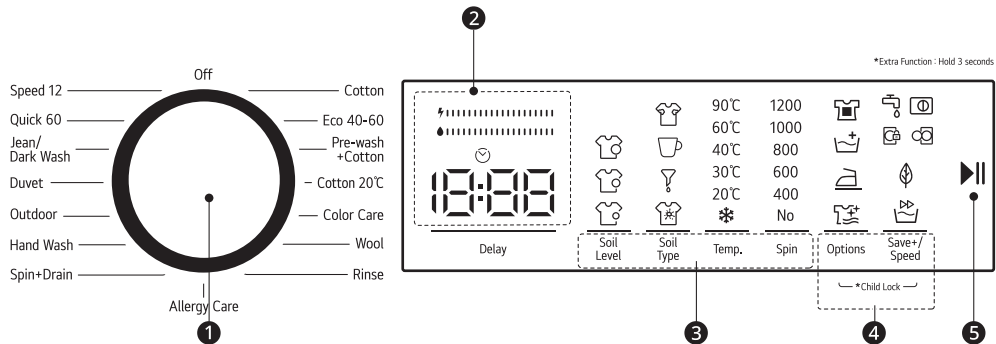

	Description
<b>1</b>	<b>Programme Knob</b> <ul style="list-style-type: none"> <li>Programmes are available according to the clothes type.</li> <li>The lamp will light up to indicate the selected programme.</li> </ul>
<b>2</b>	<b>Display</b> <ul style="list-style-type: none"> <li>The display shows the settings, estimated remaining time, options, and status messages. When the appliance is turned on, the default settings in the display will illuminate.</li> </ul>
<b>3</b>	<b>Customizing Washing Programme Buttons</b> <p>Use these buttons to adjust the water temperature or spin speed settings for the selected programme.</p> <ul style="list-style-type: none"> <li>The current settings are shown in the display.</li> <li>Press the button for that option to select other settings.</li> </ul>
<b>4</b>	<b>Extra Options and Functions</b> <ul style="list-style-type: none"> <li>To use the extra functions, press and hold the corresponding button for 3 seconds. The corresponding symbol lights up in the display.</li> <li>This allows you to select an additional programmes and will light when selected.</li> </ul>
<b>5</b>	<b>Start/Pause Button</b> <ul style="list-style-type: none"> <li>This button is used to start the wash cycle or pause the wash cycle.</li> <li>If a temporary stop of the wash cycle is needed, press this button.</li> <li>If you switch your machine to the standby mode, the <b>Start/Pause</b> led on the electronic display will blink.</li> </ul>

## 20 OPERATION

### Preparing the Wash Load

Sort the wash load for best washing results, and then prepare the clothes according to the symbols on their care labels.





#### Sorting the Clothes

- **Soil level (Heavy, Normal, Light):** Separate clothes according to soil level. If possible, do not wash heavily soiled items with lightly soiled ones.
- **Colour (White, Lights, Dark):** Wash dark or dyed clothes separately from whites or light colours. Mixing dyed clothes with light clothes can result in dye transfer or discolouration of lighter clothes.
- **Lint (Lint producers, Collectors):** Wash separately lint producing fabrics from lint collecting fabrics. Lint producers can result in pilling and linting on the lint collectors.

#### Checking the Clothes Care Label

The symbols tell you about the fabric content of your garment and how it should be washed.

#### Symbols on the Care Labels

Symbol	Wash / Fabric type
	<ul style="list-style-type: none"> <li>• Normal Wash</li> <li>• Cotton, Mixed Fabrics</li> </ul>
	<ul style="list-style-type: none"> <li>• Easy Care</li> <li>• Synthetic, Mixed Fabrics</li> </ul>
	<ul style="list-style-type: none"> <li>• Special Delicate Wash</li> <li>• Delicates</li> </ul>
	<ul style="list-style-type: none"> <li>• Hand Wash Only</li> <li>• Wool, Silk</li> </ul>
	<ul style="list-style-type: none"> <li>• Do not wash</li> </ul>

#### NOTE

- The dashes under the symbol give you information about the type of fabric and the maximum allowance of mechanical stress.

#### Checking the Clothes before Loading

- To help distribute the load evenly during spinning, combine large and small items in a load.
- Do not wash single small items. Add 1-2 similar items to the load to prevent an out-of-balance load.
- Check all pockets to make sure that they are empty. Items such as nails, hair clips, matches, pens, coins and keys can damage both your appliance and clothes.

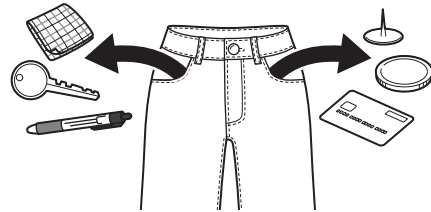

- Wash delicates (stockings, underwired bras) in a wash net.
- Close zippers, hooks and strings to make sure that these items do not snag on other clothes.
- Pre-treat dirt and stains by brushing a small amount of detergent dissolved water onto stains to help lift dirt.

### Adding Detergents and Softeners

#### Detergent Dosage

- Detergent should be used according to the instruction of the detergent manufacturer and selected according to type, colour, soiling of the fabric and the washing temperature. Use only

detergents that are suitable for Drum (front load) type washers.

- If too many suds occur, reduce the detergent amount.
- If too much detergent is used, too many suds can occur and this will result in poor washing results or cause heavy load to the motor.
- If you wish to use liquid detergent, follow the guidelines provided by the detergent manufacturer.
- You can pour liquid detergent directly into the main detergent drawer if you are starting the wash cycle immediately.
- Do not use liquid detergent if you are using the **Delay** function, or if you have selected **Pre Wash** option, as the liquid will dispense immediately and may harden in the drawer or the tub.
- Detergent usage may need to be adjusted for water temperature, water hardness, size and soil level of the load. For best results, avoid overdosing the detergent. Failing to do so will cause oversudsing.
- Refer to the label of the clothes, before adding the detergent and choosing the water temperature.
- Use only suitable detergents for the respective type of clothing:
  - Liquid detergent is often designed for special applications, e.g. for coloured fabric, wool, delicate or dark clothes.
  - Powdered detergent is suitable for all types of fabric.
  - For better washing results of white and pale garments, use powdered detergent with bleach.
  - Detergent is flushed from the dispenser at the beginning of the wash cycle.

## NOTE

- Do not let the detergent harden. Doing so may lead to blockages, poor rinse performance or odour.
- Full load: According to manufacturer's recommendation.
- Part load: 1/2 of the normal amount.

- Minimum load: 1/3 of full load.

## Using the Dispenser

To add detergent dosage to the dispenser:

- 1 Open the detergent drawer.
- 2 Add the detergent and softener into the appropriate compartments.

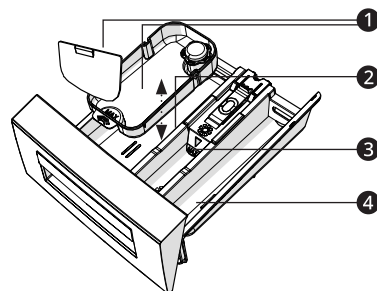

- 1 Liquid Detergent Attachments
- 2 Main wash detergent compartment
- 3 Liquid fabric softener compartment
- 4 Pre-wash detergent compartment

- 3 Gently close the detergent dispenser drawer before starting the cycle.

- Slamming the drawer closed may result in the detergent overflowing into another compartment or dispensing into the drum earlier than programmed.
- Be careful not to get a hand caught in the drawer while closing.
- It is normal for a small amount of water to remain in the dispenser compartments at the end of the cycle.

## Fabric Softener Compartment

This compartment holds liquid fabric softener, which is automatically dispensed during the final rinse cycle. Either powdered or liquid fabric softener may be used.

## 22 OPERATION

---

- Pour fabric softener to the maximum fill line. Pouring excessive fabric softener over the maximum fill line can cause it to dispense too early, which may stain the clothes.

### NOTE

- Do not pour fabric softener directly onto the clothes in the wash drum, doing so will cause dark staining on the clothes that will be difficult to remove.
- Do not leave the fabric softener in the detergent drawer for more than 1 day. Fabric softener may harden. Softener may remain in the dispenser if it is too thick. The softener should be diluted if the consistency is too thick so that it can flow easily.
- Do not open the drawer when water is being supplied during the wash.
- Solvents (benzene, etc.) must never be used.

### Adding Water Softener

A water softener, such as anti-limescale can be used to cut down on the use of detergent in areas with high water hardness level.

- First add detergent, and then the water softener. Dispense according to the amount specified on the packaging.

# Programme Table

## Washing Programme

ENGLISH

Cotton		60 °C (60 °C to 90 °C)	Max. Load: 8 kg
Description	Very dirty, cotton and flax textiles. (Underwear, linen, tablecloth, towel (max. 4.0 kg), bedclothes, etc.)		

Eco 40-60		40 °C (40 °C to 60 °C)	Max. Load: 8 kg
Description	Dirty cotton and flax textiles. (Underwear, linen, tablecloth, towel (max. 4.0 kg), bedclothes, etc.)		

Pre-Wash + Cotton		60 °C (Cold, 30 °C to 60 °C)	Max. Load: 8 kg
Description	Dirty cotton and flax textiles. (Underwear, linen, tablecloth, towel (max. 4.0 kg), bedclothes, etc.)		

Cotton 20 °C		20 °C (Cold to 20 °C)	Max. Load: 4 kg
Description	Less dirty, cotton and linen textiles. (Underwear, bedsheet, tablecloth, towel (max. 2.0 kg) bedcloth, etc.)		

Color Care		40 °C (Cold, 30 °C to 40 °C)	Max. Load: 8 kg
Description	Less dirty, cotton and linen textiles. (Underwear, bedsheet, tablecloth, towel (max. 4.0 kg) bedcloth, etc.)		

Wool		30 °C (Cold, 30 °C)	Max. Load: 2.5 kg
Description	Woollen laundries with machine wash labels.		

Rinse		Cold	Max. Load: 8 kg
Description	Provides an additional rinse to any type of laundry after the washing cycle.		

Allergy Care		60 °C (Cold, 30 °C to 60 °C)	Max. Load: 4 kg
Description	Baby laundry		

## 24 OPERATION

Spin + Drain		Cold	Max. Load: 8 kg
Description	You can use this program for any type of laundry if you want an additional spin step after the washing cycle. You can use the drain program to drain the water accumulated inside the machine (adding or removing laundry). To enable the drain program, turn the program knob to the spin/drain program. After you select "spin cancelled" using the auxiliary function, the program will start to run.		

Hand Wash		30 °C (Cold, 30 °C)	Max. Load: 2.5 kg
Description	Laundry recommended for hand wash or sensitive laundry.		

Outdoor		40 °C (Cold, 30 °C to 40 °C)	Max. Load: 3.5 kg
Description	Very dirty or synthetic-mixed textiles. (Nylon socks, shirts, blouses, synthetic-including trousers etc. )		

Duvet		40 °C (Cold, 30 °C to 40 °C)	-
Description	For washing a fibre duvet with a machine washable label. (max. 2.5 kg)		

Jean / Dark Wash		30 °C (Cold, 30 °C)	Max. Load: 3.5 kg
Description	Black and dark items made of cotton, mixed fibre or jeans. Wash inside out. Jeans often contains excess dye and may run during the first few washes. Wash light and dark coloured items separately.		

Quick 60		60 °C (Cold, 30 °C to 60 °C)	Max. Load: 4 kg
Description	Dirty, cotton, coloured and linen textiles washed at 60°C in 60 minutes.		

Speed 12		30 °C (Cold, 30 °C)	Max. Load: 2 kg
Description	In a short time of 12 minutes, Lightly soiled, cotton, colored and linen textiles your can wash.		

### NOTE

- Select the appropriate water temperature for chosen wash programme. Always follow garment manufacturer's care label or instructions when washing to avoid damage to clothes.
- Select the proper wash temperature and spin speed for the desired programmes.
- Actual water temperature may differ from the declared cycle temperature.
- Neutral detergent is recommended.



## Extra Options

\*1 This option is automatically inserted in the programme and can not be deselected.

### NOTE

- The LED lights up when the option are selected.
- The LED blinks when the option will not be enable.

ENGLISH

Programme	Soil Level	Soil Type	Save+ mode	Speed mode
Cotton	●	●	●	●
Eco 40-60	●		●*1	
Pre-Wash + Cotton	●	●		
Cotton 20 °C			●*1	
Color Care	●	●	●	●
Wool	●			
Rinse				
Allergy Care		●		
Spin + Drain				
Hand Wash	●		●	●
Outdoor	●	●	●	●
Duvet	●	●	●	●
Jean / Dark Wash	●	●	●	●
Quick 60		●		●
Speed 12				●*1

Programme	Pre Wash	Extra Rinse	Easy Ironing	Anti-Allergy
Cotton	●	●	●	●
Eco 40-60	●	●	●	

## 26 OPERATION

Programme	Pre Wash	Extra Rinse	Easy Ironing	Anti-Allergy
<b>Pre-Wash + Cotton</b>	●*1			
<b>Cotton 20 °C</b>		●	●	
<b>Color Care</b>	●	●	●	
<b>Wool</b>		●		
<b>Rinse</b>		●	●	●
<b>Allergy Care</b>	●		●	●*1
<b>Spin + Drain</b>			●	
<b>Hand Wash</b>		●		
<b>Outdoor</b>	●	●	●	●
<b>Duvet</b>	●	●	●	●
<b>Jean / Dark Wash</b>	●	●	●	●
<b>Quick 60</b>			●	
<b>Speed 12</b>			●	

### Selectable Maximum Spin Speed

Programme	Spin Speed	
	Default	Available
<b>Cotton</b>	1200 rpm	All
<b>Eco 40-60</b>	1200 rpm	All
<b>Pre-Wash + Cotton</b>	1200 rpm	All
<b>Cotton 20 °C</b>	1200 rpm	All
<b>Color Care</b>	1200 rpm	All
<b>Wool</b>	800 rpm	Up to 800 rpm
<b>Rinse</b>	1200 rpm	-
<b>Allergy Care</b>	800 rpm	Up to 800 rpm

Programme	Spin Speed	
	Default	Available
Spin + Drain	1200 rpm	All
Hand Wash	800 rpm	Up to 800 rpm
Outdoor	1000 rpm	Up to 1000 rpm
Duvet	800 rpm	Up to 800 rpm
Jean / Dark Wash	800 rpm	Up to 800 rpm
Quick 60	1200 rpm	All
Speed 12	600 rpm	Up to 600 rpm

**NOTE**

- Actual maximum spin speed may vary depending on the load conditions. The values above are rounded to the nearest hundred.











## 28 OPERATION

### Extra Options and Functions

You can use the extra options and functions to customize the programmes.

### Customizing a Washing Programme

Each programme has default settings that are selected automatically. After selecting a washing programme, you may also customize the settings as your own.

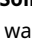
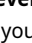
		90°C	1200
		60°C	1000
		40°C	800
		30°C	600
		20°C	400
		No	No
<b>1</b>	<b>2</b>	<b>3</b>	<b>4</b>

#### 1 Select the **Soil Level** by pressing button **1**.

- You can wash your laundries in shorter or longer durations, at lower or higher temperatures by selecting a soiling level depending on the soiling level on your laundries.





#### NOTE

- Soiling levels are automatically set in some programs. You can make changes at your discretion.
- If there are no changes in the level when you touch the button, it means there is no soiling level selection in the program you have selected.

#### 2 Select the **Soil Type** by pressing button **2**.

#### **⚠ WARNING**

- Do not let the stains on your laundries to get dry and stuck in order for the auxiliary function dedicated for soiling level selection to fully perform its functions.
- Clean the solids beforehand. Press on the newly formed stains on your laundries with a piece of cloth before starting to wash them in your product. Do not scrub!

Soil Type	Description
 Sweat stain	This additional function will add a cold rinse before the selected programme. This will soak the laundry with cold water to clean the sweat stains before the selected washing programme starts.
 Coffee stain	This additional function will add new washing steps for selected program. This will prolong the washing duration and apply a washing algorithm to remove the stain.
 Oil stain	This additional function will add a cold rinse before the selected programme and will add new washing steps for selected program. This will soak the laundry with the cold water before the selected washing program and apply a washing algorithm to clean the oil stain.
 Mix	This additional function will add a warm rinse before the selected programme and will add new washing steps for selected washing program. This will soak the laundry with warm water to soften the mix stains before the selected washing programme starts.

#### NOTE

- Before starting your machine, you can switch between stain types. Once you have started the machine, you cannot cancel or change the selected stain type.
- You can cancel the washing program of your machine, and select the correct stain type and restart the program.
- If the desired results could not be achieved with the set stain selection at the end of washing, you may have selected the wrong type; restart the

washing cycle with the correct stain selection to remove the stain.

- 3 Select the water temperature by pressing button ③.
  - You can press the washing water temperature setting button to decrease the washing water temperature gradually between the maximum water temperature of the selected program and cold water wash.
- 4 Select the spin speed by pressing button ④.
  - You can use the speed setting button to set the spin speed for your laundry. When you select a new program, the selected program's maximum spin speed will be displayed on the spin speed display.
  - You can press the spin speed setting button to decrease the spin speed gradually between the selected program's maximum spin speed and the spin cancelled option.
- 5 Run the customized programme by pressing on the **Start/Pause** button.
  - If you switch your machine to the standby mode, the **Start/Pause** led on the electronic display will blink.

## Delay

You can set this function so that the appliance starts automatically and finishes after a specified time interval.

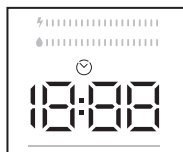

- 1 Select a washing programme.
- 2 Press the **Delay** button as necessary.
- 3 Press the **Start/Pause** button.

## NOTE

- After selecting the delay function, you can select other functions without touching the **Start/Pause** button, and then you can touch the **Start/Pause** button to enable time delay.
- To cancel the delay function:
  - If you did not press the **Start/Pause** button, keep touching the **Delay** button until the electronic display shows the duration of the program you have selected. Once you see the program time on the electronic display, this means that the delay has been cancelled.
  - If you have pressed the **Start/Pause** button to start the machine, you just need to touch the **delay** button once, will go off on the electronic display, press **Start/Pause** button to start the washing cycle.

## Energy/Water Efficiency Bar

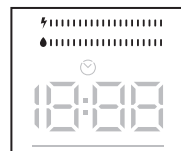

Energy/Water Efficiency Bar is an efficiency indicator comprising 2 bars. The energy/water efficiency bar shows the amount of energy and water consumption. The bigger the bar is, the more energy or water consumption you will have. The energy/water efficiency bar might extend or shorten depending on the selected program's duration, temperature setting, spin speed and other auxiliary functions.

## Child Lock

The Child Lock function allows you to lock the buttons so that the wash cycle you have chosen cannot be changed unintentionally.

### To activate child lock

Press and hold the **Options** and **Save+ / Speed** button simultaneously for at least 3 seconds. [L

## 30 OPERATION

will flash on the electronic display for 2 seconds when the child lock is activated.

### NOTE

- If the child lock function is active and a programme is running, when the programme dial is turned to the "Off" position and another programme is selected the previously selected programme continues from where it was left.

### To deactivate the child lock

Press and hold the **Options** and **Save+ / Speed** button simultaneously for at least 3 seconds until the **CL** symbol on the electronic display disappears.

### NOTE

- Door remains unlocked in case when child lock is active and electricity is cut off.

on the display, this means that this feature is not available in the selected washing program.

## Extra Rinse

You can use this auxiliary function for extra rinsing on your laundry. To enable the extra rinse function, keep pressing the **Options** button until the extra rinse symbol(②) turns on. If the extra rinse symbol(②) is constantly on in the electronic display, it means that the auxiliary function is selected.

### NOTE

- When you want to select the extra rinse auxiliary function, if extra rinse symbol(②) does not appear on the display, this means that this feature is not available in the selected washing program.

## Auxiliary Functions

- Position of the Symbol

①	90°C 1200			
②	60°C 1000			
③	40°C 800			
④	30°C 600			
	20°C 400			
	No			

### Pre Wash

You can use this auxiliary function to perform pre-wash before the main wash cycle for your highly soiled laundry. When you use this function, you need to add detergent into the prewash dispenser of the detergent drawer. To enable the prewash auxiliary function, press the **Options** button until the prewash symbol(①) turns on. If the prewash symbol(①) is constantly on in the electronic display, it means that the auxiliary function is selected.

### NOTE

- When you want to select the prewash auxiliary function, if prewash symbol(①) does not appear

## Easy Ironing

This function allows you to have less creased clothes after washing. To enable the easy ironing auxiliary function, press the **Options** button until the easy ironing symbol(③) turns on. If the easy ironing symbol(③) is constantly on in the electronic display, it means that the auxiliary function is selected.

### NOTE

- When you want to select the easy ironing auxiliary function, if easy iron symbol(③) does not appear on the display, this means that this feature is not available in the selected washing program.

## Anti-Allergy

You can use this auxiliary function to add another rinse cycle for your laundry. Your machine will use hot water in all rinsing steps. (It is recommended for sensitive skin clothing, baby clothes and underclothes). To enable the anti-allergy auxiliary

function, keep pressing the **Options** until the anti-allergy function symbol(4) turns on. If the anti-allergy symbol(4) is constantly on in the electronic display, it means that the auxiliary function is selected.

## NOTE

- When you want to select the anti-allergy auxiliary function, if anti-allergy symbol(4) does not appear on the display, this means that this feature is not available in the selected washing program.

## Save+ mode

If you select this auxiliary function, your machine will slightly extend the duration of the washing program. However, it will use less energy and water for the washing cycle. To enable this function, you can touch the **Save+ / Speed** button on the display panel to turn on the eco washing symbol(5).

## Speed mode

If you select this auxiliary function, your machine will shorten the duration of the washing program. (It is recommended to load the machine with half or less than half of the capacity of the selected washing program.) To enable this function, you can touch the **Save+ / Speed** button on the display panel to turn on the quick wash symbol(6).

## NOTE

- If you load the machine with half or less than half of the laundry capacity of the selected washing program, the machine will detect it thanks to the half load detection system, and this way, it will wash your laundry with less energy and less water in a shorter time. When your machine detects half load, quick wash symbol(6) will automatically turn on in the display panel.

## 32 MAINTENANCE

# MAINTENANCE

### **⚠ WARNING**

- Unplug the appliance before cleaning to avoid the risk of electric shock. Failure to follow this warning may result in serious injury, fire, electric shock, or death.
- Never use harsh chemicals, abrasive cleaners, or solvents to clean the appliance. They may damage the finish.

## Cleaning After Every Wash

### What to Clean

Always remove items from the washing machine as soon as the cycle is complete. Leaving damp items in the washing machine can cause wrinkling, colour transfer, and odour.

- After the wash cycle is finished, wipe the door and door seal to remove any moisture.
- Leave the door slightly open to dry the drum.
- Wipe the appliance with a dry cloth to remove any moisture.

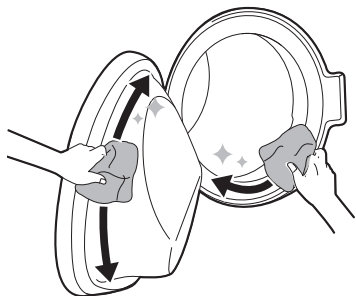

### **⚠ WARNING**

- Leave the door open to dry inside of the appliance only if the children are supervised at home.

## Cleaning the Exterior and Drum

Proper care of your appliance can extend the service life.

### Exterior

- Immediately wipe off any spills.
- Wipe with a damp cloth and then again with a dry cloth ensuring there is no moisture in cabinet joints or crevices.
- Do not press on the surface or the display with sharp objects.

### Door

- Wash with a damp cloth on the outside and inside and then dry with a soft cloth.

### Drum

- Do not leave metallic objects such as needles, paper clips, coins etc. in your machine. These objects lead to the formation of rust stains in the drum.
- To clean such rust stains, use a non-chlorine cleaning agent and follow the instructions of manufacturer of the cleaning agent. Never use wire wool or similar hard objects for cleaning rust stains.

### **⚠ WARNING**

- Do not attempt to separate any panels or disassemble the appliance. Do not apply any sharp objects to the control panel in order to operate the appliance.



## Cleaning the Appliance Periodically

### Cleaning the Water Inlet Filter

#### ⚠ WARNING

- The filters at the water inlet valve may become clogged due to water quality or lack of required maintenance and may break down. This may cause a water leak. Any such breakdowns are out of the scope of the warranty.

The water inlet filter collects lime or any sediment that may be in water that is supplied to the appliance. Clean the inlet filter **every 2 months** or so, or more often if the water is very hard or contains traces of limescale.

- Turn off the water supply taps to the appliance if the appliance is to be left for a certain period of time (e.g. holiday), especially if there is no floor drain (gully) in the immediate vicinity.

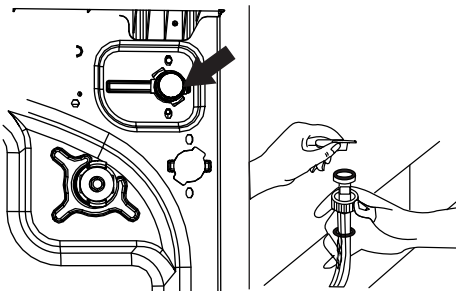

- Turn off the power and the water tap and then unscrew the water inlet hose.
  - To remove the water inlet filter from the water inlet valve, use a pair of long-nosed pliers to gently pull on the plastic bar in the filter.
  - A second water inlet filter is located in the tap end of the water inlet hose. To remove the second water inlet filter, use a pair of long-nosed pliers to gently pull on the plastic bar in the filter.
- Clean the filter thoroughly with a soft brush and wash with soapy water and rinse thoroughly.

- Re-insert the filter by gently pushing it back into place.

### Cleaning the Drain Pump Filter

The drain filter collects threads and small objects that may have been accidentally left in the clothes. Make sure that the filter is clean **every 2 months** to ensure smooth running of your appliance.

Allow the water to cool before cleaning the drain pump filter.

To clean the pump filter

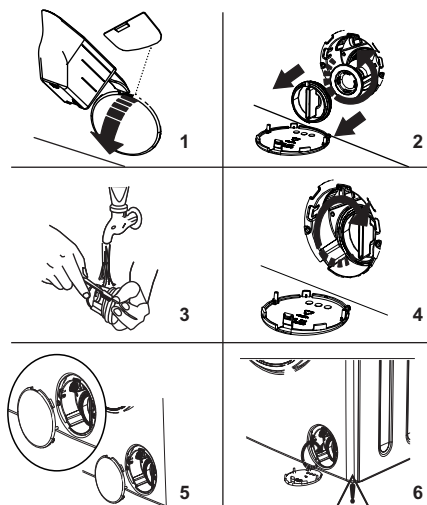

- You may use the washing powder spade (\*) supplied with your machine or liquid detergent level plate to open the pump cover.
- Lodge the end of the powder spade or liquid detergent level plate in the opening of the cover and gently press backwards. The cover will open.
  - Before opening the filter cover, place a container under the filter cover to collect any water left in the machine.
  - Loosen the filter by turning anticlockwise and remove by pulling. Wait for the water to drain.

## 34 MAINTENANCE

### NOTE

- Depending on the amount of water inside the machine, you may have to empty the water collection container a few times

- Remove any foreign materials from the filter with a soft brush.
- After cleaning, re-fit the filter by inserting it and turning clockwise.
- When closing the pump cover, ensure that the mountings inside the cover meet the holes on the front panel side.
- Close the filter cover.

### ⚠ CAUTION

- Be careful when draining, as the water may be hot.

## Cleaning the Dispenser Drawer

Detergent and fabric softener can build up in the dispenser drawer. Liquid detergents can remain under the dispenser drawer and not dispense completely. Remove the drawer and inserts and check for build-up of cleaning products **every 2 months**.

- Pull the drawer forwards until it is fully extended.

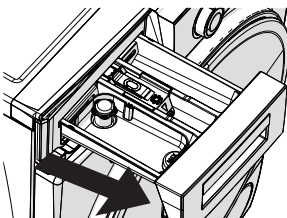

- Press the region shown below inside the detergent drawer you have pulled all the way

back, and continue pulling and remove the detergent drawer from its place

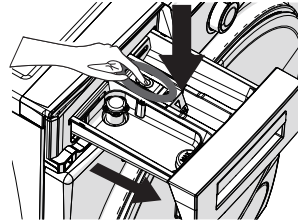

- Remove the detergent drawer and disassemble the flush stopper. Clean thoroughly to completely remove any softener residue. Refit the flush stopper after cleaning and check that it is seated properly.

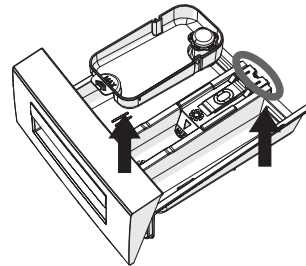

- Rinse with a brush and lots of water. Collect the residues inside the detergent drawer slot so that they don't fall inside your machine.
- Wipe any moisture with a dry towel or cloth after cleaning.
- Reassemble the components of the drawer to the proper compartments and insert the detergent dispenser drawer.



# TROUBLESHOOTING

Operation of your appliance can lead to errors and malfunctions. The following tables contain possible causes and notes for resolving an error message or malfunction. It is recommended to read the tables carefully below in order to save your time and money that may cost for calling to LG Electronics service centre.

## Before Calling for Service

Your appliance is equipped with an automatic error-monitoring system to detect and diagnose problems at an early stage. If the appliance does not function properly or does not function at all, check the following tables before calling to LG Electronics service centre.

### Error Messages

Symptoms	Possible Cause & Solution
 E01	<b>The door of the appliance is not shut properly.</b> <ul style="list-style-type: none"> <li>Shut the door properly until you hear a click. If the appliance persists to indicate fault, turn off your machine, unplug it and contact the nearest authorised service agent immediately.</li> </ul>
 E02	<b>The water pressure or the water level inside the appliance may be low.</b> <ul style="list-style-type: none"> <li>Check the tap is fully turned on. Mains water may be cut-off. If the problem still continues, your machine will stop after a while automatically. Unplug the machine, turn off your tap and contact the nearest authorised service agent.</li> </ul>
 E03	<b>The pump is faulty or pump filter is clogged or electrical connection of the pump is faulty.</b> <ul style="list-style-type: none"> <li>Clean the pump filter. If the problem persists, contact the nearest authorised service agent.</li> </ul>
E04	<b>The appliance has excessive amount of water.</b> <ul style="list-style-type: none"> <li>The appliance will discharge water by itself. Once the water has drained, turn off the appliance and unplug it. Turn off the tap and contact the nearest authorised service agent.</li> </ul>

### Noises You Might Hear

Symptoms	Possible Cause & Solution
<b>Rattling and clanking noise</b>	<b>Foreign objects, such as keys, coins, or safety pins may be in the drum.</b> <ul style="list-style-type: none"> <li>Stop the appliance, check the drum for foreign objects. If the noise continues after the appliance is restarted, call for service.</li> </ul>

## 36 TROUBLESHOOTING

Symptoms	Possible Cause & Solution
<b>Thumping sound</b>	<b>Heavy clothes may produce a thumping sound. This is usually normal.</b> <ul style="list-style-type: none"> <li>If the sound continues, the appliance is probably out of balance. Stop and redistribute the clothes.</li> </ul>
	<b>The clothes may be out of balance.</b> <ul style="list-style-type: none"> <li>Pause the programme and redistribute the clothes after the door unlocks.</li> </ul>
<b>Vibrating noise</b>	<b>Package materials are not removed.</b> <ul style="list-style-type: none"> <li>Remove package materials.</li> </ul>
	<b>The clothes may be unevenly distributed in the drum.</b> <ul style="list-style-type: none"> <li>Pause the programme and redistribute the clothes after the door unlocks.</li> </ul>
	<b>Not all levelling feet are resting firmly and evenly on the floor.</b> <ul style="list-style-type: none"> <li>See the <b>Levelling the Appliance</b> instruction to adjust the levelling of the appliance.</li> </ul>
	<b>Floor not rigid enough.</b> <ul style="list-style-type: none"> <li>Check if the floor is solid and does not flex. See the <b>Installation Place Requirements</b> to select the proper location.</li> </ul>

## Operation

Symptoms	Possible Cause & Solution
<b>Water is leaking.</b>	<b>House drain pipes are clogged.</b> <ul style="list-style-type: none"> <li>Unclog waste pipes. Contact plumber if necessary.</li> </ul>
	<b>Leakage is caused by improper installation of drain hose or clogged drain hose.</b> <ul style="list-style-type: none"> <li>Clean and straighten the drain hose. Check and clean the drain filter regularly.</li> </ul>
	<b>Drain pump filter cap is not fitted correctly.</b> <ul style="list-style-type: none"> <li>Refit the drain pump filter.</li> </ul>
<b>Appliance does not operate.</b>	<b>Appliance is unplugged.</b> <ul style="list-style-type: none"> <li>Make sure that the cord is plugged securely into a working outlet.</li> </ul>
	<b>Water supply is turned off.</b> <ul style="list-style-type: none"> <li>Turn the water supply tap completely.</li> </ul>
	<b>Controls are not set properly.</b> <ul style="list-style-type: none"> <li>Make sure that the programme is correctly set. Close the door and press the <b>Start/Pause</b> button.</li> </ul>

Symptoms	Possible Cause & Solution
<b>Appliance does not operate.</b>	<b>Door is open.</b> <ul style="list-style-type: none"> <li>Close the door and make sure that nothing is caught under the door preventing it from closing completely.</li> </ul>
	<b>Circuit breaker/fuse is tripped/blown.</b> <ul style="list-style-type: none"> <li>Check house circuit breakers/fuses. Replace fuses or reset breaker. The appliance should be on a dedicated branch circuit. The appliance will resume the programme where it stopped once power is restored.</li> </ul>
<b>Appliance does not operate.</b>	<b>Start/Pause was not pressed after a programme was set.</b> <ul style="list-style-type: none"> <li>Press the <b>Start/Pause</b> button.</li> </ul>
	<b>Extremely low water pressure.</b> <ul style="list-style-type: none"> <li>Check another tap in the house to make sure that household water pressure is adequate.</li> </ul>
	<b>Appliance is heating the water or making steam.</b> <ul style="list-style-type: none"> <li>The drum may stop operating temporarily during certain cycles, while water is safely heated to a set temperature.</li> </ul>
<b>Appliance stops for a few minutes and then restarts.</b>	<b>A motor protection device has been activated to prevent overheating of the motor.</b> <ul style="list-style-type: none"> <li>This is normal. If the motor protection device is activated, the appliance will stop for a few minutes and then start again.</li> </ul>
<b>Buttons may not function properly.</b>	<b>The Child Lock option is activated.</b> <ul style="list-style-type: none"> <li>Deactivate the <b>Child Lock</b> option if necessary.</li> </ul>
<b>Door does not open.</b>	<b>The door cannot be opened for safety reasons once the appliance starts.</b> <ul style="list-style-type: none"> <li>This is normal. You can safely open the door after  turns off.</li> </ul>
<b>Appliance is not filling properly.</b>	<b>Inlet filter clogged.</b> <ul style="list-style-type: none"> <li>Make sure the inlet filters on the fill valves are not clogged.</li> </ul>
	<b>Inlet hoses may be kinked.</b> <ul style="list-style-type: none"> <li>Check that inlet hoses are not kinked or clogged.</li> </ul>
	<b>Insufficient water supply.</b> <ul style="list-style-type: none"> <li>Make sure that both hot and cold water taps are turned on all the way.</li> </ul>
	<b>Hot and cold supply hoses are reversed.</b> <ul style="list-style-type: none"> <li>Check supply hose connections.</li> </ul>
<b>Appliance does not drain water.</b>	<b>Kinked drain hose.</b> <ul style="list-style-type: none"> <li>Ensure that the drain hose is not kinked.</li> </ul>
	<b>Drain located higher than 1 m above the floor.</b> <ul style="list-style-type: none"> <li>Make sure that the drain hose is no higher than 1 m above the bottom of the appliance.</li> </ul>

## 38 TROUBLESHOOTING

Symptoms	Possible Cause & Solution
<b>Detergent is not dispensed completely or not dispensed at all.</b>	<b>Too much detergent is used.</b> <ul style="list-style-type: none"> <li>Follow the guidelines provided by the detergent manufacturer.</li> </ul>
	<b>Drain Pump Filter may be blocked.</b> <ul style="list-style-type: none"> <li>Clean the Drain filter.</li> </ul>
<b>Cycle time is longer than usual.</b>	<b>The load is too small.</b> <ul style="list-style-type: none"> <li>Add more items to allow the appliance to balance the loads.</li> </ul>
	<b>Heavy articles are mixed with lighter items.</b> <ul style="list-style-type: none"> <li>Always try to wash articles with similar weight in order to allow the appliance to evenly distribute the weight of the load for spinning.</li> </ul>
	<b>The load is out of balance.</b> <ul style="list-style-type: none"> <li>Manually redistribute the load if articles have become tangled.</li> </ul>
<b>Cycle end is delayed</b>	<b>Unbalance is detected or suds removing programme is on.</b> <ul style="list-style-type: none"> <li>This is normal. The time remaining shown on the display is only an estimated duration. Actual time may vary.</li> </ul>

## Performance

Symptoms	Possible Cause & Solution
<b>Poor stain removal</b>	<b>Previously set stains.</b> <ul style="list-style-type: none"> <li>Articles that have been previously washed may have stains which have been set. These stains may be difficult to remove and may require hand washing or pre-treating to aid in stain removal.</li> </ul>
<b>Staining</b>	<b>Bleach or softener is dispensed too soon.</b> <ul style="list-style-type: none"> <li>Dispenser compartment is overfilled. It makes bleach or softer dispensed rapidly. Always measure bleach or softener to prevent overfilling.</li> <li>Close the detergent dispenser slowly.</li> </ul>
	<b>Bleach or softener was added directly to the clothes in the drum.</b> <ul style="list-style-type: none"> <li>Always use the detergent dispenser to ensure that bleach or softener is properly dispensed at the right time in the programme.</li> </ul>
	<b>Clothes were not properly sorted.</b> <ul style="list-style-type: none"> <li>Always wash dark colours separately from light colours and whites to prevent discoloration.</li> <li>Never wash heavily soiled items with lightly soiled items.</li> </ul>
<b>Wrinkling</b>	<b>Appliance is not unloaded promptly.</b> <ul style="list-style-type: none"> <li>Always remove items from the appliance as soon as the programme is complete.</li> </ul>

Symptoms	Possible Cause & Solution
<b>Wrinkling</b>	<b>Appliance is overloaded.</b> <ul style="list-style-type: none"> <li>The appliance can be fully loaded, but the drum should not be tightly packed with items. The door of the appliance should be closed easily.</li> </ul>
	<b>Hot and cold water supply hoses are reversed.</b> <ul style="list-style-type: none"> <li>Hot water rinse can set wrinkles in garments. Check the supply hose connections.</li> </ul>
	<b>Spin speed may be too high.</b> <ul style="list-style-type: none"> <li>Set the spin speed to suit the garment type.</li> </ul>

## Odour

Symptoms	Possible Cause & Solution
<b>Musty or mildewy odour in appliance</b>	<b>Odours can occur if the drain hose is not properly installed, causing siphoning (water flowing back inside of the appliance).</b> <ul style="list-style-type: none"> <li>When installing the drain hose, make sure that it does not get kinked or blocked.</li> </ul>
	<b>If the detergent dispenser is not cleaned regularly, odours can occur from mold or foreign substances.</b> <ul style="list-style-type: none"> <li>Remove and clean the detergent dispenser, especially the top and bottom of the dispenser's opening.</li> </ul>

## Performing an Emergency Water Evacuation and Opening the Locked Door

When the appliance is running, any power cut or when the programme is not yet complete, the door will remain locked.

- 1 Unplug the appliance.
- 2 Drain the water following the instructions given in the "Cleaning the Drain Pump Filter".

## 40 TROUBLESHOOTING

---

- 3** Pull down the emergency door opening mechanism with the help of a tool and open the door at the same time.



- 4** Move the emergency opening handle to the open position after being closed again, if the door remains locked.



# Memo

**Memo**

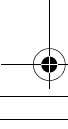
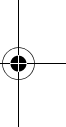
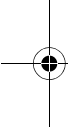

## Memo

