



Life's Good



## LG Pra.L Total Lift Up Care

Model name

BLJ1

BLJ2



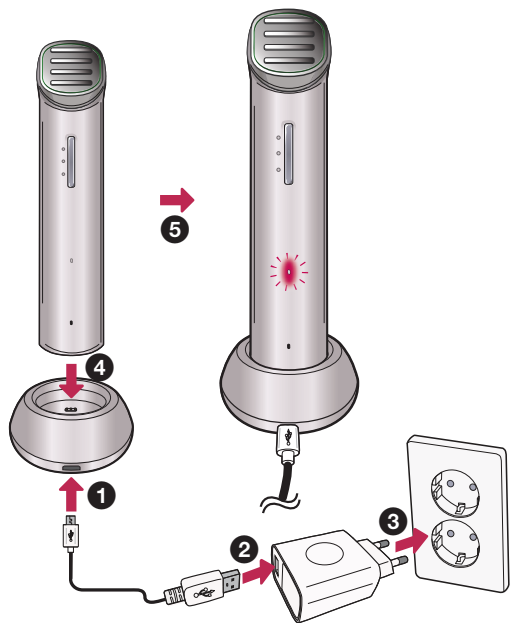

MBM66256534

### Charge

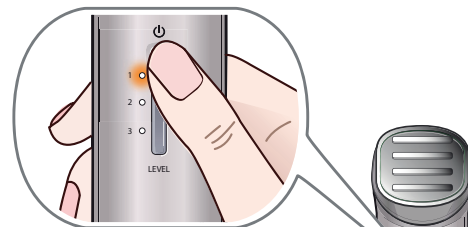

### Power on / off



Press the  (power) button for a short while.

### Strength Selection

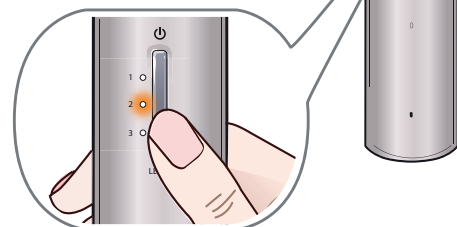

Press the LEVEL button for a short while.  
(1 → 2 → 3)

### Set voice guide function

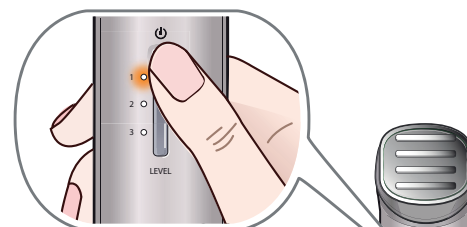

Press the  (power) button for a long while (until the guide).  
(Voice guide → Sound effect guide → Turn off guide (mute))

### Language Setting

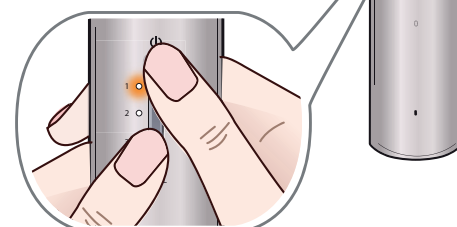

Press the  (power) button and the LEVEL button at the same time for a long while (until the guide).  
(Korean → English → Chinese)

### Mode Selection

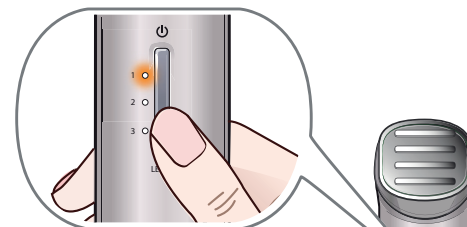

Press the LEVEL button for a long while (until the guide).  
(Total care mode → Tightening mode → Lifting mode)

- **Total care mode** : Tightening mode + Lifting mode
- **Tightening mode** : Helps to improve elasticity in skin dermis.
- **Lifting mode** : Stimulates skin tissue and muscles to help face lifting.

## Precautions for use

- When using this device, depending on individual skin condition, it may cause a variety of skin irritation. If such irritation persists, please reduce the number of use.
- In the following cases, it is recommended to use the device after consultation with a specialist.
  - Allergies skin, acne, dermatitis, skin treatment, cosmetic surgery or hair loss surgery
  - Wearing a cardiac pacemakers, device implantation or a metal prosthetic device
- As a facial treatments only, it is not recommended to use for a body.
- Do not make direct eye contact with LED light in operation. Excessive exposure to the light can cause eye damage.
- Do not expose the LED light of the UV head protection cap directly. Excessive exposure to the light can cause eye and skin damage.
- Recommend using the product twice a week. Using more than two times continuously on the same area of the face may cause burning sensation on skin.
- Before using the device, if you are currently undergoing dermatology related treatment or have skin problems, consult your dermatologist and then use it.
- Pregnancy, menstruation, lactating women are not recommended for use. (Unstable hormonal balance may cause temporary skin trouble.)
- When using the device on the neck, do not use on Adam's apple where the thyroid gland is located.
- Do not use the device for purposes other than those set out in this guideline.
- Due to the individual differences of skin types, if you may feel skin irritation such as stinging, please start using the unit from level 1.
- Please pay attention to using cosmetics that contain the following ingredients as it may reduce the effect. (For example: denatured alcohol, sunscreen, retinol, oil)

## Total Care Mode

※ The device provides elasticity improvement and a lifting effect through step-by-step care such as high frequency and micro currents.

※ Main functions: Tightening mode (RF (High frequency), RED LED)+ Lifting mode (Micro currents)



Remove makeup and wash the face



Apply a liberal amount of moisture gel. (on your desired area or the head of the device)

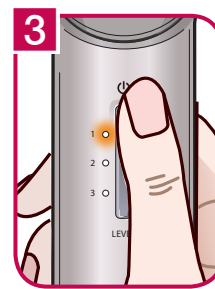

When turning on the device, the total mode begins with Step 1.

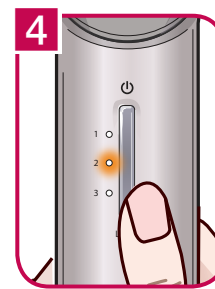

Press the LEVEL button for a short time and select the strength.

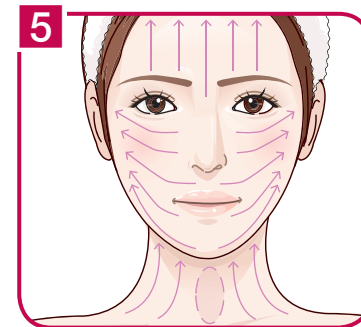

After checking care method and order, massage your desired area.

※ Care Areas :

**Forehead / Cheeks / Chin / Neck**

⚠ When using the device on the neck, do not use on Adam's apple where the thyroid gland is located. Thyroid patients must consult with your doctor before use.

※ Care Method

Place the device on your desired area. (Forehead or cheeks) In the direction of the arrow, massage your desired area as pulling upward slowly.

- The device produces a sound effect every 5 seconds.

※ Order of Care (6 minutes per session, Operate a total of 18 minutes for 3 sessions.)

- ① The first area (6 minutes) : Massage Tightening Mode for 3 minutes, Lifting Mode for 3 minute
- ② The second area (6 minutes) : Massage Tightening Mode for 3 minutes, Lifting Mode for 3 minutes
- ③ The third area (6 minutes) : Massage Tightening Mode for 3 minutes, Lifting Mode for 3 minutes



Rinse your face sufficiently with tepid water after cleansing