

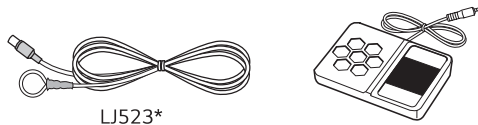

LED TV
LJ52**

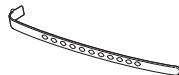
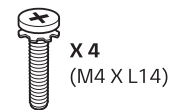
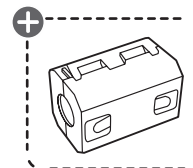
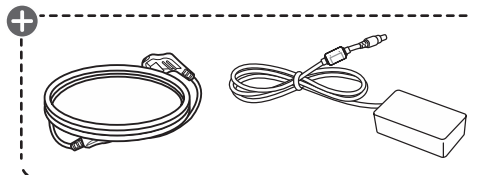
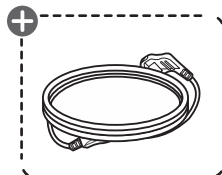
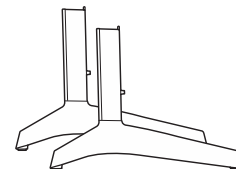
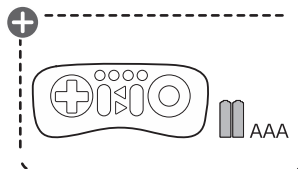
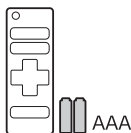
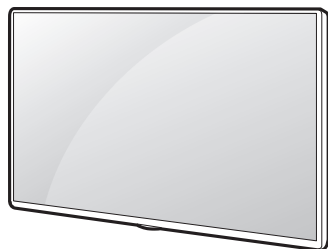

⊕ : Depending on model

*Image may vary depending on models



www.lg.com

P/No: MFL69446167 (1702-REV00)



English

- Read **Safety and Reference.**
- For the power supply and power consumption, refer to the label attached to the product.

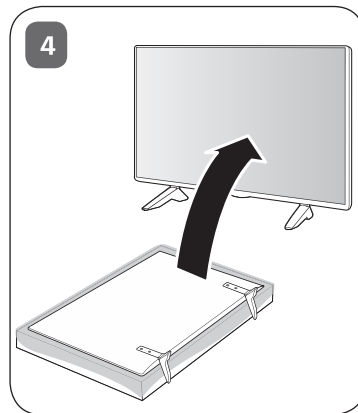
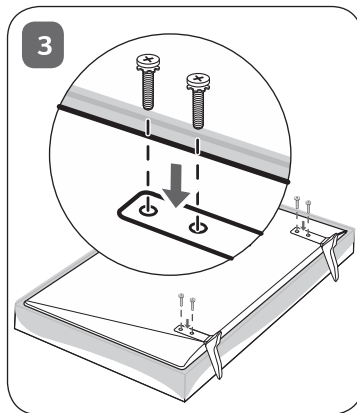
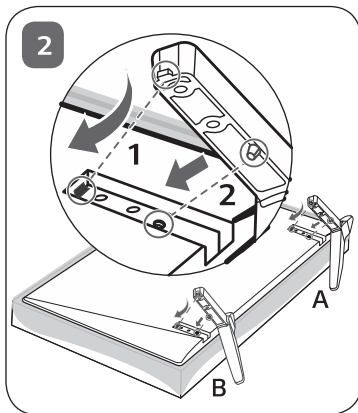
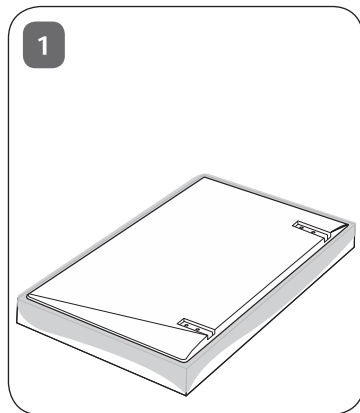

CAUTION

Image shown may differ from your TV.

When attaching the stand to the TV set, place the screen facing down on a cushioned table or flat surface to protect the screen from scratches.

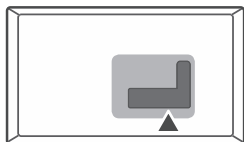

ANTENNA/
CABLE IN

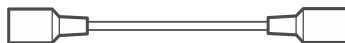

HDMI IN

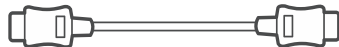

H/P OUT



USB IN



NOTE

Image shown may vary depending on model.
All connection cables & devices shown in the picture are not included along with the TV set.

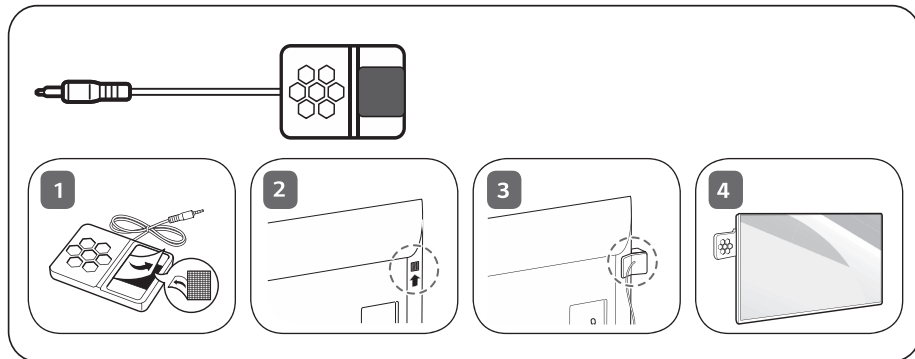
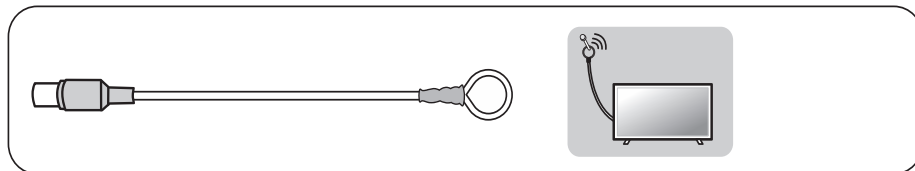
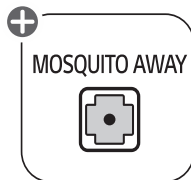
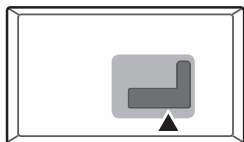

! NOTE
Image shown may vary depending on model.
All connection cables & devices shown in the picture are not
included along with the TV set.

+ : Depending on model

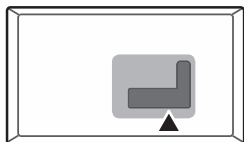

! NOTE

Image shown may vary depending on model.
All connection cables & devices shown in the
picture are not included along with the TV set.

COMPONENT IN

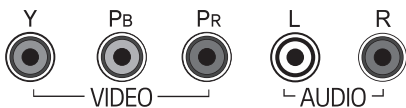
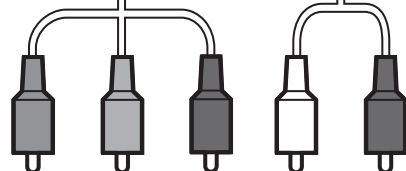
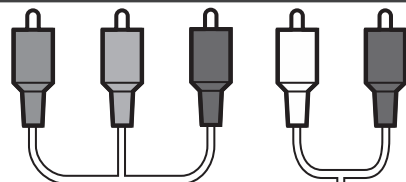
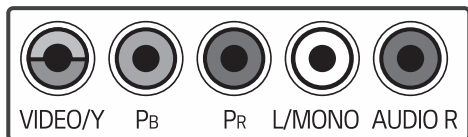

AV IN

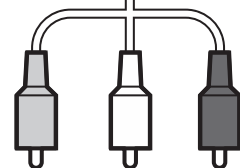
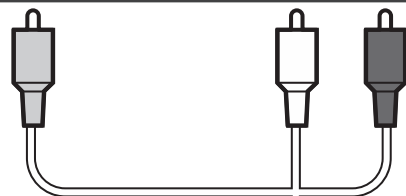
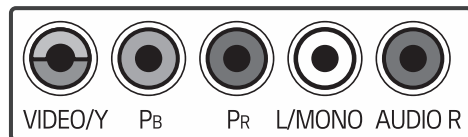

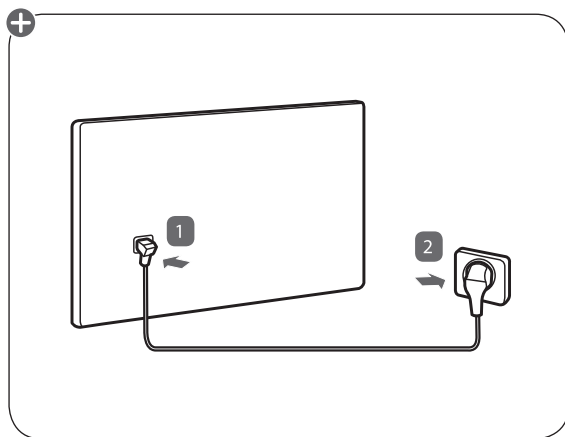
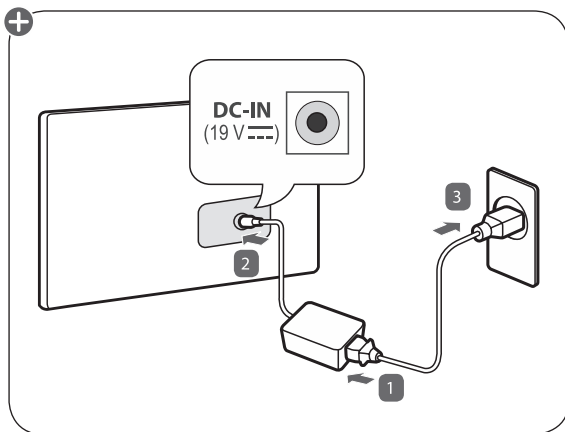

NOTE
Image shown may vary depending on model.

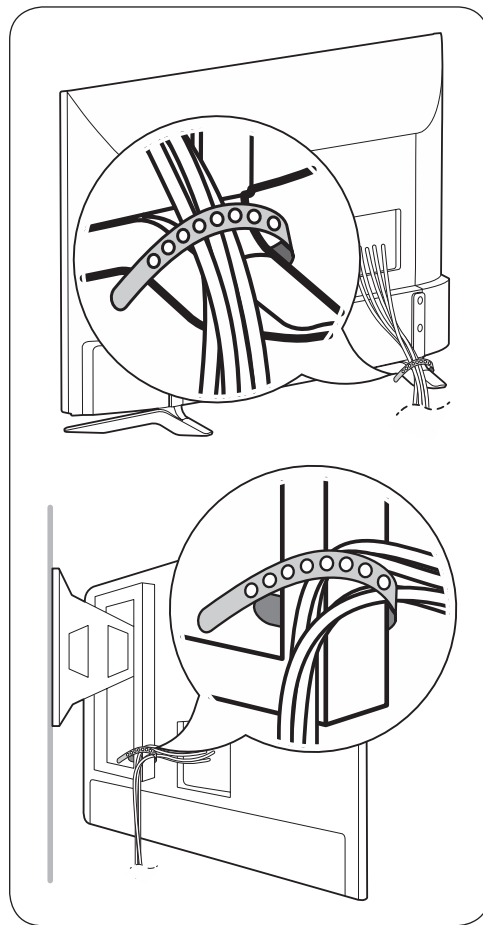

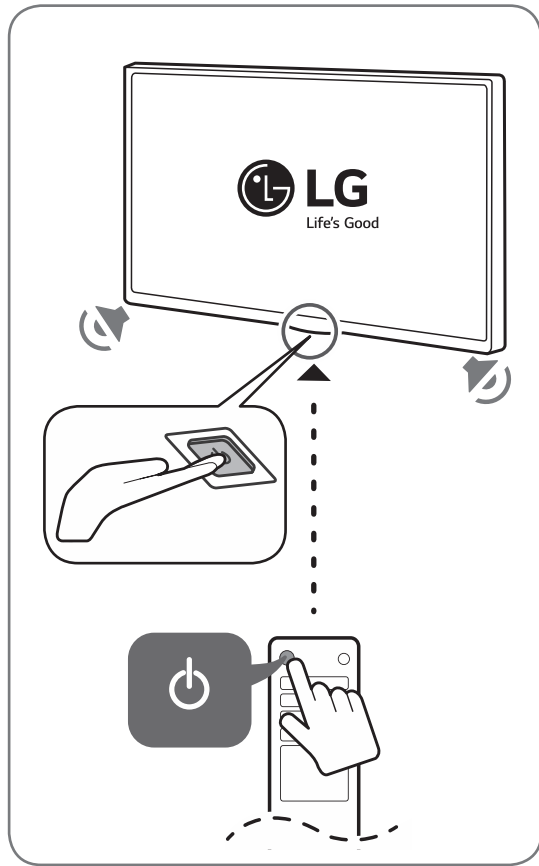
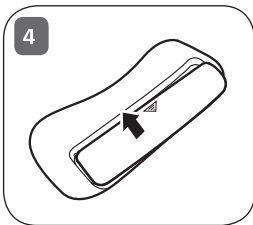
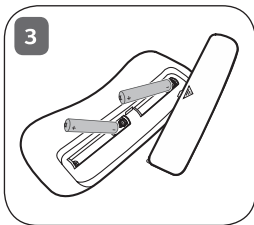
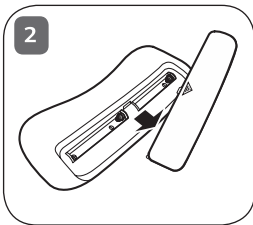
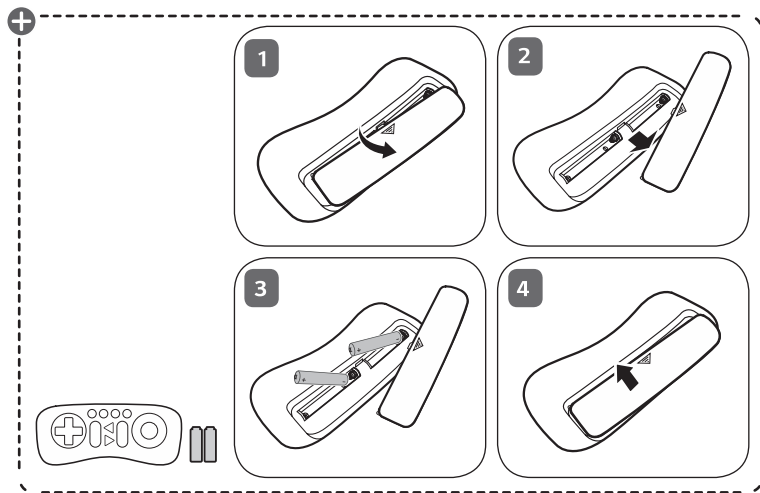
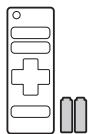
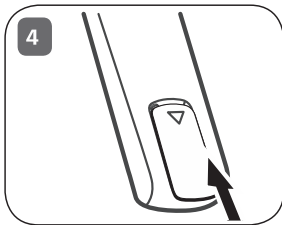
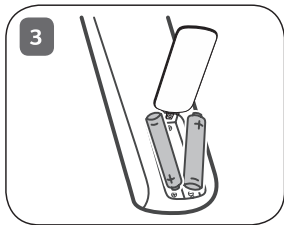
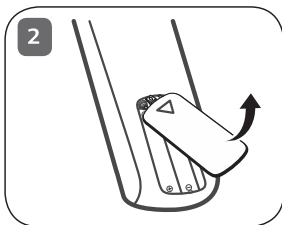
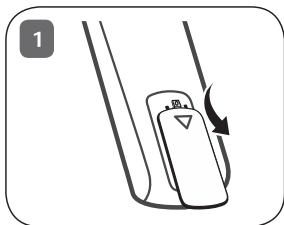

NOTE

Image shown may vary depending on model.

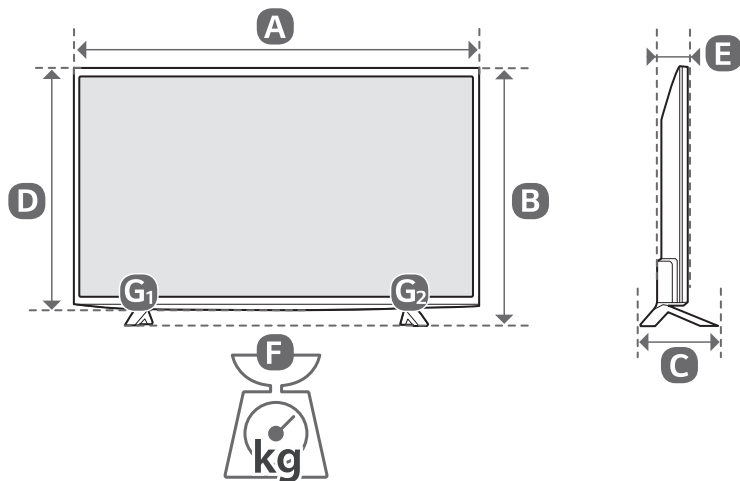

| | A (mm) | B (mm) | C (mm) | D (mm) | E (mm) | F (kg) | F - (G ₁ + G ₂) (kg) |
|---|---------------|---------------|---------------|---------------|--|---------------|---|
| 32LJ522D-TA 32LJ523D-TA 32LJ525D-TA | 734 | 474 | 172 | 438 | 71 | 5.0 | 4.8 |
| Power requirement | | | | | 19 V  2.5 A | | |

NOTE

Image shown may vary depending on model.



| | A (mm) | B (mm) | C (mm) | D (mm) | E (mm) | F (kg) | F - (G ₁ + G ₂) (kg) |
|---|---------------|---------------|---------------|---------------|---------------------------|---------------|---|
| 43LJ522T-TB 43LJ523T-TB 43LJ525T-TB | 976 | 621 | 208.7 | 583 | 81.5 | 8.4 | 8.1 |
| Power requirement | | | | | 19 V --- 2.7 A | | |
| 49LJ523T-TB | 1108 | 696 | 208.7 | 657 | 81.5 | 11.6 | 11.3 |
| Power requirement | | | | | AC 100-240 V ~ 50 / 60 Hz | | |
| 49LJ527T-TC | 1108 | 696 | 208.7 | 657 | 81.5 | 10.9 | 10.6 |
| Power requirement | | | | | 19 V --- 3.2 A | | |



MFL69446167