



SIMPLE MANUAL

Sound Bar

To view the instructions of advanced features,
visit <http://www.lg.com> and then download Owner's Manual.
Some of the content in this manual may differ from your unit.

MODEL
LAS160B



- ENGLISH
- DEUTSCH
- FRANÇAIS
- NEDERLANDS
- SLOVENŠČINA
- ITALIANO
- ESPAÑOL
- ЕМАНИКА
- PORTUGUÊS
- MAGYAR
- ČEŠTINA
- HRVATSKI
- SRPSKI
- SLOVENČINA
- БЛГТАРСКИ
- МАКЕДОНСКИ
- POLSKI
- ROMÂNĂ
- РУССКИЙ
- LATVIŠU
- LIEUVIŪ
- EESTI

www.lg.com



Front Panel

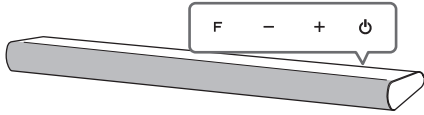

- F** Selects Function
- / +** Adjusts Volume
- ⏻** Power On /Off

Rear Panel

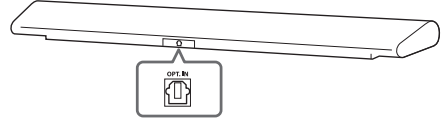

- OPT. IN** Connect to an Optical device

TV Connection

- 1 Connect the sound bar to the TV using Optical cable.
- 2 Set up [External Speaker (Optical)] on your TV setting menu.

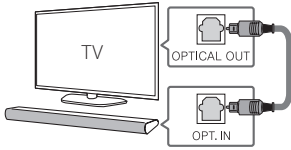

For more information, download the online owner's manual. <http://www.lg.com>

Additional Information

Specification

Power requirements	Refer to main label.
Power consumption	Refer to main label. Networked standby: 0.4 W (If all network ports are activated.)
Dimensions (W x H x D)	Approx. 880 mm x 62 mm x 90 mm
Net Weight	Approx. 1.8 kg
Amplifier (Total RMS Output power)	50 W

Design and specifications are subject to change without notice.

Remote control



STANDARD **VOICE** **CINEMA** : Selects sound effect.

DRC ON **DRC OFF** : Makes comfortable sound at Dolby Digital.

AUTO POWER ON **AUTO POWER OFF** : Automatically turns on by an input source:
Optical or **Bluetooth**

How to disconnect the wireless network connection or the wireless device

Set up the AUTO POWER ON/OFF function to off and turn off the unit.

Replacement of battery

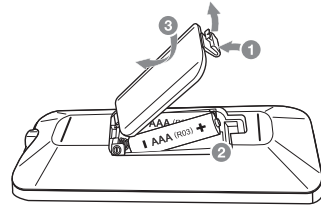

Declaration of Conformity

CE 1588

Hereby, LG Electronics European Shared Service Center BV, declares that this Sound Bar is compliant with the essential requirements and other relevant provisions of Directive 1999/5/EC. The complete Declaration of Conformity may be requested through the following postal address:

LG Electronics European Shared Service Center BV.
European Standard Team
Krijgsman 1
1186 DM Amstelveen
The Netherlands

or can be requested at our dedicated DoC website:

<http://www.lg.com/global/support/cedoc/cedoc+>

This device is a 2.4 GHz wideband transmission system, intended for use in all EU member states and EFTA

